

F.A.I. RTE.	SECTION	COUNTY	TOTAL SHEETS	SHEET NO.
270	60-(1,2,3,4,5)I	MADISON	46	40
STA. 670+00		TO STA. 700+00		
FED. ROAD DIST. NO. ILLINOIS		FED. AID PROJECT		

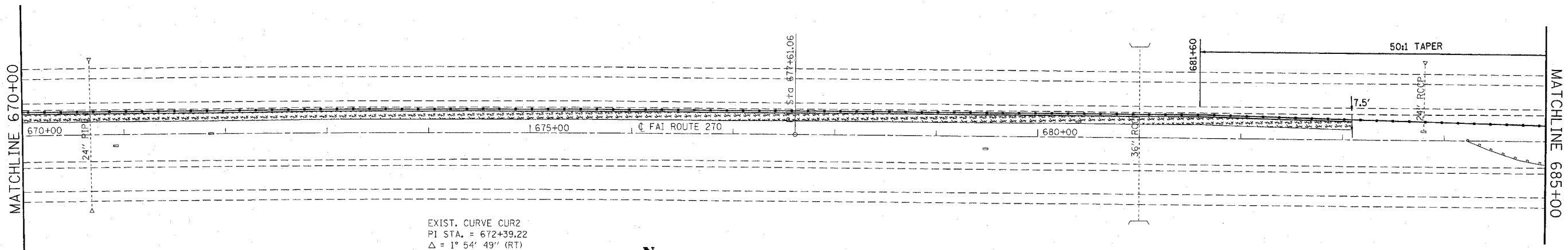

EXIST. CURVE CUR2
 PI STA. = 672+39.22
 $\Delta = 1^\circ 54' 49''$ (RT)
 $D = 0^\circ 11' 00''$
 $R = 31,252.24'$
 $T = 521.94'$
 $L = 1,043.79'$
 $E = 4.36'$
 $e = \text{-----}$
 $T.R. = \text{-----}$
 $S.E. RUN = \text{-----}$
 $P.C. STA. = 667+17.28$
 $P.T. STA. = 677+61.06$

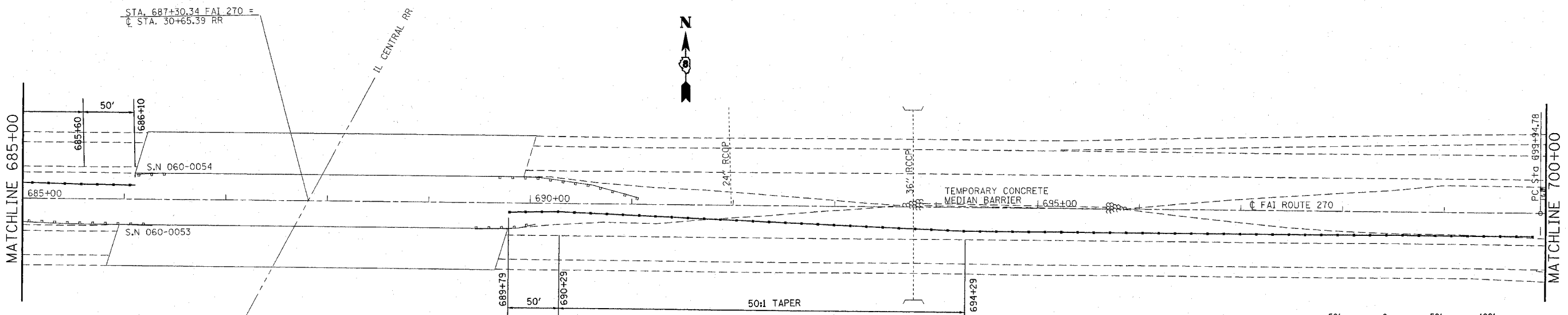

STA. 687+30.34 FAI 270 =
 C STA. 30+65.39 RR

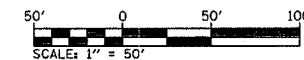

INLET AND PIPE PROTECTION

MULCH

REVISIONS	
NAME	DATE

ILLINOIS DEPARTMENT OF TRANSPORTATION
EROSION CONTROL PLAN
AREA #3
 FAI RTE 270
 SECTION 60-(1,2,3,4,5)I
 MADISON COUNTY

SCALE: VERT.
 DATE:

DRAWN BY
 CHECKED BY