

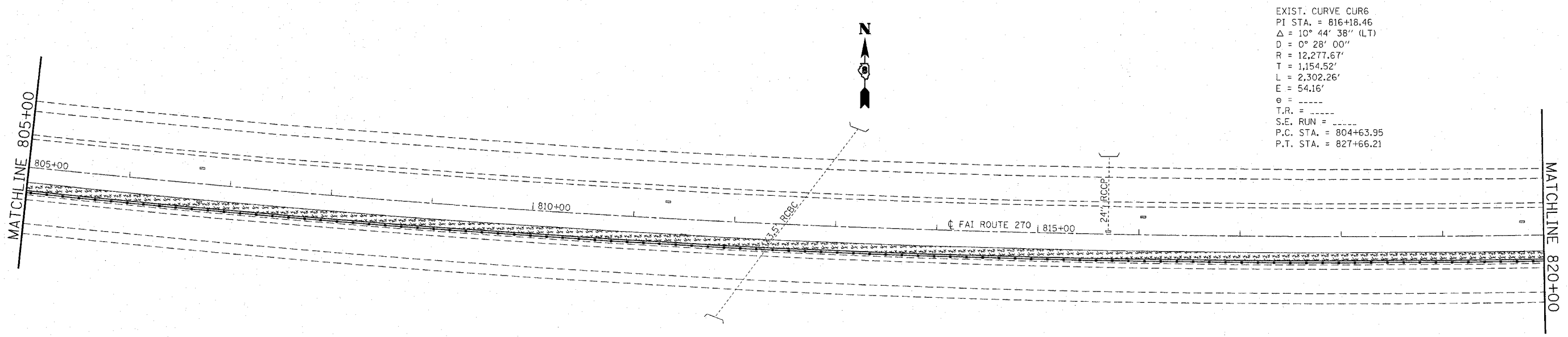

| F.A.I. RTE. | SECTION | COUNTY | TOTAL SHEETS | SHEET NO. |
|------------------------------|-----------------|------------------|--------------|-----------|
| 270 | 60-(1,2,3,4,5)I | MADISON | 46 | 44 |
| STA. 790+00 | | TO STA. 820+00 | | |
| FED. ROAD DIST. NO. ILLINOIS | | FED. AID PROJECT | | |

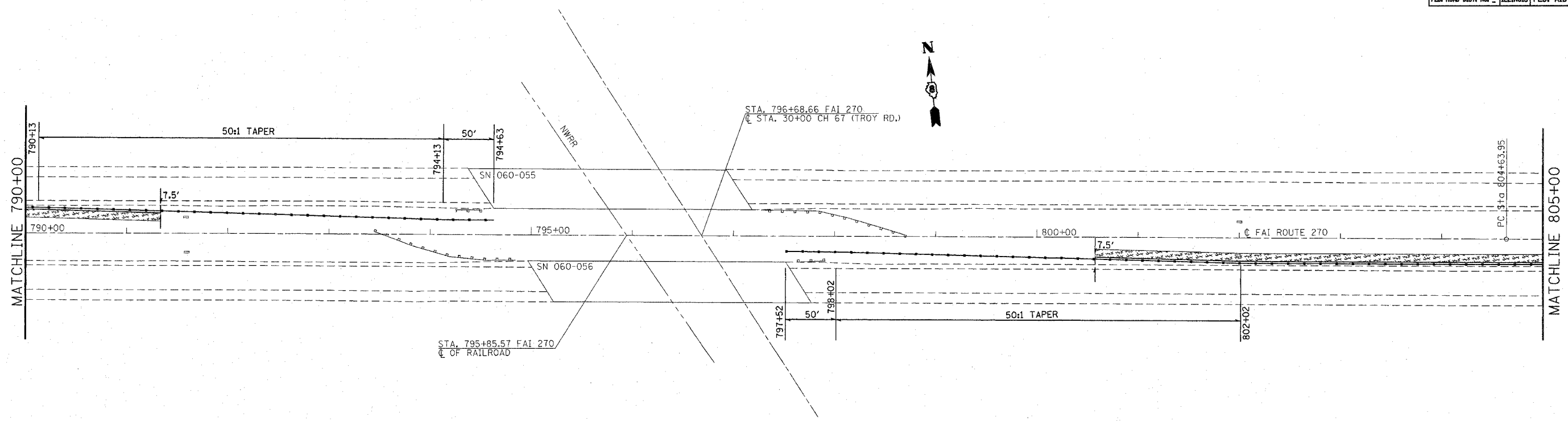

EXIST. CURVE CUR6
 PI STA. = 816+18.46
 Δ = 10° 44' 38" (LT)
 D = 0° 28' 00"
 R = 12,277.67'
 T = 1,154.52'
 L = 2,302.26'
 E = 54.16'
 e = -----
 T.R. = -----
 S.E. RUN = -----
 P.C. STA. = 804+63.95
 P.T. STA. = 827+66.21

-  INLET AND PIPE PROTECTION
-  MULCH

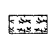
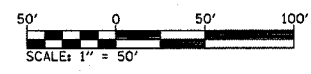

| REVISIONS | |
|-----------|------|
| NAME | DATE |
| | |
| | |
| | |
| | |
| | |
| | |
| | |
| | |
| | |
| | |

ILLINOIS DEPARTMENT OF TRANSPORTATION
EROSION CONTROL PLAN
AREA #3
 FAI RTE 270
 SECTION 60-(1,2,3,4,5)I
 MADISON COUNTY

SCALE: VERT. _____
 HORIZ. _____
 DATE _____
 DRAWN BY _____
 CHECKED BY _____

PLOT DATE = 12/12/2007
 C:\pwworkspace\104952876\plan\eropl\eropl270.dgn
 PLOT SCALE = 1" = 50'
 REFERENCE = #REF#