

F.A.U. RTE.	SECTION	COUNTY	TOTAL SHEETS	SHEET NO.
363	06-00339-00-TL	KANE	33	7
STA.		TO STA.		
FED. ROAD DIST. NO. 7		ILLINOIS FED. AID PROJECT		

**TRAFFIC SIGNAL LEGEND**

EXISTING	PROPOSED	EXISTING	PROPOSED
CONTROLLER		EMERGENCY VEHICLE SYSTEM DETECTOR	
SERVICE INSTALLATION		CONFIRMATION BEACON	
SIGNAL HEAD		SIGNAL HEAD PROGRAMMED	
SIGNAL HEAD WITH BACKPLATE		CONDUIT SPLICE	
SIGNAL HEAD, PEDESTRIAN		WOOD POLE	
SIGNAL POST		RACEWAY FOR MAGNETIC DETECTOR, TYPE I OR TYPE II	
MAST ARM ASSEMBLY AND POLE, STEEL		VEHICLE DETECTOR, NON COMPENSATED MAGNETIC TYPE	
MAST ARM ASSEMBLY AND POLE, ALUMINUM		RAILROAD CONTROLLER	
COMBINATION MAST ARM ASSEMBLY AND POLE, STEEL		ILLUMINATED SIGN, FIBER OPTIC NO LEFT TURN	
COMMON TRENCH		ILLUMINATED SIGN, FIBER OPTIC NO RIGHT TURN	
UNIT DUCT		TELEPHONE CONNECTION	
HANDHOLE		UNINTERRUPTIBLE POWER SUPPLY	
HEAVY-DUTY HANDHOLE		VIDEO DETECTION CAMERA	
DOUBLE HANDHOLE		PTZ CAMERA	
G.S. CONDUIT IN TRENCH OR PUSHED		EXISTING EQUIPMENT TO BE RELOCATED	
PEDESTRIAN PUSH-BUTTON DETECTOR			
DETECTOR LOOP			
CAST IRON JUNCTION BOX			

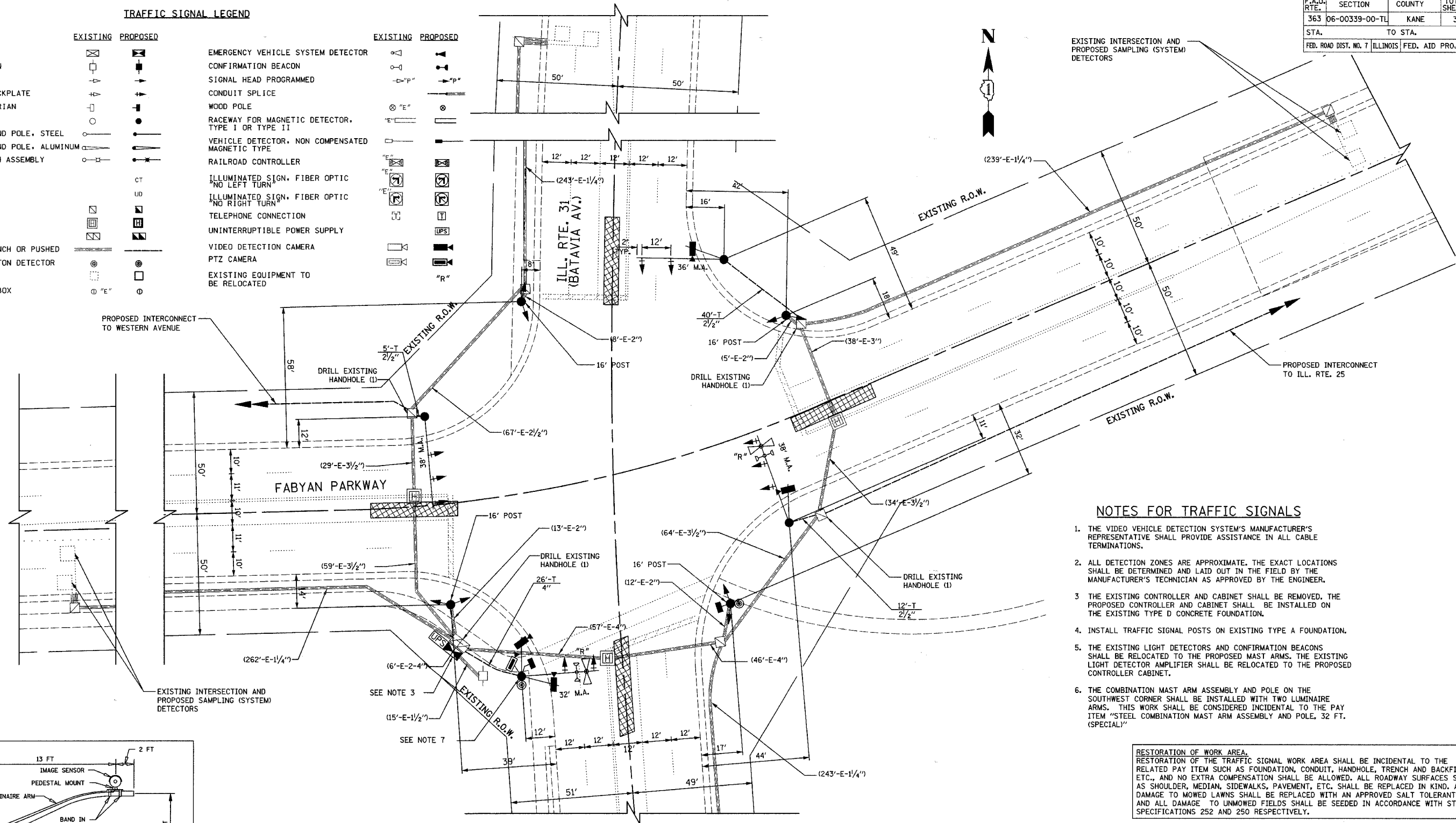

**NOTES FOR TRAFFIC SIGNALS**

1. THE VIDEO VEHICLE DETECTION SYSTEM'S MANUFACTURER'S REPRESENTATIVE SHALL PROVIDE ASSISTANCE IN ALL CABLE TERMINATIONS.
2. ALL DETECTION ZONES ARE APPROXIMATE. THE EXACT LOCATIONS SHALL BE DETERMINED AND LAID OUT IN THE FIELD BY THE MANUFACTURER'S TECHNICIAN AS APPROVED BY THE ENGINEER.
3. THE EXISTING CONTROLLER AND CABINET SHALL BE REMOVED. THE PROPOSED CONTROLLER AND CABINET SHALL BE INSTALLED ON THE EXISTING TYPE D CONCRETE FOUNDATION.
4. INSTALL TRAFFIC SIGNAL POSTS ON EXISTING TYPE A FOUNDATION.
5. THE EXISTING LIGHT DETECTORS AND CONFIRMATION BEACONS SHALL BE RELOCATED TO THE PROPOSED MAST ARMS. THE EXISTING LIGHT DETECTOR AMPLIFIER SHALL BE RELOCATED TO THE PROPOSED CONTROLLER CABINET.
6. THE COMBINATION MAST ARM ASSEMBLY AND POLE ON THE SOUTHWEST CORNER SHALL BE INSTALLED WITH TWO LUMINAIRE ARMS. THIS WORK SHALL BE CONSIDERED INCIDENTAL TO THE PAY ITEM "STEEL COMBINATION MAST ARM ASSEMBLY AND POLE, 32 FT. (SPECIAL)"

**RESTORATION OF WORK AREA.**  
 RESTORATION OF THE TRAFFIC SIGNAL WORK AREA SHALL BE INCIDENTAL TO THE RELATED PAY ITEM SUCH AS FOUNDATION, CONDUIT, HANDHOLE, TRENCH AND BACKFILL, ETC., AND NO EXTRA COMPENSATION SHALL BE ALLOWED. ALL ROADWAY SURFACES SUCH AS SHOULDER, MEDIAN, SIDEWALKS, PAVEMENT, ETC. SHALL BE REPLACED IN KIND. ALL DAMAGE TO MOWED LAWNS SHALL BE REPLACED WITH AN APPROVED SALT TOLERANT SOD, AND ALL DAMAGE TO UNMOWED FIELDS SHALL BE SEEDED IN ACCORDANCE WITH STANDARD SPECIFICATIONS 252 AND 250 RESPECTIVELY.

**NOTE:**  
 THE TRAFFIC SIGNAL CONTROLLER EQUIPMENT FOR THIS PROJECT SHALL BE "EAGLE" TO MATCH THE EXISTING ADJACENT SYSTEM.

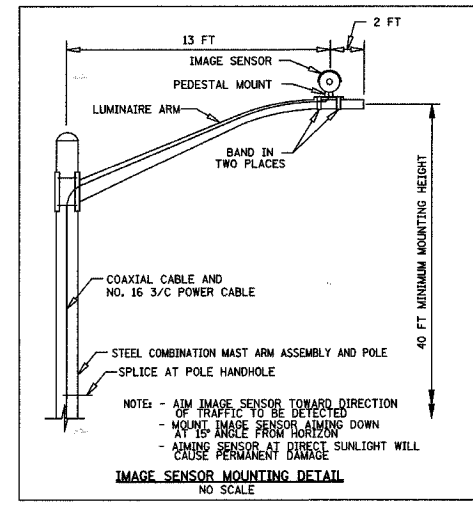

REVISIONS	
NAME	DATE

KANE COUNTY DIVISION OF TRANSPORTATION  
**TRAFFIC SIGNAL MODIFICATION PLAN**  
 FABYAN PARKWAY &  
 ILL. RTE. 31 (BATAVIA AV.)  
 SCALE: 1" = 20'  
 DATE: 12/14/2007  
 DRAWN BY: CEC  
 DESIGNED BY: BRD/JSH  
 CHECKED BY: JJE