

F.A.U. RTE.	SECTION	COUNTY	TOTAL SHEETS	SHEET NO.
363	06-00339-00-TL	KANE	33	16
STA.		TO STA.		
FED. ROAD DIST. NO. 7 ILLINOIS		FED. AID PROJECT		

EXISTING AND PROPOSED CONTROLLER SEQUENCE

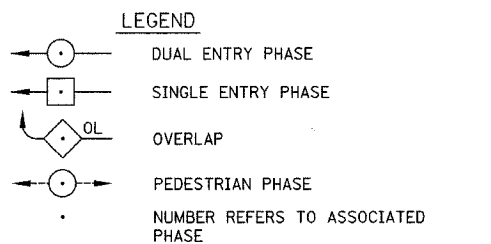

PHASE DESIGNATION DIAGRAM

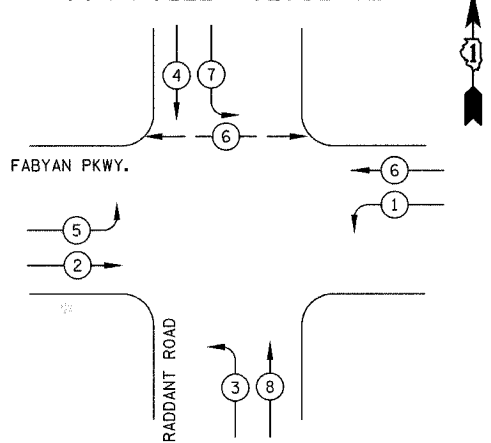
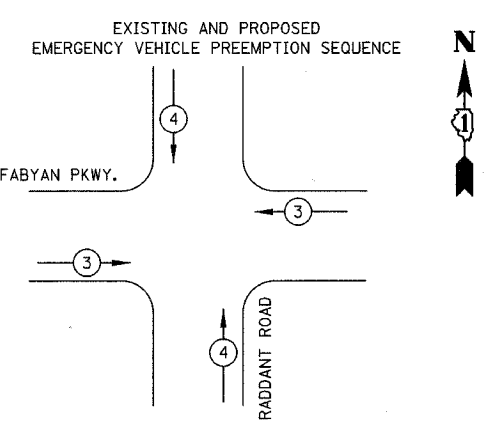

PROPOSED EMERGENCY VEHICLE PREEMPTORS

EMERGENCY VEHICLE PREEMPTOR	3	4
MOVEMENT	←	↑

CABLE PLAN LEGEND

- | | | |
|----------|----------|---|
| EXISTING | PROPOSED | |
| | | 8" (200mm) TRAFFIC SIGNAL SECTION |
| | | 12" (300mm) TRAFFIC SIGNAL SECTION |
| | | 12" (300mm) PEDESTRIAN SIGNAL SECTION |
| | | 12" (300mm) PEDESTRIAN SIGNAL SECTION |
| | | CONTROLLER CABINET |
| | | SERVICE INSTALLATION |
| | | TELEPHONE CONNECTION |
| | | MAGNETIC DETECTOR |
| | | EMERGENCY VEHICLE LIGHT DETECTOR |
| | | CONFIRMATION BEACON |
| | | PUSHBUTTON DETECTOR |
| | | VEHICLE DETECTOR, INDUCTION LOOP |
| | | MICROWAVE VEHICLE SENSOR |
| | | SIGNAL FACE WITH BACKPLATE, "P" INDICATES PROGRAMMED HEAD |
| | | RAILROAD CONTROL CABINET |
| | | ILLUMINATED SIGN "NO LEFT TURN" |
| | | ILLUMINATED SIGN "NO RIGHT TURN" |
| | | GROUND ROD AT HANDHOLE (H), DOUBLE HANDHOLE (H), OR CONTROLLER (C). |
| | | GROUND ROD AT POST (P), OR MAST ARM POLE (MA). |
| | | GROUND ROD AT ELECTRIC SERVICE INSTALLATION |
| | | GROUND CABLE IN CONDUIT NO. 6 SOLID COPPER (GREEN) |
| | | FIBER OPTIC CABLE IN CONDUIT NO. 62.5/125 2-MM12F SM12F |
| | | COAXIAL CABLE |
| | | IMAGE SENSOR |
| | | STREET LIGHT LUMINAIRE |
| | | PTZ CAMERA |
| | | UNINTERRUPTIBLE POWER SUPPLY |
| | | "R" RELOCATED SIGNAL EQUIPMENT |

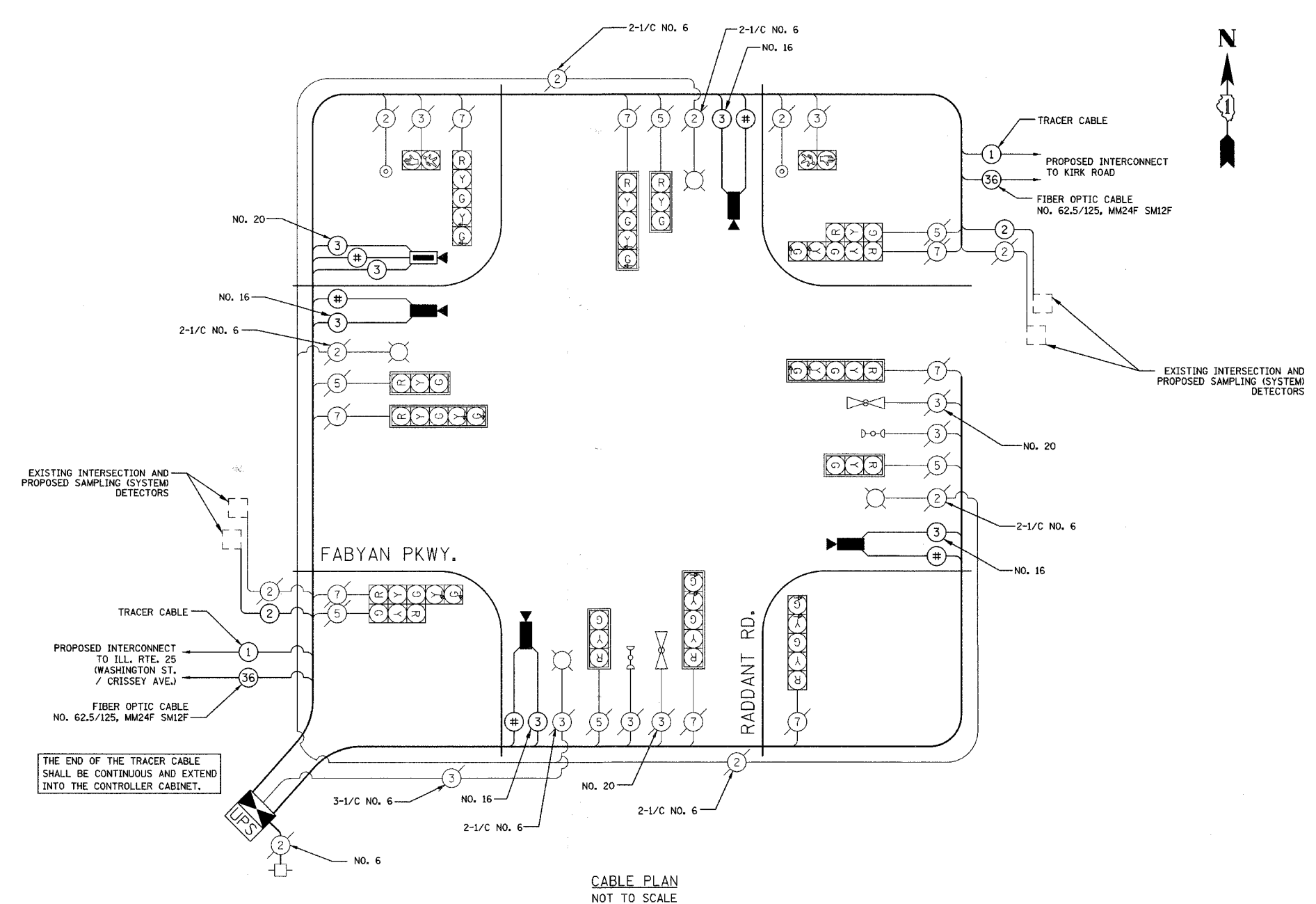

SCHEDULE OF QUANTITIES

PAY ITEM	UNIT	QUANTITY
MAINTENANCE OF EXISTING TRAFFIC SIGNAL INSTALLATION	EACH	1
FULL-ACTUATED CONTROLLER AND TYPE IV CABINET, SPECIAL	EACH	1
TRANSCEIVER - FIBER OPTIC	EACH	1
ELECTRIC CABLE IN CONDUIT, SIGNAL NO. 14 3C	FOOT	199
ELECTRIC CABLE IN CONDUIT, LEAD-IN, NO. 14 1 PAIR	FOOT	811
RELOCATE EXISTING EMERGENCY VEHICLE PRIORITY SYSTEM,	EACH	1
PHASING UNIT		
REMOVE ELECTRIC CABLE FROM CONDUIT	FOOT	1404
REMOVE EXISTING TRAFFIC SIGNAL EQUIPMENT	EACH	1
REMOVE EXISTING HANDHOLE	EACH	1
UNINTERRUPTIBLE POWER SUPPLY	EACH	1
ELECTRIC CABLE IN CONDUIT, SIGNAL NO. 16 3/C	FOOT	861
ELECTRIC CABLE IN CONDUIT, COAXIAL	FOOT	1060
ELECTRIC CABLE IN CONDUIT, VIDEO, NO. 20 3C	FOOT	199
VIDEO DETECTION SYSTEM COMPLETE INTERSECTION	EACH	1
INTERSECTION VIDEO TRAFFIC MONITORING SYSTEM WITH PTZ CAMERA	EACH	1

REVISIONS

NAME	DATE

KANE COUNTY DIVISION OF TRANSPORTATION
**CABLE PLAN, PHASE DESIGNATION
 DIAGRAM, EMERGENCY VEHICLE
 PREEMPTION SEQUENCE AND
 SCHEDULE OF QUANTITIES**
 FABYAN PARKWAY & RADDANT ROAD
 SCALE: NOT TO SCALE
 DATE: 12/14/2007
 DRAWN BY: GEC
 DESIGNED BY: BRD/JSH
 CHECKED BY: JJE

I.D.O.T. TRAFFIC SIGNAL INSTALLATION ELECTRICAL SERVICE REQUIREMENTS

TYPE	NO. LAMPS	WATTAGE	% OPERATION	TOTAL WATTAGE
SIGNAL (RED)	14	17	0.50	119
(YELLOW)	14	25	0.25	88
(GREEN)	14	15	0.25	53
ARROW	16	12	0.10	20
PED. SIGNAL	2	25	1.00	50
CONTROLLER	1	100	1.00	100
VIDEO SYSTEMS	1	150	1.00	150
LUMINAIRE	4	310	0.50	620
FLASHER			0.50	
TOTAL =				1200

ENERGY COSTS TO: CITY OF BATAVIA
 100 N. ISLAND AVENUE
 BATAVIA, IL 60510
 CONTACT: STEVE LUSTED
 PHONE: (630) 879-1424
 COMPANY: CITY OF BATAVIA

FOUNDATION (DEPTH)	FT. (m)	CABLE SLACK	FT. (m)	VERTICAL	FT. (m)
TYPE A - POST	4 (1.2)	HANDHOLE	6.5 (2.0)	ALL FOUNDATIONS	3.5 (2.0)
D- CONTROLLER	4 (1.2)	DOUBLE HANDHOLE	13 (4.0)	MAST ARM (L) POLE	20'±L-2'±
E- M. ARM POLE		SIGNAL POST	2 (1.0)	6m±L-0.6m±	
24" (600mm)	10 (3.0)	CONTROLLER CAB.	1 (0.5)	BRACKET MOUNTED	13 (4.0)
30" (750mm)	15 (4.6)	FIBER OPTIC	13 (4.0)	PED. PUSHBUTTON	4 (1.2)
36" (900mm)	15 (4.6)	ELECTRIC SERVICE	1 (0.5)	ELECTRIC SERVICE	13.5 (4.1)
		GROUND CABLE	1 (0.5)	SERVICE TO GROUND	13.5 (4.1)
				POST MOUNTED	6 (1.8)