

FILE NO.	SECTION	COUNTY	TOTAL SHEETS	SHEET NO.
1380	00-0084-00-PV	DUPAGE	93	16
STA. 193+00	TO STA. 198+00			

CONTRACT NUMBER 83993

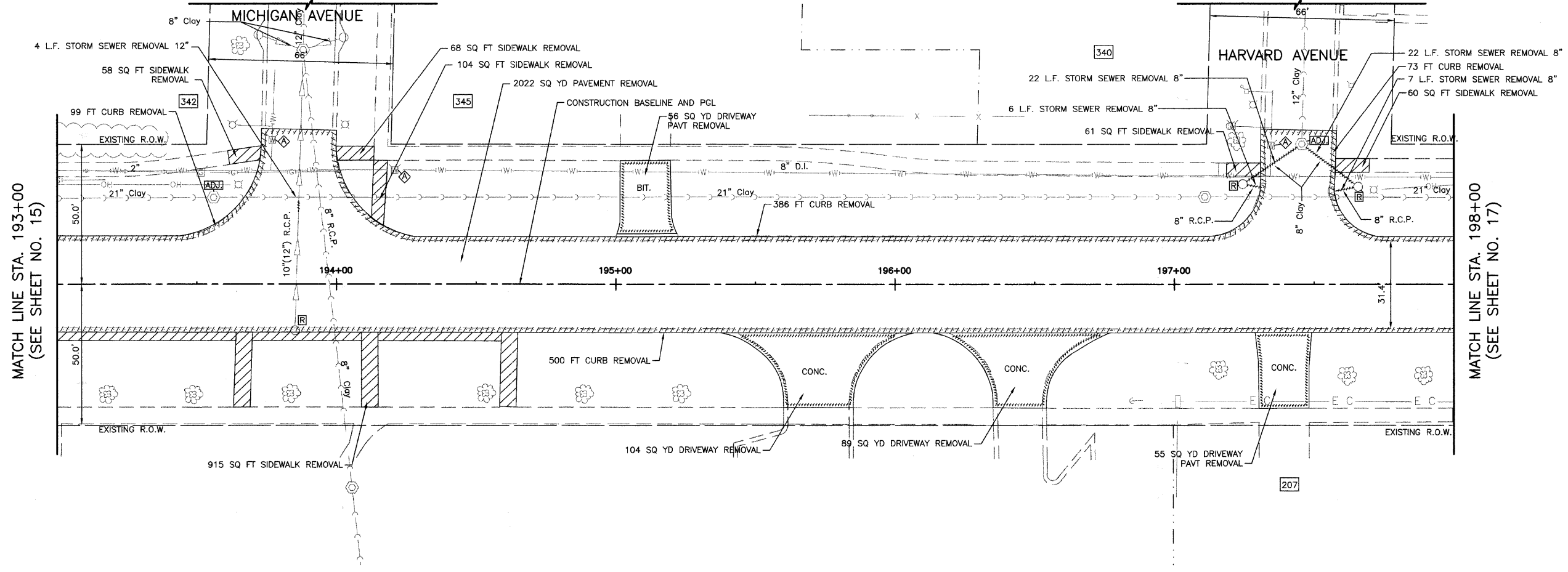

FULLERTON AVENUE
EXISTING TOPOGRAPHY

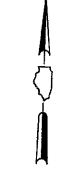
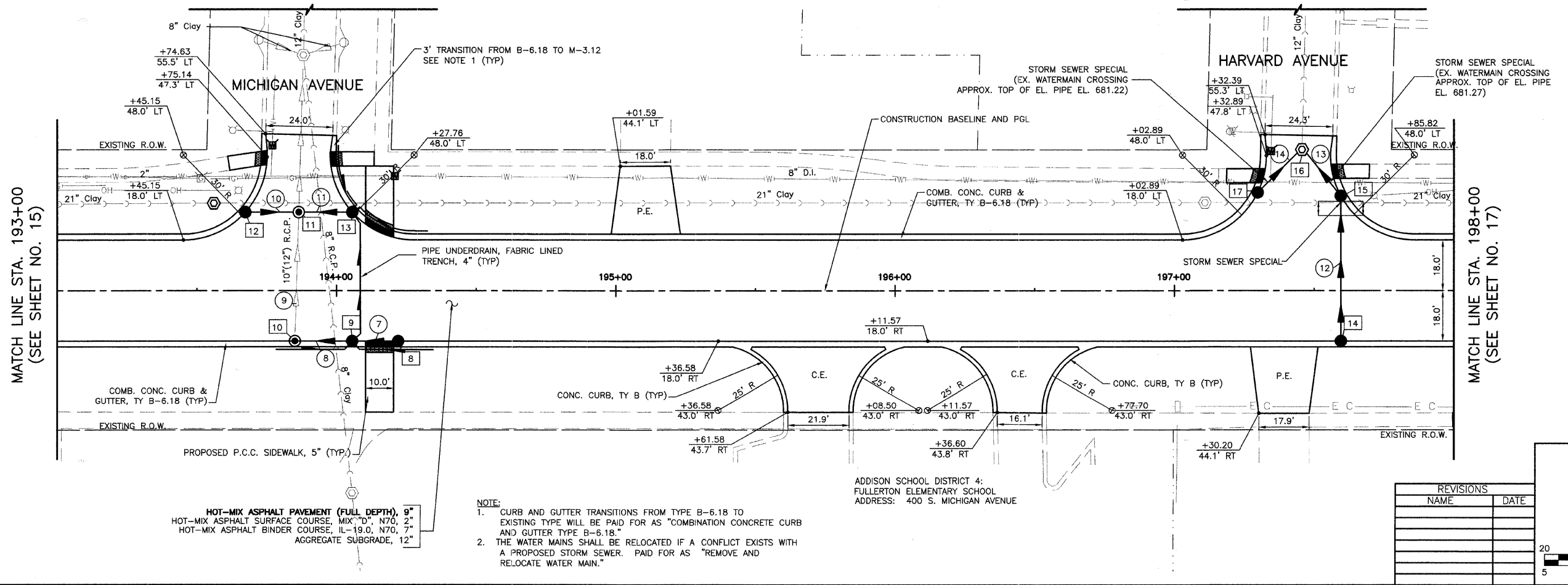

FULLERTON AVENUE
PROPOSED IMPROVEMENTS

VILLAGE OF ADDISON

ROADWAY PLAN
FULLERTON AVENUE

STA. 193+00 TO 198+00

REVISIONS	
NAME	DATE

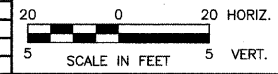

DATE: 11/26/2007
DESIGNED BY: RTM
TECHNICIAN: JRR
CHECKED BY: JRV

HOT-MIX ASPHALT PAVEMENT (FULL DEPTH), 9"
HOT-MIX ASPHALT SURFACE COURSE, MIX "D", N70, 2"
HOT-MIX ASPHALT BINDER COURSE, IL-19.0, N70, 7"
AGGREGATE SUBGRADE, 12"

- NOTE:**
- CURB AND GUTTER TRANSITIONS FROM TYPE B-6.18 TO EXISTING TYPE WILL BE PAID FOR AS "COMBINATION CONCRETE CURB AND GUTTER TYPE B-6.18."
 - THE WATER MAINS SHALL BE RELOCATED IF A CONFLICT EXISTS WITH A PROPOSED STORM SEWER. PAID FOR AS "REMOVE AND RELOCATE WATER MAIN."

ADDISON SCHOOL DISTRICT 4:
FULLERTON ELEMENTARY SCHOOL
ADDRESS: 400 S. MICHIGAN AVENUE