

FILE NO.	SECTION	COUNTY	TOTAL SHEETS	SHEET NO.
1380	00-00084-00-PV	DUPAGE	93	35
STA. FIRST STA.		TO STA. SECOND STA.		
		ILLINOIS		SURFACE TRANSPORTATION FUNDING
CONTRACT NUMBER 83993				

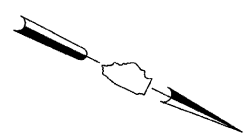

NOTE:
FINAL SIGN PLACEMENT ALONG VILLA AVENUE WILL BE THE RESPONSIBILITY OF DCDOT.
THE COUNTY SHALL BE CONTACTED WELL IN ADVANCE OF SIGNS TO BE INSTALLED.

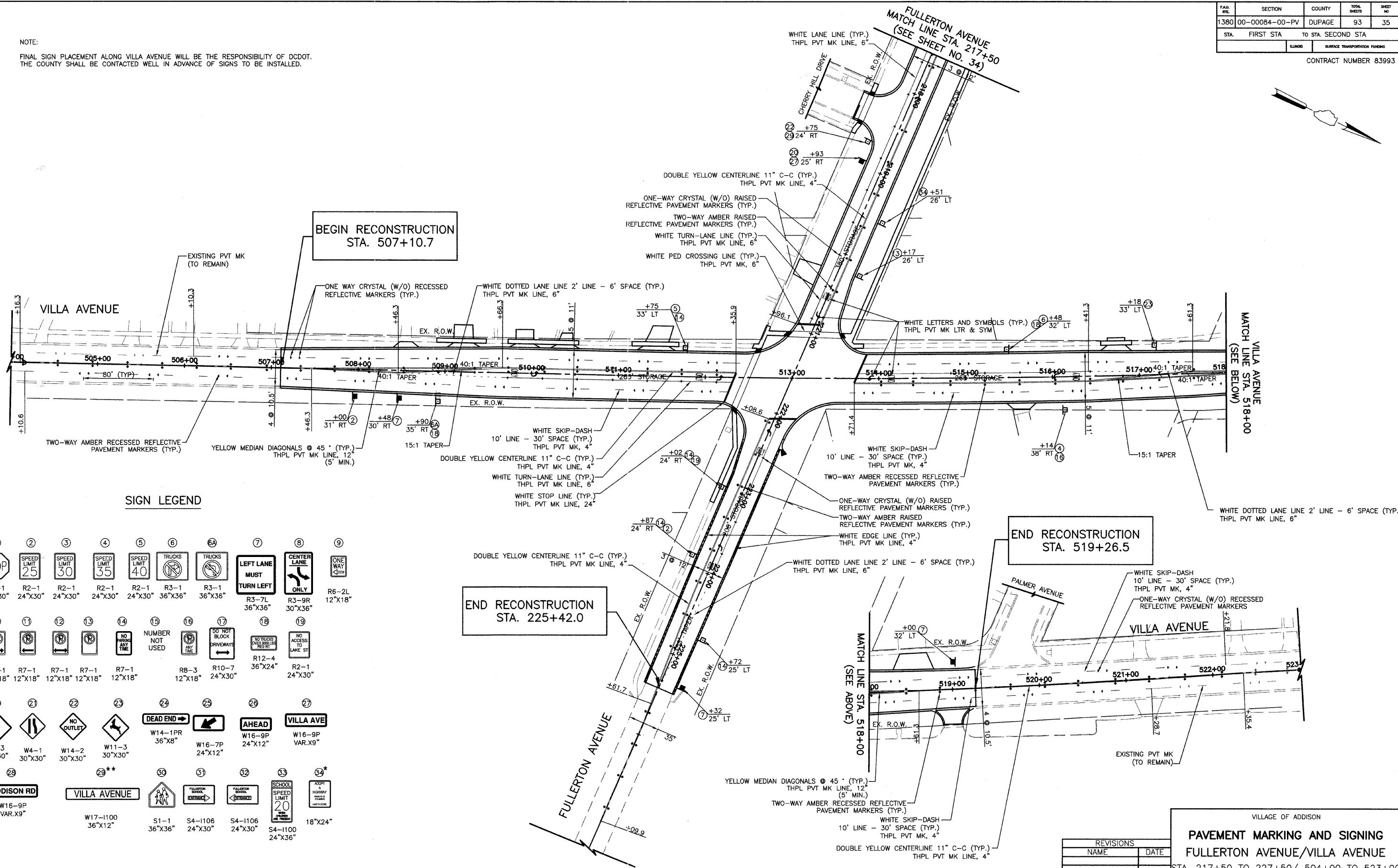

SIGN LEGEND

- | | | | | | | | | | |
|---------------------------------------|--|--|---|---|---|---|---|---|--|
| 1
STOP
R1-1
30"x30" | 2
SPEED LIMIT 25
R2-1
24"x30" | 3
SPEED LIMIT 30
R2-1
24"x30" | 4
SPEED LIMIT 35
R2-1
24"x30" | 5
SPEED LIMIT 40
R2-1
24"x30" | 6
TRUCKS
R3-1
36"x36" | 6A
TRUCKS
R3-1
36"x36" | 7
LEFT LANE MUST TURN LEFT
R3-7L
36"x36" | 8
CENTER LANE ONLY
R3-9R
30"x36" | 9
ONE WAY
R6-2L
12"x18" |
| 10
NO LEFT TURN
R7-1
12"x18" | 11
NO RIGHT TURN
R7-1
12"x18" | 12
NO U-TURN
R7-1
12"x18" | 13
NO THROUGH TRUCKS
R7-1
12"x18" | 14
NO PARKING ANY TIME
R7-1
12"x18" | 15
NUMBER NOT USED
R8-3
12"x18" | 16
NO TRUCKS OVER 10,000 LB RES WT
R10-7
24"x30" | 17
DO NOT BLOCK DRIVEWAYS
R12-4
36"x24" | 18
NO ACCESS TO LAKE ST
R2-1
24"x30" | 19
NO TRUCKS OVER 10,000 LB RES WT
R2-1
24"x30" |
| 20
AHEAD
W3-3
30"x30" | 21
AHEAD
W4-1
30"x30" | 22
NO OUTLET
W14-2
30"x30" | 23
DEAD END
W11-3
30"x30" | 24
DEAD END
W14-1PR
36"x8" | 25
AHEAD
W16-7P
24"x12" | 26
VILLA AVE
W16-9P
VAR.X9" | 27
VILLA AVE
W16-9P
VAR.X9" | 28
ADDISON RD
W16-9P
VAR.X9" | 29**
VILLA AVENUE
W17-1100
36"x12" |
| 30
SCHOOL AHEAD
S1-1
36"x36" | 31
SCHOOL AHEAD
S4-1106
24"x30" | 32
SCHOOL AHEAD
S4-1106
24"x30" | 33
SCHOOL SPEED LIMIT 20
S4-1100
24"x36" | 34
SCHOOL SPEED LIMIT 20
S4-1100
24"x36" | 35
SCHOOL SPEED LIMIT 20
S4-1100
24"x36" | 36
SCHOOL SPEED LIMIT 20
S4-1100
24"x36" | 37
SCHOOL SPEED LIMIT 20
S4-1100
24"x36" | 38
SCHOOL SPEED LIMIT 20
S4-1100
24"x36" | 39
SCHOOL SPEED LIMIT 20
S4-1100
24"x36" |

REVISIONS	
NAME	DATE

VILLAGE OF ADDISON

PAVEMENT MARKING AND SIGNING

FULLERTON AVENUE/VILLA AVENUE

STA. 217+50 TO 227+50/ 504+00 TO 523+00

50 0 50 HORIZ.

SCALE IN FEET

DATE: 11/26/2007
DESIGNED BY: RTM
TECHNICIAN: JRR
CHECKED BY: JRV