

FILE NO.	SECTION	COUNTY	TOTAL SHEETS	SHEET NO.
1380	00-00084-00-PV	DUPAGE	93	58
STA.	FIRST STA.	TO STA.	SECOND STA.	

CONTRACT NUMBER 83993

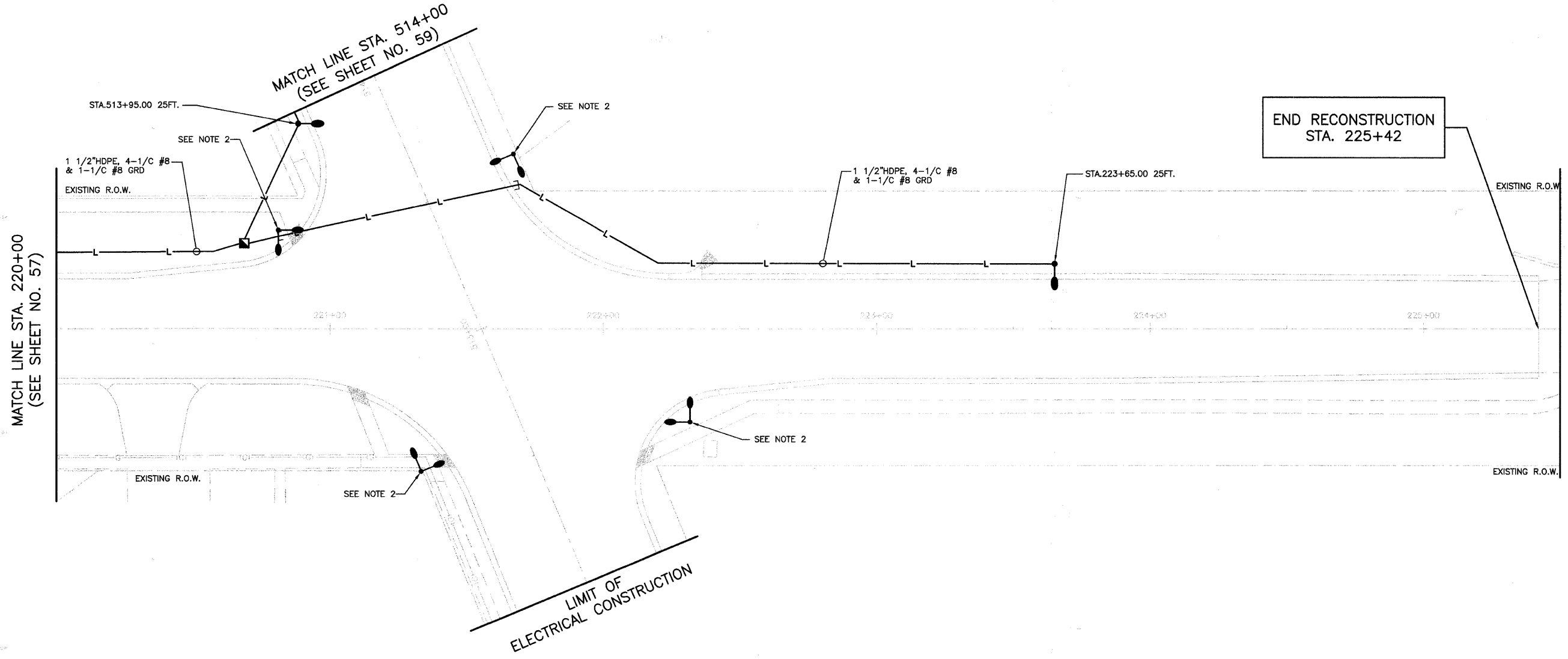

END RECONSTRUCTION  
STA. 225+42

- NOTES:**
1. ALL POLES MARKED "NF" REQUIRE NON-FRANGIBLE MOUNTING. ALL POLES MARKED AS "OS" REQUIRE OFFSET FOUNDATION.
  2. REFER TO TRAFFIC SIGNAL PLANS FOR EXACT LOCATION OF COMBINATION TRAFFIC SIGNAL/MAST ARM POLES.

REVISIONS	
NAME	DATE

VILLAGE OF ADDISON

**LIGHTING PLAN**

FULLERTON AVENUE

STA. 220+00 TO 225+42

DATE: 11/26/2007  
DESIGNED BY: FEI  
TECHNICIAN: FEI  
CHECKED BY: DEM

20 0 20 HORIZ.  
5 5 VERT.  
SCALE IN FEET