

STR. NO.	STATION	OFFSET	TYPE	F & G	RIM EL.	INV. N	INV. S	INV. E	INV. W
1	21+25.00	43.50' RT	42" PRC EQUIV F.E.S.	--	--	--	--	--	846.94
2	20+92.96	40.26' RT	6" MH TYPE A	TYPE 1 CLOSED	849.21	--	--	844.4	844.3
3	20+33.72	40.37' RT	6" MH TYPE A	TYPE 1 CLOSED	851.24	847.91	--	843.48	843.38
4	20+36.81	26.58' RT	CATCH BASIN SPECIAL	TYPE IIV	851.10	--	848.10	--	--
5	18+92.83	53.62' RT	42" PRC EQUIV F.E.S.	--	--	--	--	841.50	--
6	22+72.65	36.65' RT	SLOPED METAL E.S. WITH GRATE	--	--	--	--	848.02	--

PIPE NO.	U/S-D/S	LENGTH (FT)	SIZE (INCH)	U/S INV.	D/S INV.	SLOPE (%)	CLASS/TYPE
1	1-2	30	42	844.4	846.69	7.6	TYPE 1, REINF. CONC., EQUIVALENT RND
2	2-3	58	42	844.3	843.48	1.4	TYPE 1, REINF. CONC., EQUIVALENT RND
3	4-3	15	12	848.10	847.91	1.2	STORM SEWERS, CLASS A, TYPE 1
4	3-5	140	42	843.38	841.50	1.3	TYPE 1, REINF. CONC., EQUIVALENT RND

F.A. RTE.	SECTION	COUNTY	TOTAL SHEETS	SHEET NO.
04-00166-00-BR	DEKALB	38	10	
STA. 14+00		TO STA. 23+00		
FED. ROAD DIST. NO. ILLINOIS FED. AID PROJECT				
CONTRACT NO. 87339				

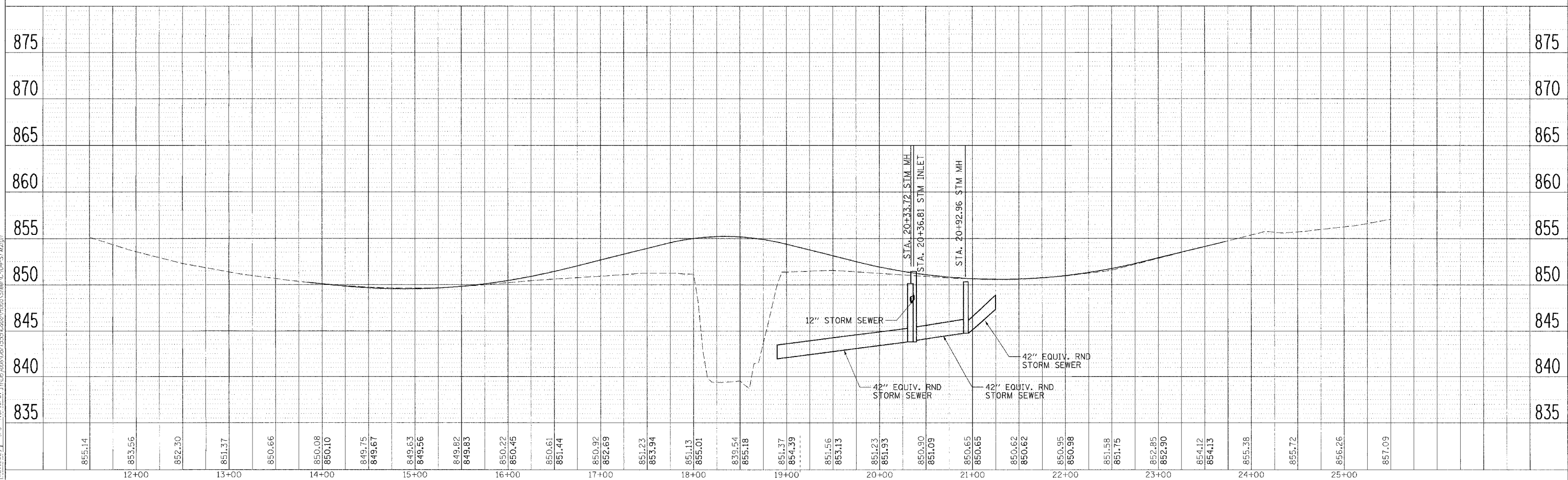
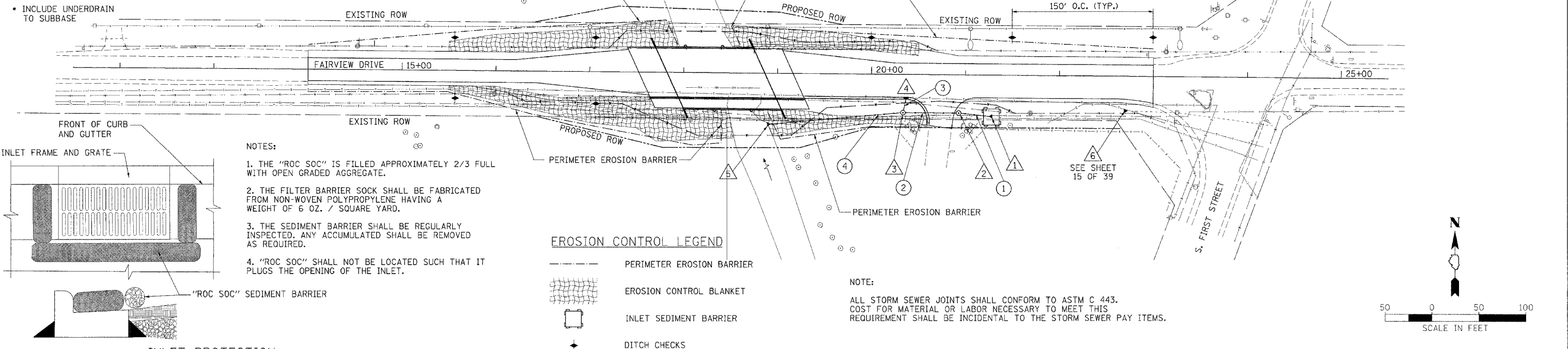

STORM WATER MANAGEMENT & EROSION CONTROL PLAN

LAYOUT: 01/16/07
 DRAWN: MPH 10/19/07
 REVIEWED: CPS 10/19/07
 DATE: 01/16/07
 PROJECT: 04-00166-00-BR