

PLAN	SURVEYED	DATE
	PLOTTED	BY
	GRADES CHECKED	
	STRUCTURE NOTATIONS CHECKED	
	NOTE BOOK NO.	
	FILE NAME	

PROFILE	SURVEYED	DATE
	PLOTTED	BY
	GRADES CHECKED	
	STRUCTURE NOTATIONS CHECKED	
	NOTE BOOK NO.	
	FILE NAME	

\*REF: plan02  
\*REF: prof02

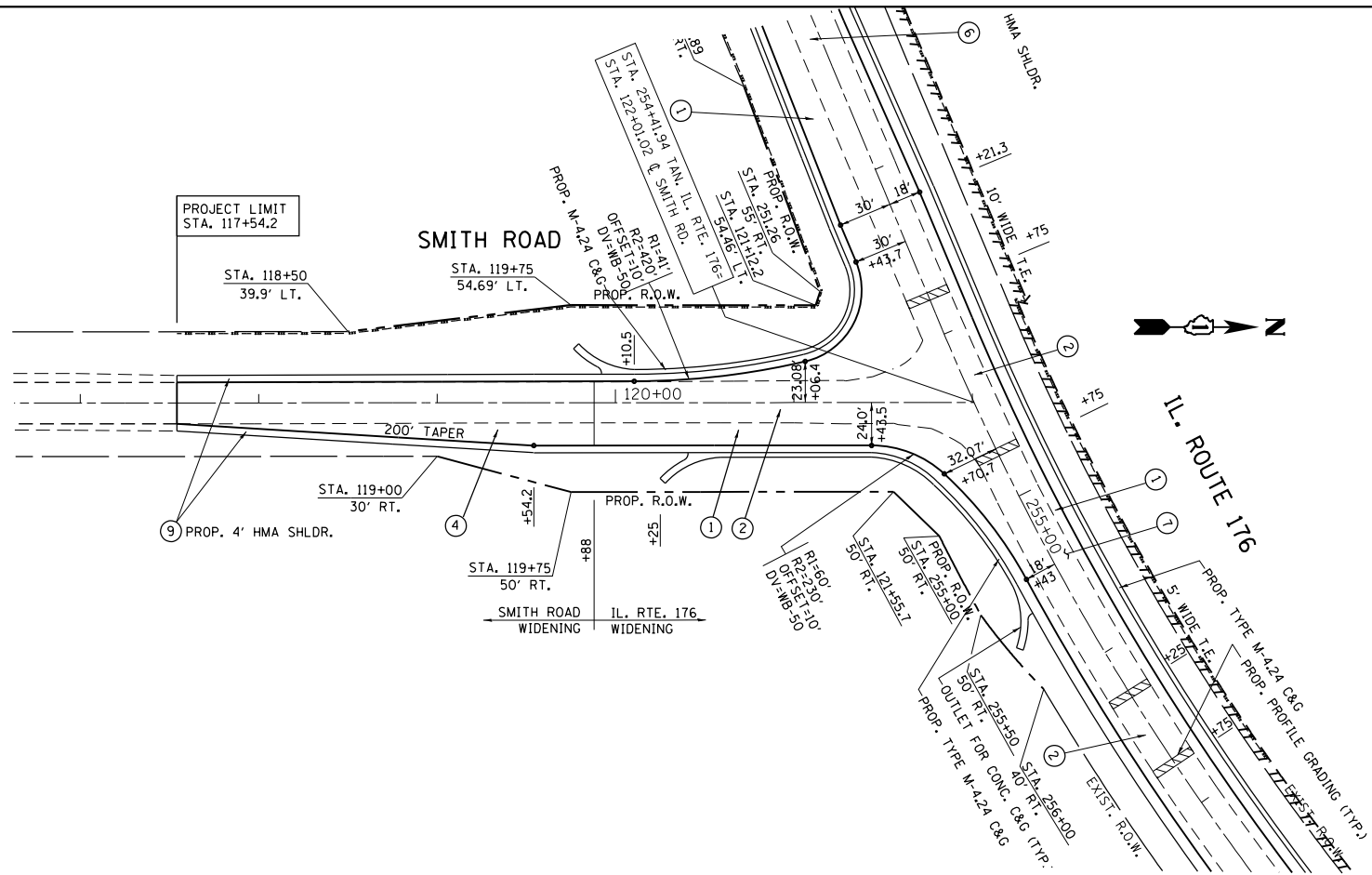

**LEGEND:**

- ① IL. RTE. 176 (WIDENING)
  - PROPOSED AGGREGATE SUBGRADE IMPROVEMENT, 12"
  - PROPOSED HOT-MIX ASPHALT BASE COURSE, (HMA BINDER IL 19 mm, N90), 9"
  - PROPOSED POLYMERIZED HOT-MIX ASPHALT SURFACE COURSE, MIX "F", N90, (IL 9.5 mm), 2 1/2"
- ② (RESURFACING)
  - PROPOSED HOT-MIX ASPHALT SURFACE REMOVAL 2 1/2"
  - PROPOSED POLYMERIZED HOT-MIX ASPHALT SURFACE COURSE, MIX "F", N90, (IL 9.5 mm), 2 1/2"
- ③ (HMA CE)
  - PROPOSED HOT-MIX ASPHALT BASE COURSE, (HMA BINDER, IL 19 mm), 8"
  - PROPOSED HOT-MIX ASPHALT SURFACE COURSE, MIX "D", N50, (IL 9.5 mm), 2"
- ④ SMITH ROAD (WIDENING)
  - PROPOSED AGGREGATE SUBGRADE IMPROVEMENT, 12"
  - PROPOSED HOT-MIX ASPHALT BASE COURSE, (HMA BINDER IL 19 mm, N90), 4 1/2 "
  - PROPOSED POLYMERIZED HOT-MIX ASPHALT SURFACE COURSE, MIX "F", N90, (IL 9.5 mm), 2 1/2"
- ⑤ (RESURFACING)
  - PROPOSED HOT-MIX ASPHALT SURFACE REMOVAL, 4"
  - PROPOSED POLYMERIZED HOT-MIX ASPHALT SURFACE COURSE, MIX "F", N90, (IL 9.5 mm), 2 1/2"
- ⑥ - PROPOSED HOT-MIX ASPHALT SURFACE REMOVAL 2 1/2"
- PROPOSED POLYMERIZED HOT-MIX ASPHALT SURFACE COURSE, MIX "F", N90, (IL 9.5 mm), 2 1/2"
- PROPOSED HOT-MIX ASPHALT BINDER COURSE, IL-19.0, N90, 4"
- ⑦ - PROPOSED HOT-MIX ASPHALT SURFACE REMOVAL 2 3/4"
- PROPOSED POLYMERIZED HOT-MIX ASPHALT SURFACE COURSE, MIX "F", N90, (IL 9.5 mm), 2 1/2"
- PROPOSED HOT-MIX ASPHALT BINDER COURSE, IL-19.0, N90, 2 1/4"
- ⑧ - (SHOULDER ALONG IL 176)
  - PROPOSED HOT-MIX ASPHALT SHOULDER (HMA BINDER IL 19 mm), 5 1/2 "
  - PROPOSED POLYMERIZED HOT-MIX ASPHALT SURFACE COURSE, MIX "F", N90, IL 9.5 mm), 2 1/2 "
- ⑨ - (SHOULDER ALONG SMITH RD.)
  - PROPOSED HOT-MIX ASPHALT SHOULDER (HMA BINDER IL 19 mm), 4 1/2 "
  - PROPOSED POLYMERIZED HOT-MIX ASPHALT SURFACE COURSE, MIX "F", N90, IL 9.5 mm), 2 1/2 "

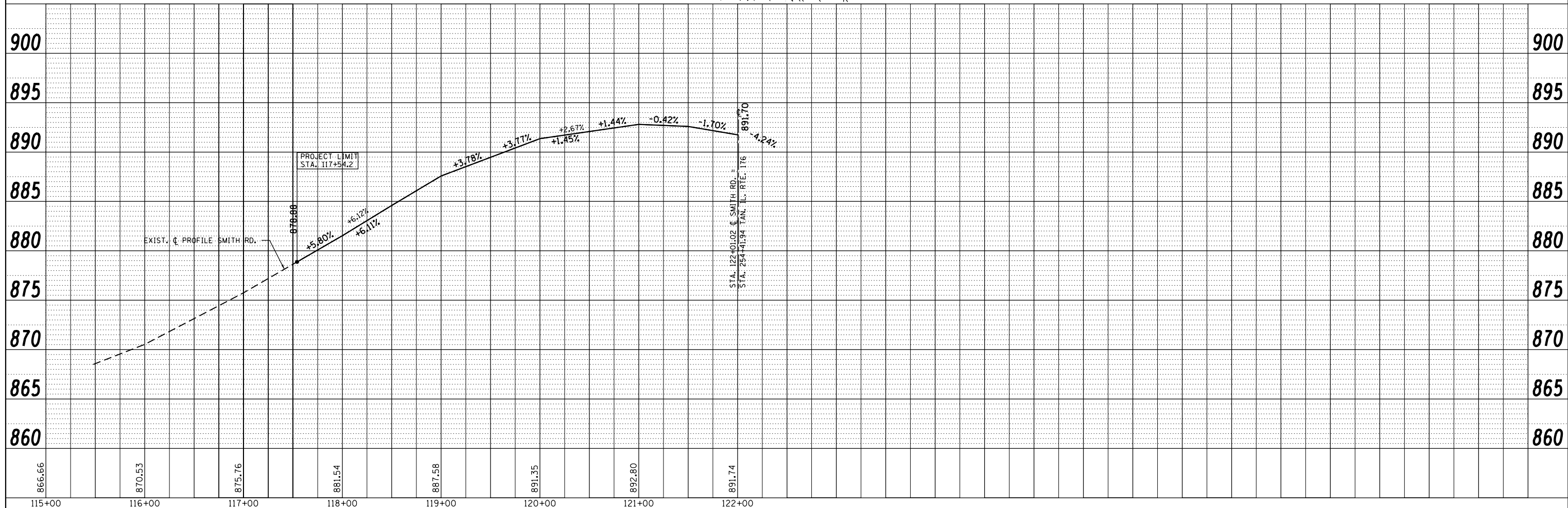

FILE NAME =	USER NAME = obreuh	DESIGNED - J. ERNY	REVISED -
c:\pwork\pwork\obreuh\dms99205\p114205.sht:plnpr.f.dgn		DRAWN - J. ERNY	REVISED -
	PLOT SCALE = 100.0000' / 1"	CHECKED -	REVISED -
	PLOT DATE = 12/12/2012	DATE -	REVISED -

**STATE OF ILLINOIS  
DEPARTMENT OF TRANSPORTATION**

**PROPOSED ROADWAY PLAN & PROFILE  
SMITH RD. AT IL. RTE. 176**

SCALE: 1"=50' SHEET NO. OF SHEETS STA. 115+00 TO STA. 122+00

F.A.P. RTE.	SECTION	COUNTY	TOTAL SHEETS	SHEET NO.
335	146N-2	MCHENRY	65	22
FED. ROAD DIST. NO.			ILLINOIS FED. AID PROJECT	
			CONTRACT NO. 60K20	