

CONCRETE REMOVAL PLAN

Hatched areas indicate Concrete Removal

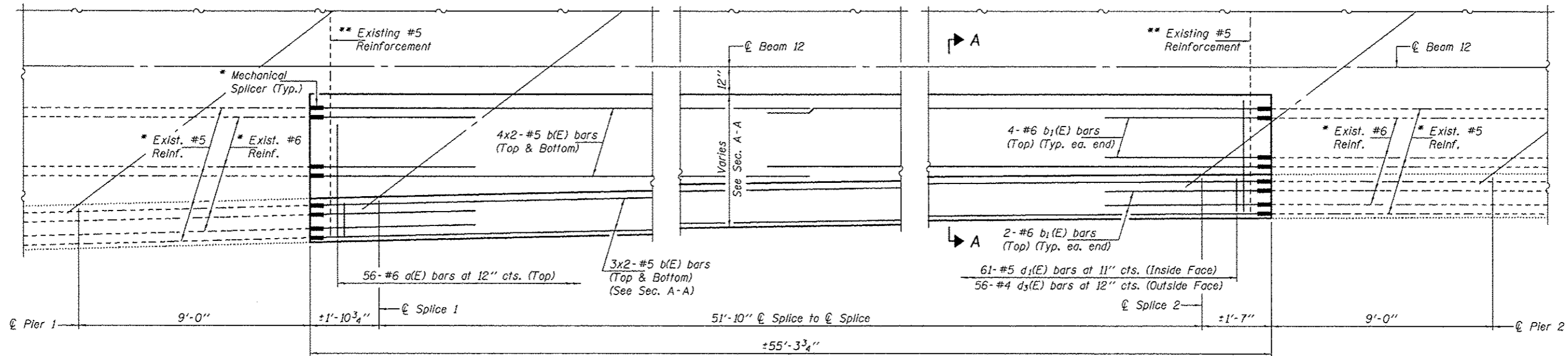

CONCRETE REPLACEMENT PLAN

(Beam 13 not shown for clarity)
For Parapet Reinforcement Details
and Section A-A see sheet 3 of 5.

MIN. BAR LAPS

#5 Bar = 2'-7"

- * Existing reinforcement to extend 6" min. into concrete removal area to facilitate installation of Mechanical Splicers.
- ** Existing reinforcement extending into the removal area shall be cleaned, straightened and incorporated into the new construction. Any reinforcement bars that are damaged during concrete removal shall be replaced with an approved bar splicer or anchorage system. Cost shall be included with Concrete Removal.

DESIGNED - SMR	EXAMINED - <i>Timothy A. [Signature]</i>
CHECKED - VP	PASSED - <i>Carl [Signature]</i>
DRAWN - Kyle M. Steffen	
CHECKED - SMR VP	

DATE - JANUARY 9, 2013	ACTING ENGINEER OF STRUCTURAL SERVICES
	ACTING ENGINEER OF BRIDGES AND STRUCTURES

STATE OF ILLINOIS
DEPARTMENT OF TRANSPORTATION

REPAIR DETAILS	F.A.P. RTE. 352	SECTION 2012-0258R	COUNTY LAKE	TOTAL SHEETS 21	SHEET NO. 12
SN 049-0096			CONTRACT NO. 60T66		
SHEET NO. 2 OF 5 SHEETS					

ILLINOIS FED. AID PROJECT					
---------------------------	--	--	--	--	--