

NOTE 1: INSTALL 3-SECTION BRACKET MOUNT SIGNAL HEADS TO 14 FEET POSTS AS BARREL MOUNTS FOR SOUTHBOUND EXIT RAMP AS SHOWN. THE LOCATION OF THE SIGNAL POSTS MOUNTED IN BARRELS SHALL BE DETERMINED BY THE CONTRACTOR TO CONFORM WITH M.O.T.

NOTE 2: CONTRACTOR SHALL BE REQUIRED TO CONTACT THE ILLINOIS STATE TOLL HIGHWAY AUTHORITY BEFORE ANY WORK CAN BE PERFORMED WITHIN THEIR R.O.W..

LEGEND
 TEMPORARY CONCRETE BARREL WITH POST FOR TRAFFIC SIGNAL HEAD (B)

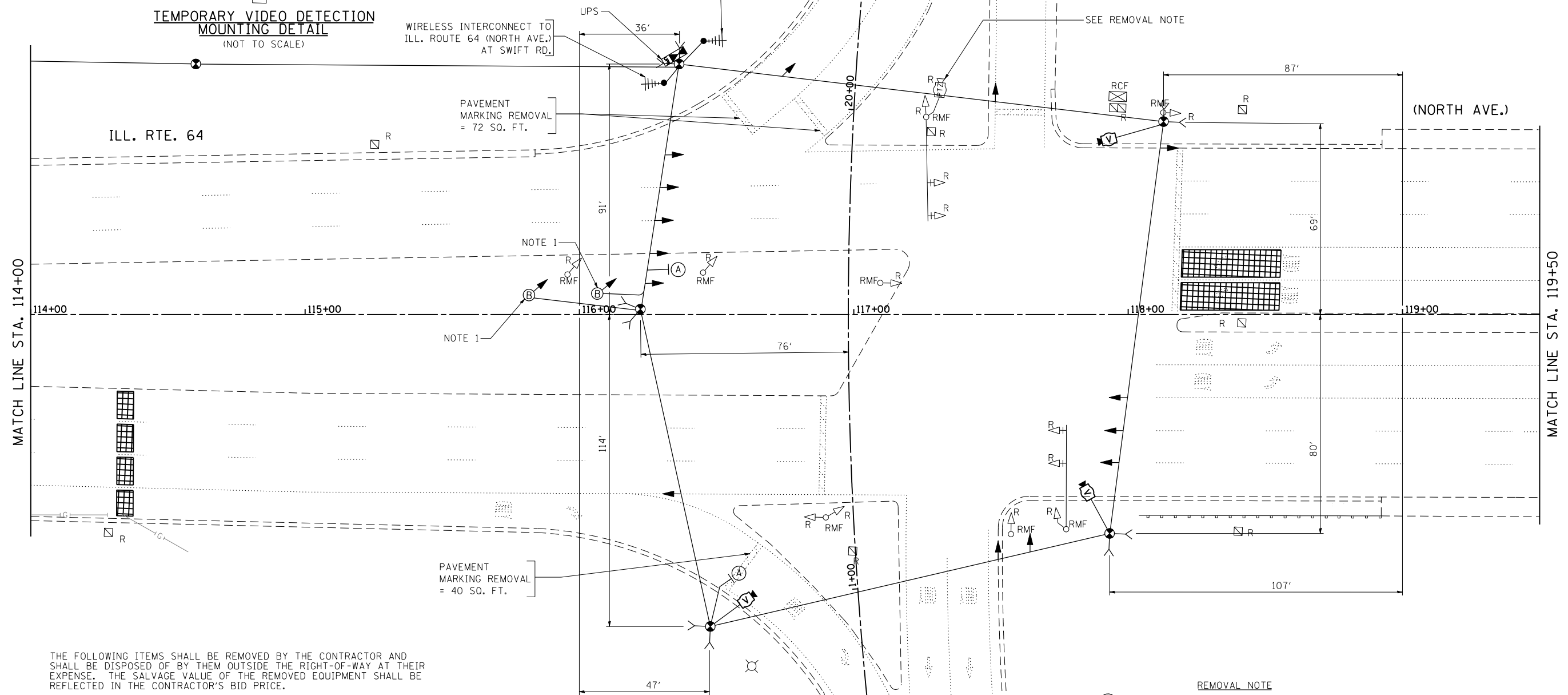
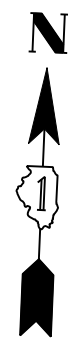

THE FOLLOWING ITEMS SHALL BE REMOVED BY THE CONTRACTOR AND SHALL BE DISPOSED OF BY THEM OUTSIDE THE RIGHT-OF-WAY AT THEIR EXPENSE. THE SALVAGE VALUE OF THE REMOVED EQUIPMENT SHALL BE REFLECTED IN THE CONTRACTOR'S BID PRICE.

- 1 EACH CONTROLLER CABINET AND COMPLETE
- 3 EACH SIGNAL HEAD, 1-FACE, 3-SECTION, MAST-ARM MOUNTED
- 6 EACH SIGNAL HEAD, 1-FACE, 3-SECTION, BRACKET MOUNTED
- 1 EACH SIGNAL HEAD, 1-FACE, 4-SECTION, BRACKET MOUNTED
- 1 EACH SIGNAL HEAD, 1-FACE, 5-SECTION, MAST-ARM MOUNTED
- 1 EACH SIGNAL HEAD, 2-FACE, 1-3 SECTION, 1-5 SECTION, BRACKET MOUNTED
- 4 EACH TRAFFIC SIGNAL BACKPLATE
- 6 EACH TRAFFIC SIGNAL POST
- 2 EACH STEEL MAST ARM ASSEMBLY AND POLE
- 1 EACH SERVICE INSTALLATION

REMOVAL NOTE

THE FOLLOWING EXISTING TRAFFIC SIGNAL EQUIPMENT SHALL BE REMOVED BY THE CONTRACTOR, SHALL REMAIN THE PROPERTY OF THE AGENCY LISTED BELOW. THE CONTRACTOR SHALL SAFELY STORE AND ARRANGE FOR PICK UP OF ALL EQUIPMENT TO BE RETURNED TO THE LISTED AGENCY AS PER THE TRAFFIC SIGNAL SPECIFICATIONS.

AGENCY: ILLINOIS DEPARTMENT OF TRANSPORTATION

CONTACT INFORMATION:
 ILLINOIS DEPARTMENT OF TRANSPORTATION
 ENGINEERING DEPARTMENT

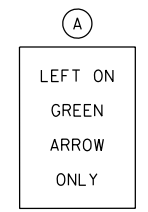

R10-5, 30" X 36"
 (2 REQUIRED)

1 EACH SURVEILLANCE CAMERA

THE TRAFFIC SIGNAL CONTROL EQUIPMENT FOR THIS PROJECT SHALL BE "ECONOLITE" TO MATCH THE EXISTING ADJACENT SYSTEM.