

NOTE 1: INSTALL 3-SECTION BRACKET MOUNT SIGNAL HEADS TO 14 FEET POSTS AS BARREL MOUNTS FOR NORTHBOUND EXIT RAMP AS SHOWN. THE LOCATION OF THE SIGNAL POSTS MOUNTED IN BARRELS SHALL BE DETERMINED BY THE CONTRACTOR TO CONFORM WITH M.O.T.

NOTE 2: CONTRACTOR SHALL BE REQUIRED TO CONTACT THE ILLINOIS STATE TOLL HIGHWAY AUTHORITY BEFORE ANY WORK CAN BE PERFORMED WITHIN THEIR R.O.W..

NOTE 3: PROVIDE A "T" OR "Y" SHAPED CONDUIT FITTING IN THE TELEPHONE CONDUIT CLOSE TO PROPOSED CONTROLLER LOCATION AS SHOWN IN THE PLAN AND CAP THE PORTION OF THE FITTING LEADING TOWARDS PROPOSED CONTROLLER FOR USE IN PROPOSED TRAFFIC SIGNAL INSTALLATION. THE TELEPHONE SERVICE CABLE SHALL BE RE-ROUTED TO THE NEW CONTROLLER WHEN NEEDED. THIS WORK WILL NOT BE PAID FOR SEPARATELY BUT SHALL BE INCIDENTAL TO PAY ITEM "MASTER CONTROLLER, SPECIAL".

NOTE 4: AN ADDITIONAL 2" CONDUIT SHALL BE INSTALLED IN THE FOUNDATION FOR GROUND MOUNTED SERVICE CABINET, TO PROVIDE CONNECTION TO THE FOUNDATION FOR THE NEW CONTROLLER AND CABINET AS SHOWN IN THE PLANS. THIS ADDITIONAL CONDUIT SHALL BE CAPPED UNTIL NEEDED FOR PROPOSED SERVICE FOR NEW CONTROLLER.

NOTE 5: THE SERVICE INSTALLATION, HANDHOLES, CONDUITS, AND CABLES INSTALLED FOR SERVICE INSTALLATION AND FOR TELEPHONE SERVICE CONNECTION FOR TEMPORARY TRAFFIC SIGNAL INSTALLATION SHALL ALSO BE RE-USED FOR PROPOSED PERMANENT TRAFFIC SIGNAL INSTALLATION. THESE ITEMS ARE INCLUDED IN THE QUANTITIES FOR THE PROPOSED PERMANENT TRAFFIC SIGNAL FOR ILLINOIS ROUTE 64 AT EAST RAMP AND SHALL BE PAID FOR AS SHOWN IN THE QUANTITIES.

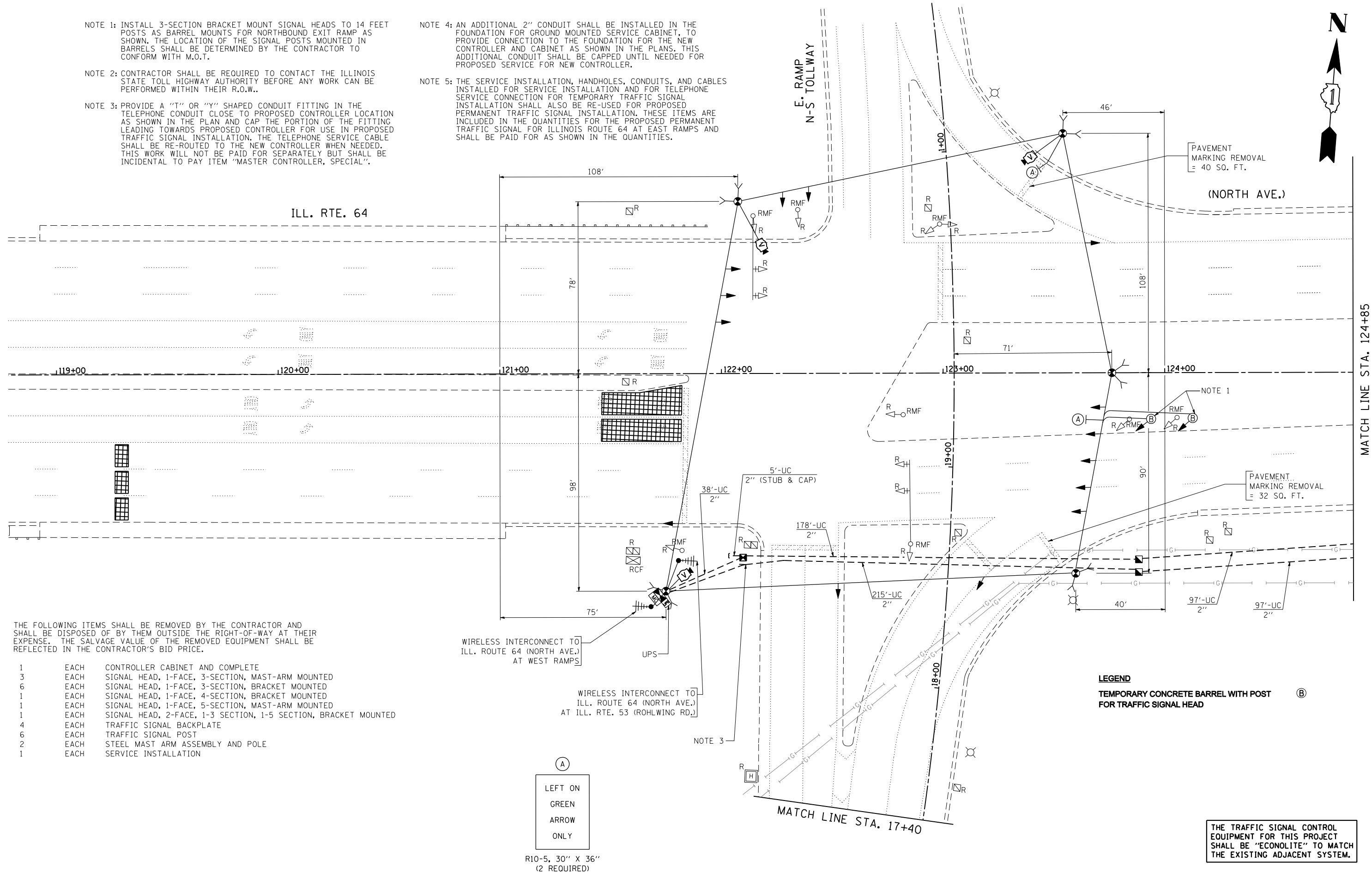

THE FOLLOWING ITEMS SHALL BE REMOVED BY THE CONTRACTOR AND SHALL BE DISPOSED OF BY THEM OUTSIDE THE RIGHT-OF-WAY AT THEIR EXPENSE. THE SALVAGE VALUE OF THE REMOVED EQUIPMENT SHALL BE REFLECTED IN THE CONTRACTOR'S BID PRICE.

- 1 EACH CONTROLLER CABINET AND COMPLETE
- 3 EACH SIGNAL HEAD, 1-FACE, 3-SECTION, MAST-ARM MOUNTED
- 6 EACH SIGNAL HEAD, 1-FACE, 3-SECTION, BRACKET MOUNTED
- 1 EACH SIGNAL HEAD, 1-FACE, 4-SECTION, BRACKET MOUNTED
- 1 EACH SIGNAL HEAD, 1-FACE, 5-SECTION, MAST-ARM MOUNTED
- 1 EACH SIGNAL HEAD, 2-FACE, 1-3 SECTION, 1-5 SECTION, BRACKET MOUNTED
- 4 EACH TRAFFIC SIGNAL BACKPLATE
- 6 EACH TRAFFIC SIGNAL POST
- 2 EACH STEEL MAST ARM ASSEMBLY AND POLE
- 1 EACH SERVICE INSTALLATION

WIRELESS INTERCONNECT TO ILL. ROUTE 64 (NORTH AVE.) AT WEST RAMPS

UPS

WIRELESS INTERCONNECT TO ILL. ROUTE 64 (NORTH AVE.) AT ILL. RTE. 53 (ROHLWING RD.)

(A)

LEFT ON GREEN ARROW ONLY

R10-5, 30" X 36" (2 REQUIRED)

LEGEND

TEMPORARY CONCRETE BARREL WITH POST FOR TRAFFIC SIGNAL HEAD (B)

THE TRAFFIC SIGNAL CONTROL EQUIPMENT FOR THIS PROJECT SHALL BE "ECONOLITE" TO MATCH THE EXISTING ADJACENT SYSTEM.

FILE NAME =	USER NAME = *USER*	DESIGNED - PKG	REVISED -	<b>STATE OF ILLINOIS DEPARTMENT OF TRANSPORTATION</b>	<b>TEMPORARY TRAFFIC SIGNAL INSTALLATION PLAN AND REMOVAL PLAN ILLINOIS ROUTE 64 (NORTH AVENUE) AT EAST RAMPS (SHEET 1 OF 2)</b>			F.A.P. RTE. 307	SECTION 2012-029-TS	COUNTY DuPAGE	TOTAL SHEETS 55	SHEET NO. 36	
*FILEL*		DRAWN - EA, MG	REVISED -		SCALE: 1"=20'	SHEET NO. OF SHEETS	STA. TO STA.	CONTRACT NO. 60T80		FED. ROAD DIST. NO. - ILLINOIS FED. AID PROJECT			
		CHECKED - PKG	REVISED -										
		DATE - 12/7/2012	REVISED -										