

STATE OF ILLINOIS
DEPARTMENT OF TRANSPORTATION
DIVISION OF HIGHWAYS

**PROPOSED
HIGHWAY PLANS**

FAP ROUTE 330 (WILLOW ROAD)
SECTION 2012-068 I
EB & WB RAMPS OVER DES PLAINES RIVER
SCOUR COUNTERMEASURES (RIP RAP)
COOK COUNTY
C-91-063-13

F.A.P. RTE.	SECTION	COUNTY	TOTAL SHEETS	SHEET NO.
330	2012-068 I	COOK	15	1
ILLINOIS			CONTRACT NO. 60V73	

FOR INDEX OF SHEETS, SEE SHEET NO. 2

TRAFFIC DATA:

WILLOW ROAD
EXISTING ADT (2012) = 5,100 - 7,500
SPEED LIMIT = 40 MPH

THIS PROJECT IS LOCATED IN THE UNINCORPORATED NORTHFIELD TOWNSHIP.

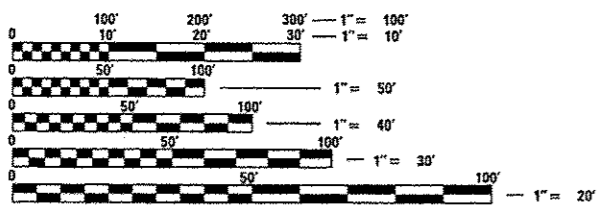

FULL SIZE PLANS HAVE BEEN PREPARED USING STANDARD ENGINEERING SCALES. REDUCED SIZED PLANS WILL NOT CONFORM TO STANDARD SCALES. IN MAKING MEASUREMENTS ON REDUCED PLANS, THE ABOVE SCALES MAY BE USED.

J.U.L.I.E.
JOINT UTILITY LOCATION INFORMATION FOR EXCAVATION
1-800-892-0123
OR 811

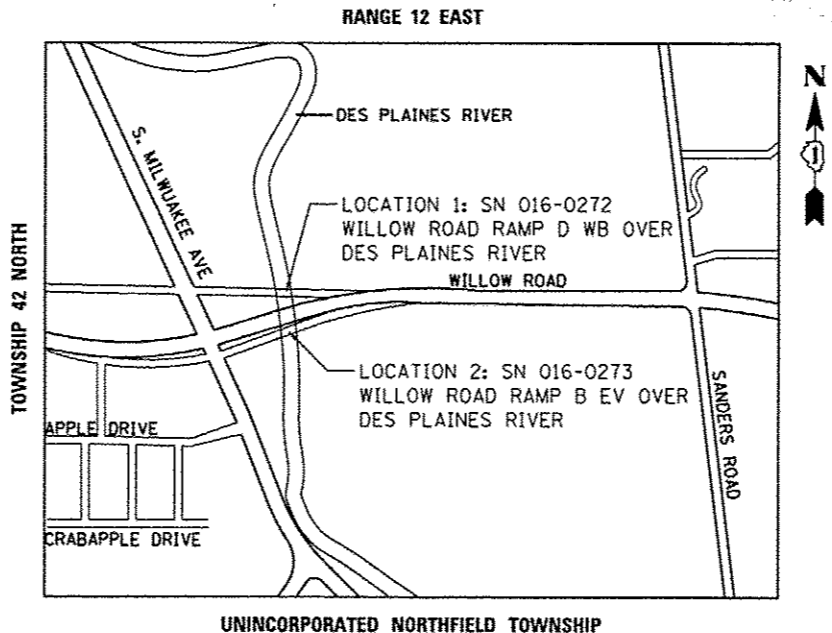

PROJECT ENGINEER: PETER JOHNSTON (GRAEF) 773-399-0112
PROJECT MANAGER: KEN ENG (IDOT) 847-705-4247

CONTRACT NO. 60V73

GRAEF 8501 W. Higgins Road, Suite 280
Chicago, Illinois 60631
(773) 399-0112

PROFESSIONAL ENGINEER'S SIGN & SEAL
Peter M. Johnston
062-047647 REGISTERED PROFESSIONAL ENGINEER OF ILLINOIS
EXPIRES: 11/30/13

STATE OF ILLINOIS
DEPARTMENT OF TRANSPORTATION
DIVISION OF HIGHWAYS
SUBMITTED December 11 20 12
John F. Johnson
DEPUTY DIRECTOR OF HIGHWAYS, REGIONAL ENGINEER
Feb 1 20 13
John D. Baranzelli, P.E.
actg. ENGINEER OF DESIGN AND ENVIRONMENT
Feb 9 20 13
Omer Osman, P.E.
DIRECTOR OF HIGHWAYS, CHIEF ENGINEER

PRINTED BY THE AUTHORITY OF THE STATE OF ILLINOIS

INDEX OF SHEETS

SHEET NO.	DESCRIPTION
1	COVER SHEET
2	INDEX, HIGHWAY STANDARDS, AND GENERAL NOTES
3	SUMMARY OF QUANTITIES
4	LOCATION MAP
5	SN 016-0272 WILLOW ROAD RAMP D OVER DES PLAINES RIVER - SITE PLAN
6	SN 016-0272 WILLOW ROAD RAMP D OVER DES PLAINES RIVER
7	SN 016-0272 WILLOW ROAD RAMP D OVER DES PLAINES RIVER - CROSS SECTIONS
8	SN 016-0273 WILLOW ROAD RAMP B OVER DES PLAINES RIVER - SITE PLAN
9	SN 016-0273 WILLOW ROAD RAMP B OVER DES PLAINES RIVER
10	SN 016-0273 WILLOW ROAD RAMP B OVER DES PLAINES RIVER - CROSS SECTIONS
11-13	DEWATERING SYSTEM DETAILS
14	TRAFFIC CONTROL AND PROTECTION FOR SIDE ROADS, INTERSECTIONS, AND DRIVEWAYS (TC 10)
15	ARTERIAL ROAD INFORMATION SIGNING (TC22)

HIGHWAY STANDARDS

STD. NO.	TITLE
701101-03	OFF-ROAD OPERATIONS, MULTILANE, 15' (4.5 m) TO 24" (600 mm) FROM PAVEMENT EDGE
701601-08	URBAN LANE CLOSURE MULTILANE, 1W OR 2W WITH NONTRAVERSABLE MEDIAN
701901-02	TRAFFIC CONTROL DEVICES

GENERAL NOTES

- BEFORE STARTING ANY EXCAVATION, THE CONTRACTOR SHALL CALL "JULIE" (JOINT UTILITY LOCATION INFORMATION FOR EXCAVATION) AT 8-1-1 OR (800) 892-0123 FOR FIELD LOCATIONS OF BURIED ELECTRIC, TELEPHONE, AND GAS FACILITIES (48 HOUR NOTIFICATION IS REQUIRED).
- THE CONTRACTOR WILL NOT BE ALLOWED TO SET UP A YARD OR FIELD OFFICE ON STATE PROPERTY WITHOUT WRITTEN PERMISSION FROM THE DEPARTMENT.
- ALL PERMITS AND FEES NEEDED TO OBTAIN ACCESS TO VARIOUS LOCATIONS FROM VILLAGE LAND OR FOREST PRESERVE WILL BE THE RESPONSIBILITY OF THE CONTRACTOR AND INCIDENTAL TO THE COST OF THE STONE RIPRAP.
- EXCAVATION INTO THE STREAM BED FOR STONE RIPRAP INSTALLATION SHALL NOT BE DEEPER THAN THE BOTTOM OF THE FOOTING ON THE PIER OR ABUTMENT TO BE PROTECTED.
- DEBRIS REMOVAL, IF ENCOUNTERED, SHALL BE INCLUDED IN THE COST OF THE STONE RIPRAP.
- IT SHALL BE THE CONTRACTORS RESPONSIBILITY TO VERIFY ALL DIMENSIONS & CONDITIONS EXISTING IN THE FIELD PRIOR TO CONSTRUCTION ORDERING OF MATERIAL.
- THE CONTRACTOR SHALL CONTACT THE DISTRICT ONE ARTERIAL TRAFFIC CONTROL SUPERVISOR AT (847) 705-4470 A MINIMUM OF 72 HOURS IN ADVANCE OF BEGINNING WORK.
- ALL AREAS (INCLUDING WETLAND AREAS) OUTSIDE THE LIMITS OF RIPRAP PLACEMENT AND/OR EXCAVATION WHICH ARE DISTURBED (WHERE EXISTING SOIL CONTOURS HAVE BEEN ALTERED AND/OR EXISTING VEGETATION HAD BEEN DESTROYED BY THE CONTRACTORS OPERATIONS) SHALL BE RESTORED BY REGRADING TO THE ORIGINAL CONTOURS AND/OR SEEDING WITH SEEDING, CLASS 4, AND MULCHING WITH EROSION CONTROL BLANKETS. PLACE TEMPORARY SEEDING AND TEMPORARY EROSION CONTROL BLANKETS AS NEEDED. THIS WORK WILL NOT BE PAID FOR SEPARATELY, BUT THE COSTS SHALL BE CONSIDERED INCLUDED IN THE CONTRACT UNIT PRICES FOR THE CONSTRUCTION ITEMS INVOLVED, AND NO ADDITIONAL COMPENSATION WILL BE ALLOWED.
- ANY BRUSH AND TREE REMOVAL TO GET ACCESS SHOULD BE INCIDENTAL TO THE COST OF THE STONE RIPRAP.
- THE CONTRACTOR IS ADVISED TO AVOID OR MINIMIZE ANY DISTURBANCE TO EXISTING VEGETATION OUTSIDE THE LIMITS OF RIPRAP PLACEMENT AND CHANNEL EXCAVATION.
- THE CONTRACTOR MUST PROTECT PAVEMENT WHEN DUMPING RIPRAP ONTO PAVEMENT AND WILL BE RESPONSIBLE FOR RESTORING PAVEMENT MARKINGS AND RAISED REFLECTIVE PAVEMENT MARKERS.
- ANY GUARDRAIL OR SIGNS DAMAGED BY THE CONTRACTORS OPERATIONS SHALL BE REPLACED IN KIND AT THE CONTRACTORS EXPENSE.
- THE CONTRACTOR SHALL BE REQUIRED TO PROVIDE ACCESS TO ABUTTING PROPERTY AT ALL TIMES DURING THE CONSTRUCTION OF THIS PROJECT.
- DO NOT SCALE PLANS FOR CONSTRUCTION DIMENSIONS.
- THE CONTRACTOR SHALL COMPLETE ALL WORK OVER THE SIDE OF THE BRIDGE USING DAYTIME LANE CLOSURES ONLY. NO OVERNIGHT LANE CLOSURES WILL BE ALLOWED WHEN THE CONTRACTOR IS NOT WORKING.
- THE CONTRACTOR SHALL SUBMIT DEWATERING AND SEDIMENT CONTROL PLANS FOR EACH SITE TO THE ENGINEER FOR APPROVAL.
- THE CONTRACTOR SHALL CONTACT THE ENGINEER AFTER DEWATERING FOR FINAL RIPRAP PLACEMENT.
- UNLESS OTHERWISE NOTED, EXCAVATION OF MATERIAL REQUIRED TO INSTALL STONE RIPRAP SHALL BE INCLUDED IN THE ITEM BEING INSTALLED.
- THIS PROJECT REQUIRES A US ARMY CORPS OF ENGINEERS (USACE) 404 PERMIT THAT WILL BE SECURED BY THE DEPARTMENT. AS A CONDITION OF THIS PERMIT, THE CONTRACTOR WILL NEED TO SUBMIT AN IN-STREAM WORK PLAN TO THE DEPARTMENT FOR APPROVAL. GUIDELINES ON ACCEPTABLE IN-STREAM WORK TECHNIQUES CAN BE FOUND ON THE USACE WEBSITE. THE USACE DEFINES AND DETERMINES IN-STREAM WORK. THE COST OF ALL MATERIALS AND LABOR NECESSARY TO COMPLY WITH THE ABOVE PROVISIONS TO PREPARE AND IMPLEMENT AN IN-STREAM WORK PLAN WILL NOT BE PAID FOR SEPARATELY, BUT SHALL BE CONSIDERED AS INCLUDED IN THE UNIT BID PRICES OF THE CONTRACT AND NO ADDITIONAL COMPENSATION WILL BE ALLOWED.
- DIRECTION INDICATOR BARRICADES SHALL BE EXCLUSIVELY USED IN ALL LANE CLOSURE TAPERS. CONES, DRUMS, TYPE I, TYPE II BARRICADES, OR VERTICAL BARRICADES WILL NOT BE ALLOWED TO BE USED IN LANE CLOSURE TAPERS. NO ADDITIONAL COMPENSATION WILL BE ALLOWED, AND THE COST SHALL BE CONSIDERED INCIDENTAL TO THE TEMPORARY TRAFFIC CONTROL, STANDARD 701601 PAY ITEM.

PAY ITEM NUMBER	DESCRIPTION	UNIT	URBAN 100% STATE TOTAL QUANTITY	LOCATION 1 SN 016-0272 0014	LOCATION 2 SN 016-0273 0014
20300100	CHANNEL EXCAVATION	CU YD	200	115	85
28100109	STONE RIPRAP, CLASS A5	SQ YD	736	460	276
28200200	FILTER FABRIC	SQ YD	433	273	160
67000400	ENGINEER'S FIELD OFFICE, TYPE A	CAL MO	6	3	3
67100100	MOBILIZATION	L SUM	1	0.50	0.50
70102630	TRAFFIC CONTROL AND PROTECTION, STANDARD 701601	L SUM	1	0.50	0.50
X0301852	DEWATERING STRUCTURE NO. 1	EACH	1	1	
X0301853	DEWATERING STRUCTURE NO. 2	EACH	1		1
Z0030850	TEMPORARY INFORMATION SIGNING	SQ FT	102	51	51

• DENOTES SPECIALTY ITEM

 8501 W. Higgins Road Suite 280 Chicago, Illinois 60631 (773) 359-0112	USER NAME • 1485	DESIGNED -	REVISED -	STATE OF ILLINOIS DEPARTMENT OF TRANSPORTATION	WILLOW ROAD OVER DES PLAINES RIVER RIPRAP IMPROVEMENTS SUMMARY OF QUANTITIES	F.A.P. RTE.	SECTION	COUNTY	TOTAL SHEETS	SHEET NO.
	PLOT SCALE • 48.0000' / 1" =	CHECKED -	REVISED -			330	2012-068 1	COOK	15	3
	PLOT DATE • 12/11/2012	DATE - 12-20-2012	REVISED -			SCALE: SHEET 1 OF 1 SHEETS STA. TO STA.		ILLINOIS FED. AID PROJECT CONTRACT NO. 60V73		

Rev.

TRAFFIC DATA
EXISTING ADT = 7,500
SPEED LIMIT = 40 MPH

R. 12 E.

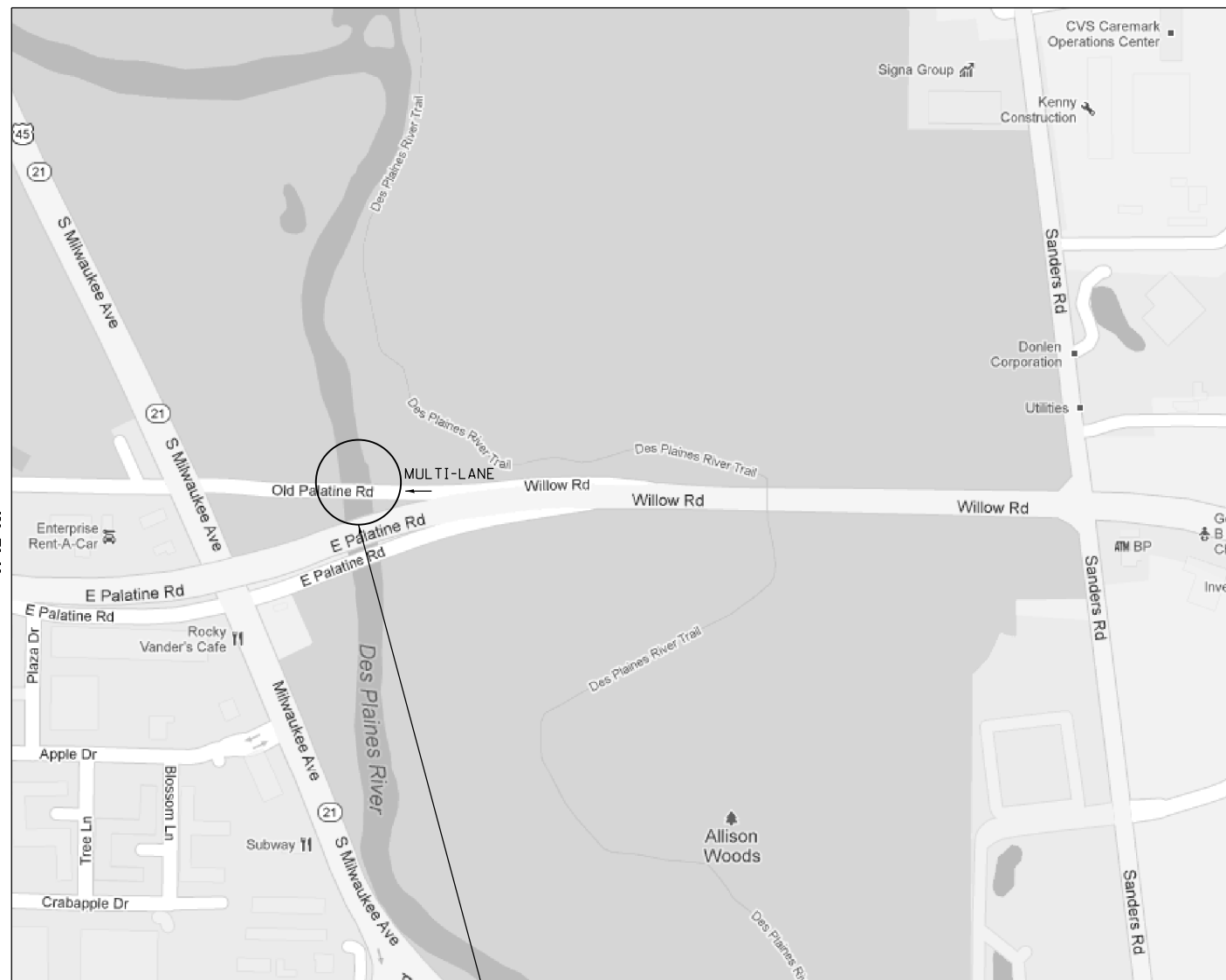

LOCATION 1
WILLOW ROAD WB RAMP
OVER DES PLAINES RIVER
0. MILES EAST OF S. MILWAUKEE AVE.
SN 016-0272
UNINCORPORATED NORTHFIELD TWP (EO PROSPECT HEIGHTS)

TRAFFIC DATA
EXISTING ADT = 5,100
SPEED LIMIT = 40 MPH

R. 12 E.

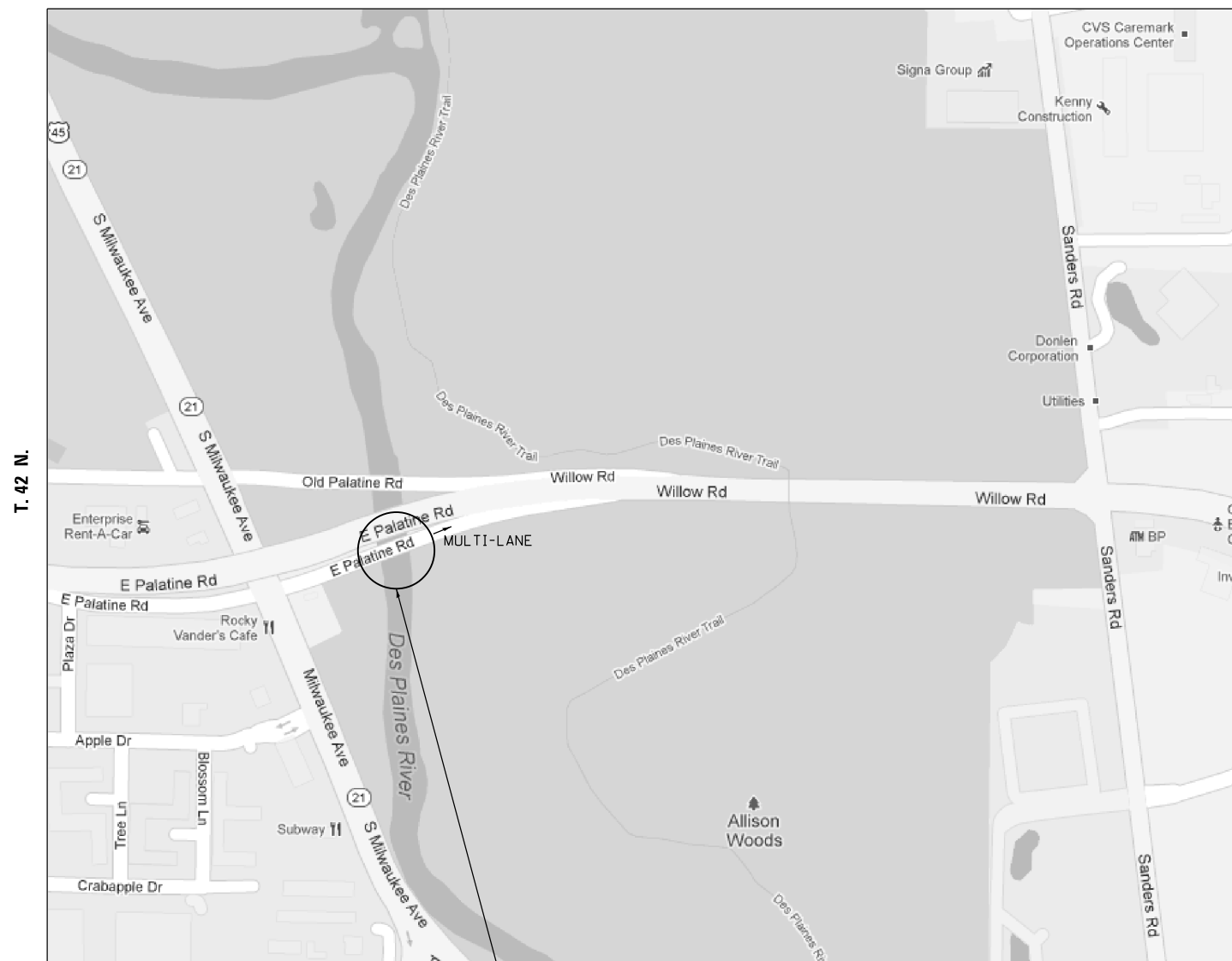

LOCATION 2
WILLOW ROAD EB RAMP
OVER DES PLAINES RIVER
0. MILES EAST OF S. MILWAUKEE AVE.
SN 016-0273
UNINCORPORATED NORTHFIELD TWP (EO PROSPECT HEIGHTS)

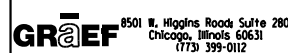

USER NAME = 1485	DESIGNED -	REVISED -
DRAWN -	REVISED -	
PLOT SCALE = 48.0000' / in.	CHECKED -	REVISED -
PLOT DATE = 12/11/2012	DATE - 12-20-2012	REVISED -

STATE OF ILLINOIS
DEPARTMENT OF TRANSPORTATION

WILLOW ROAD OVER DES PLAINES RIVER RIPRAP IMPROVEMENTS
LOCATION MAP

SCALE: SHEET 1 OF 1 SHEETS STA. TO STA.

F.A.P. RTE.	SECTION	COUNTY	TOTAL SHEETS	SHEET NO.
330	2012-068 I	COOK	15	4
CONTRACT NO. 60V73				
ILLINOIS FED. AID PROJECT				

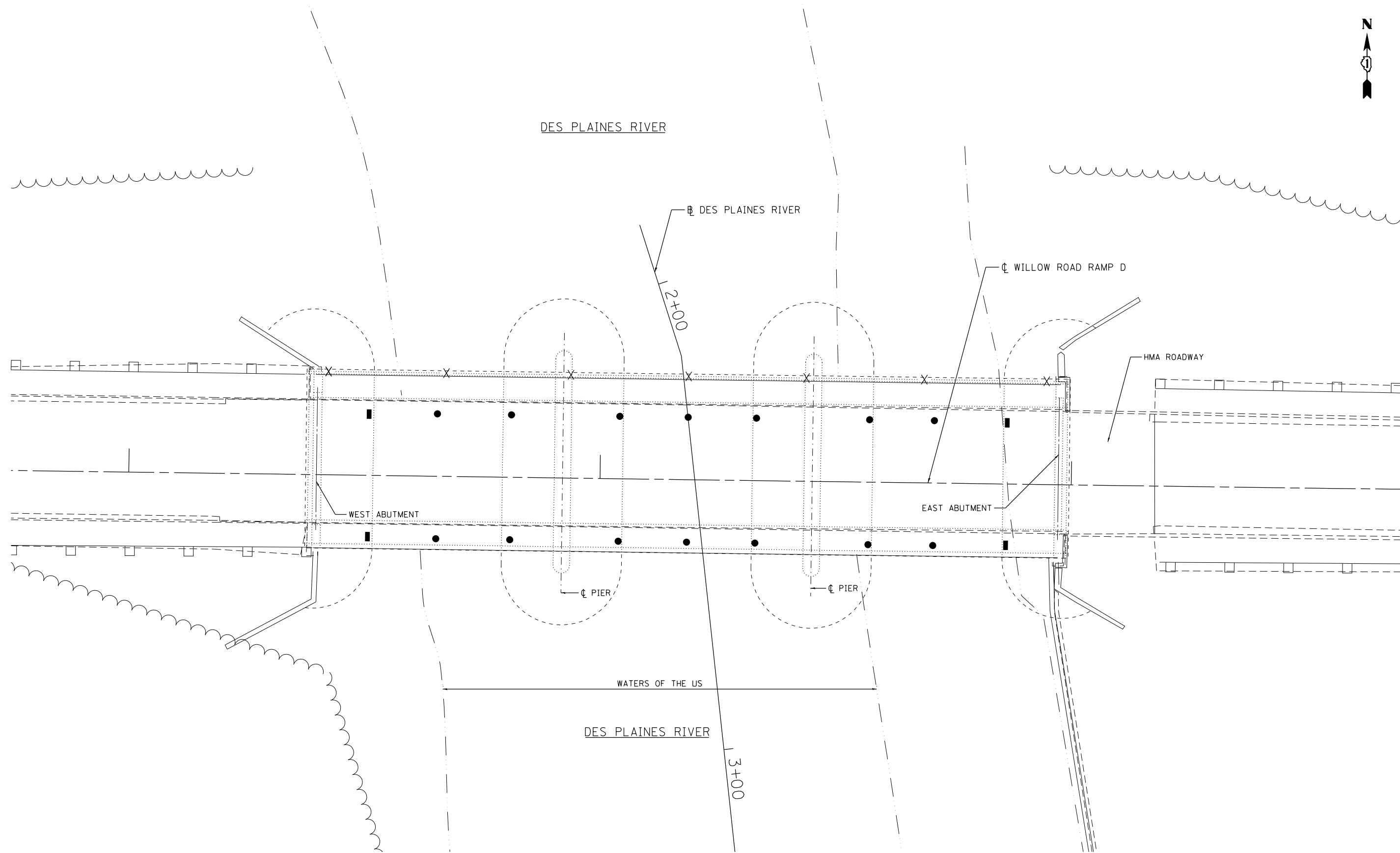

GRAEF 8501 N. Higgins Road Suite 280
Chicago, Illinois 60631
(773) 399-0112

USER NAME = 1485	DESIGNED -	REVISED -
	DRAWN -	REVISED -
PLOT SCALE = 20.0000' / in.	CHECKED -	REVISED -
PLOT DATE = 12/11/2012	DATE - 12-20-2012	REVISED -

**STATE OF ILLINOIS
DEPARTMENT OF TRANSPORTATION**

**WILLOW ROAD OVER DES PLAINES RIVER RIPRAP IMPROVEMENTS
RAMP D SN 016-0272 - SITE PLAN**

SCALE: 1"=10' SHEET 1 OF 1 SHEETS STA. 25+75.00 TO STA. 28+70.00

F.A.P. RTE.	SECTION	COUNTY	TOTAL SHEETS	SHEET NO.
330	2012-068 I	COOK	15	5
CONTRACT NO. 60V73				
ILLINOIS FED. AID PROJECT				

LEGEND

-  STONE RIPRAP, CLASS A5 (2.5' THICK) TYP.
- TBM #1 - "□" ON TOP NORTHEASTERLY CORNER OF EAST ABUTMENT ON THE WEST BOUND RAMP EL. = 644.15'
- TBM #2 - FOUND "□" ON TOP SOUTHEASTERLY CORNER OF THE EAST ABUTMENT ON WEST BOUND RAMP EL. = 644.25'

ACCESS TO THIS SITE IS LIMITED. THE CONTRACTOR SHALL ONLY ACCESS THIS SITE BY RAISING AND/OR LOWERING ALL EQUIPMENT AND MATERIAL OVER THE SIDES OF THE BRIDGE. THE CONTRACTOR WILL NOT BE ALLOWED OTHER ACCESS WITHOUT WRITTEN PERMISSION FROM THE ENGINEER. THIS WORK WILL NOT BE PAID FOR SEPARATELY, BUT SHALL BE CONSIDERED AS INCLUDED IN THE CONTRACT UNIT PRICES FOR THE CONSTRUCTION ITEMS INVOLVED AND NO ADDITIONAL COMPENSATION WILL BE ALLOWED.

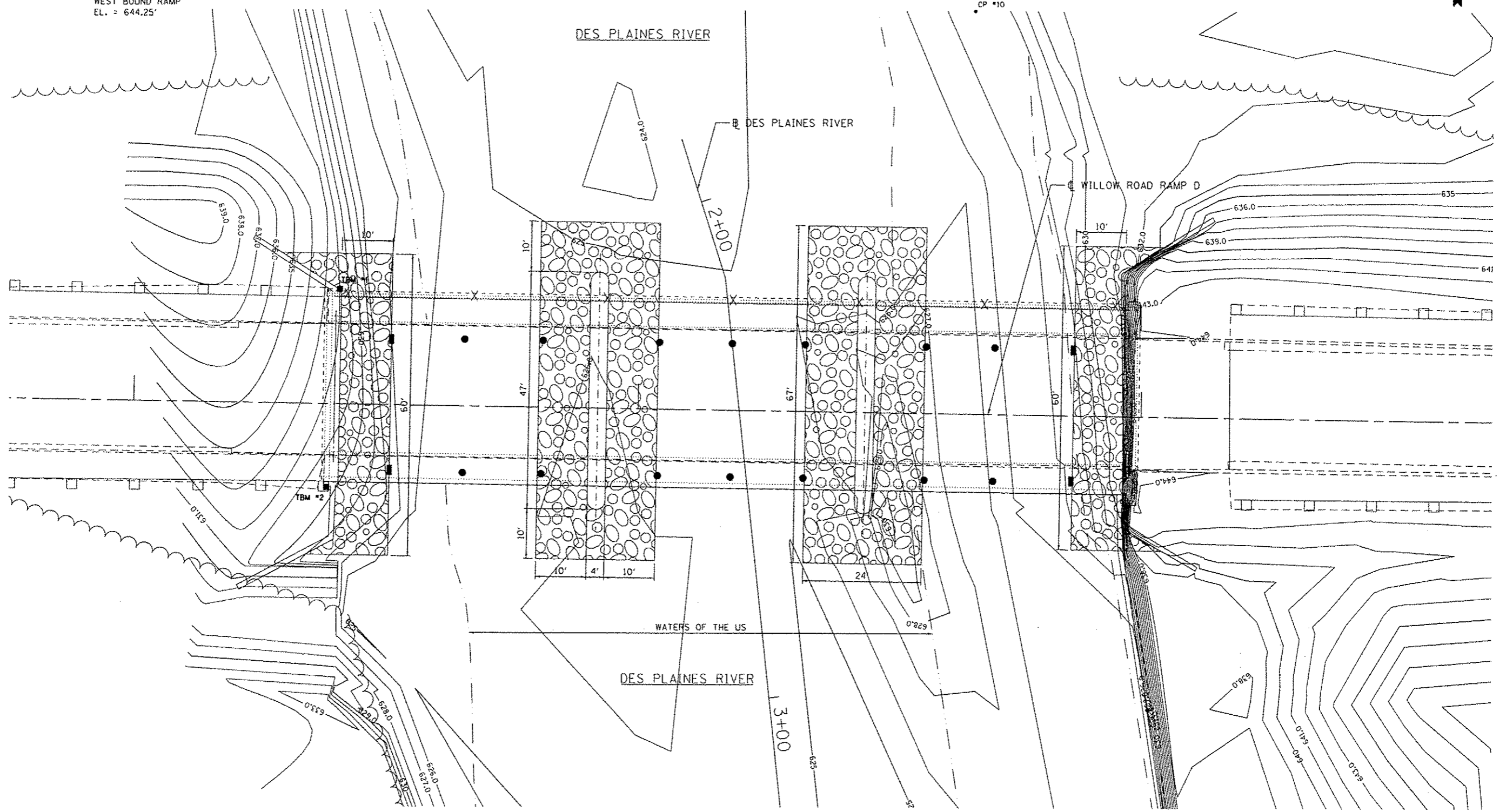

GRAEF 8501 N. Higgins Road, Suite 200
Chicago, Illinois 60631
(773) 399-0112

USER NAME * 1485	DESIGNED -	REVISED -
PLOT SCALE * 28,0000 "/ in.	DRAWN -	REVISED -
PLOT DATE * 1/25/2013	CHECKED -	REVISED -
	DATE - 12-20-2012	REVISED -

**STATE OF ILLINOIS
DEPARTMENT OF TRANSPORTATION**

**WILLOW ROAD OVER DES PLAINES RIVER RIPRAP IMPROVEMENTS
RAMP D SN 016-0272**

SCALE: 1"=10' SHEET 1 OF 1 SHEETS STA. 25+75.00 TO STA. 28+70.00

F.A.P. RTE. 330	SECTION 2012-068 1	COUNTY COOK	TOTAL SHEETS 15	SHEET NO. 6
CONTRACT NO. 60V73			ILLINOIS FED. AID PROJECT	

DATE	
BY	
REVISED	
PLOTTED	
TEMPLATE	
AREAS	
CHECKED	
FINAL	
NOTE BOOK	
NO.	

DATE	
BY	
REVISED	
PLOTTED	
TEMPLATE	
AREAS	
CHECKED	
ORIGINAL	
NOTE BOOK	
NO.	

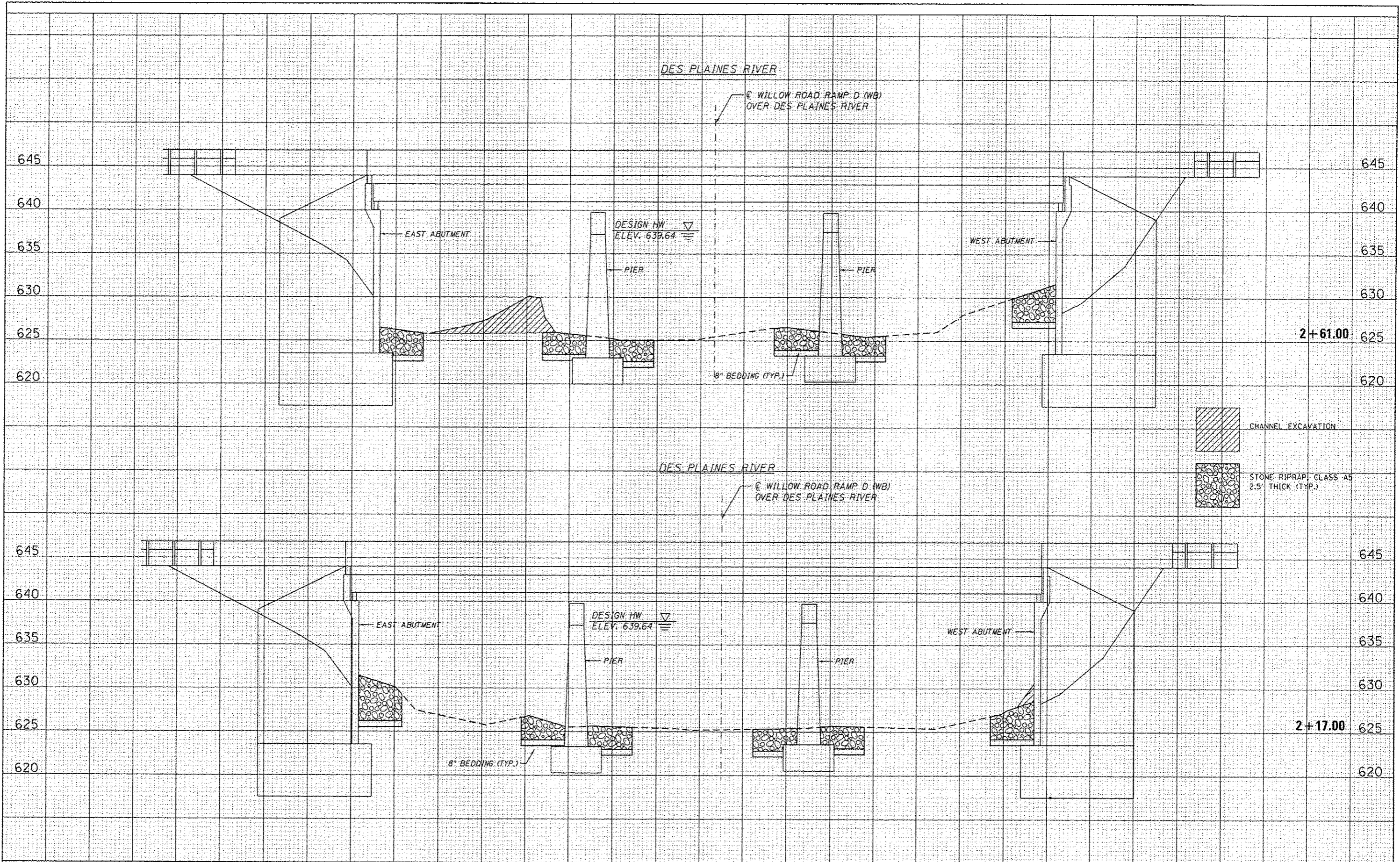

GRÖEF 6501 W. Higgins Road, Suite 200 Chicago, Illinois 60631 (773) 399-0112	USER NAME = 1405	DESIGNED -	REVISED -	STATE OF ILLINOIS DEPARTMENT OF TRANSPORTATION	WILLOW ROAD RIP RAP IMPROVEMENTS - CROSS SECTIONS RAMP D SN 016-0272	F.A.P. RTE. 330	SECTION 2012-068 I	COUNTY COOK	TOTAL SHEETS 16	SHEET NO. 7
	PLOT SCALE = 20,0000 / 1"	CHECKED -	REVISED -			CONTRACT NO. 60V73				
	PLOT DATE = 1/25/2013	DATE -	REVISED -			ILLINOIS FED. AID PROJECT				
	SCALE: SHEET 1 OF 1 SHEETS STA. TO STA.									

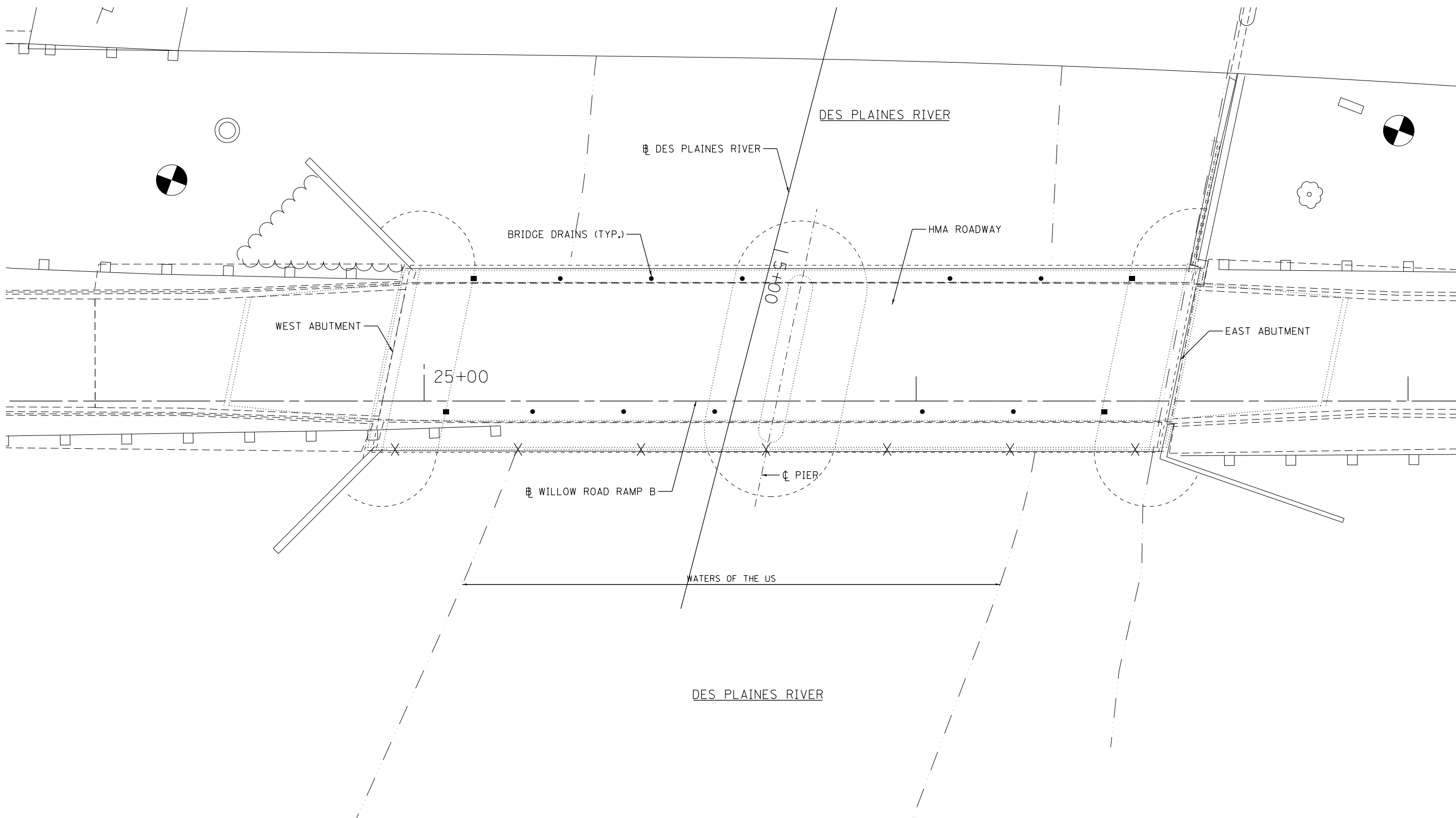

GRAEF 8501 W. Higgins Road Suite 280
Chicago, Illinois 60631
(773) 399-0112

USER NAME = 1485	DESIGNED -	REVISED -
	DRAWN -	REVISED -
PLOT SCALE = 20.0000' / in.	CHECKED -	REVISED -
PLOT DATE = 12/11/2012	DATE - 12-20-2012	REVISED -

**STATE OF ILLINOIS
DEPARTMENT OF TRANSPORTATION**

**WILLOW ROAD OVER DES PLAINES RIVER RIPRAP IMPROVEMENTS
RAMP B SN 016-0273 - SITE PLAN**

SCALE: 1"=10' SHEET 1 OF 1 SHEETS STA. 24+15 TO STA. 27+10

F.A.P. RTE.	SECTION	COUNTY	TOTAL SHEETS	SHEET NO.
330	2012-068 I	COOK	15	8
CONTRACT NO. 60V73				
ILLINOIS FED. AID PROJECT				

LEGEND

 STONE RIPRAP, CLASS A5 - 2.5' THICK (TYP.)

TBM "B" - FOUND "□" AT SOUTHEASTERLY CORNER OF THE EAST ABUTMENT ON EAST BOUND RAMP
EL. = 645.25'

TBM "C" - FOUND "□" AT NORTHEASTERLY CORNER OF THE EAST ABUTMENT ON EAST BOUND RAMP
EL. = 645.21'

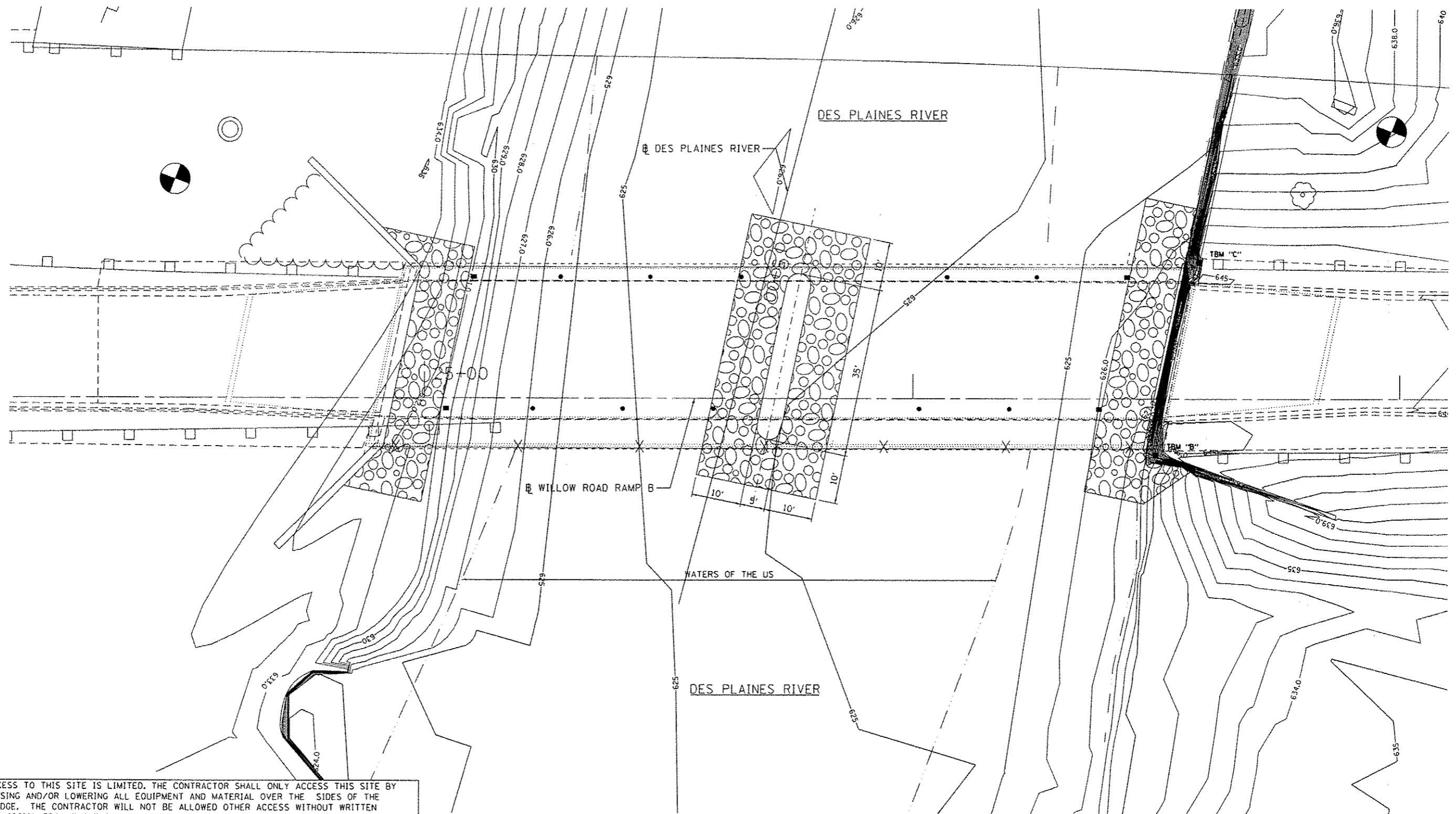

ACCESS TO THIS SITE IS LIMITED. THE CONTRACTOR SHALL ONLY ACCESS THIS SITE BY RAISING AND/OR LOWERING ALL EQUIPMENT AND MATERIAL OVER THE SIDES OF THE BRIDGE. THE CONTRACTOR WILL NOT BE ALLOWED OTHER ACCESS WITHOUT WRITTEN PERMISSION FROM THE ENGINEER. THIS WORK WILL NOT BE PAID FOR SEPARATELY, BUT SHALL BE CONSIDERED AS INCLUDED IN THE CONTRACT UNIT PRICES FOR THE CONSTRUCTION ITEMS INVOLVED AND NO ADDITIONAL COMPENSATION WILL BE ALLOWED.

 1501 N. Higgins Road, Suite 200 Chicago, Illinois 60631 (773) 399-0112	USER NAME = 1485	DESIGNED -	REVISED -	STATE OF ILLINOIS DEPARTMENT OF TRANSPORTATION	WILLOW ROAD OVER DES PLAINES RIVER RIPRAP IMPROVEMENTS RAMP B SN 016-0273		F.A.P. RTE.	SECTION	COUNTY	TOTAL SHEETS	SHEET NO.
	PLOT SCALE = 20.0000' / 1" =	CHECKED -	REVISED -		330	2012-06B I	COOK	15	9		
	PLOT DATE = 1/25/2013	DATE = 12-20-2012	REVISED -		SCALE: 1"=10' SHEET 1 OF 1 SHEETS STA. 24+15 TO STA. 27+10		CONTRACT NO. 60V73 ILLINOIS FED. AID PROJECT				

DATE	
BY	
ORIGINAL SURVEY	
SAVED	
PLOTTED	
NOTE BOOK	
NO.	

DATE	
BY	
ORIGINAL SURVEY	
SAVED	
PLOTTED	
NOTE BOOK	
NO.	

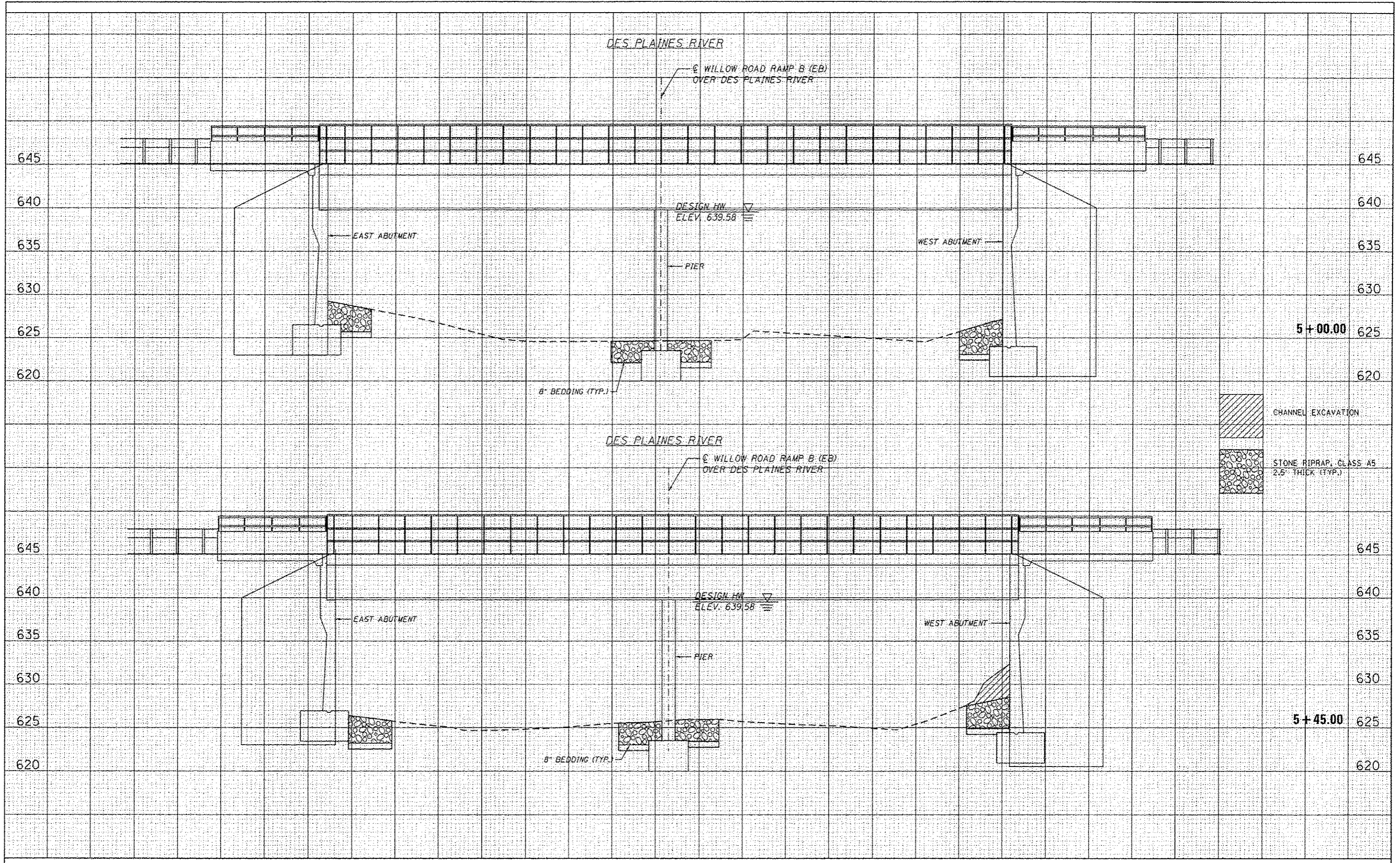

GR&EF
501 W. Higgins Road, Suite 200
Oroquois, Illinois 60453
(708) 399-0112

USER NAME = 1405
PLOT SCALE = 20.0000' / 1" =
PLOT DATE = 1/25/2013

DESIGNED -
DRAWN -
CHECKED -
DATE -

REVISED -
REVISED -
REVISED -
REVISED -

STATE OF ILLINOIS
DEPARTMENT OF TRANSPORTATION

WILLOW ROAD RIP RAP IMPROVEMENTS - CROSS SECTIONS
RAMP B STRUCTURE NO. 016-0273

SCALE: SHEET 1 OF 1 SHEETS STA. TO STA.

F.A.P. RTE. 330	SECTION 2012-06B I	COUNTY COOK	TOTAL SHEETS 15	SHEET NO. 10
CONTRACT NO. 60V73			ILLINOIS FED. AID PROJECT	

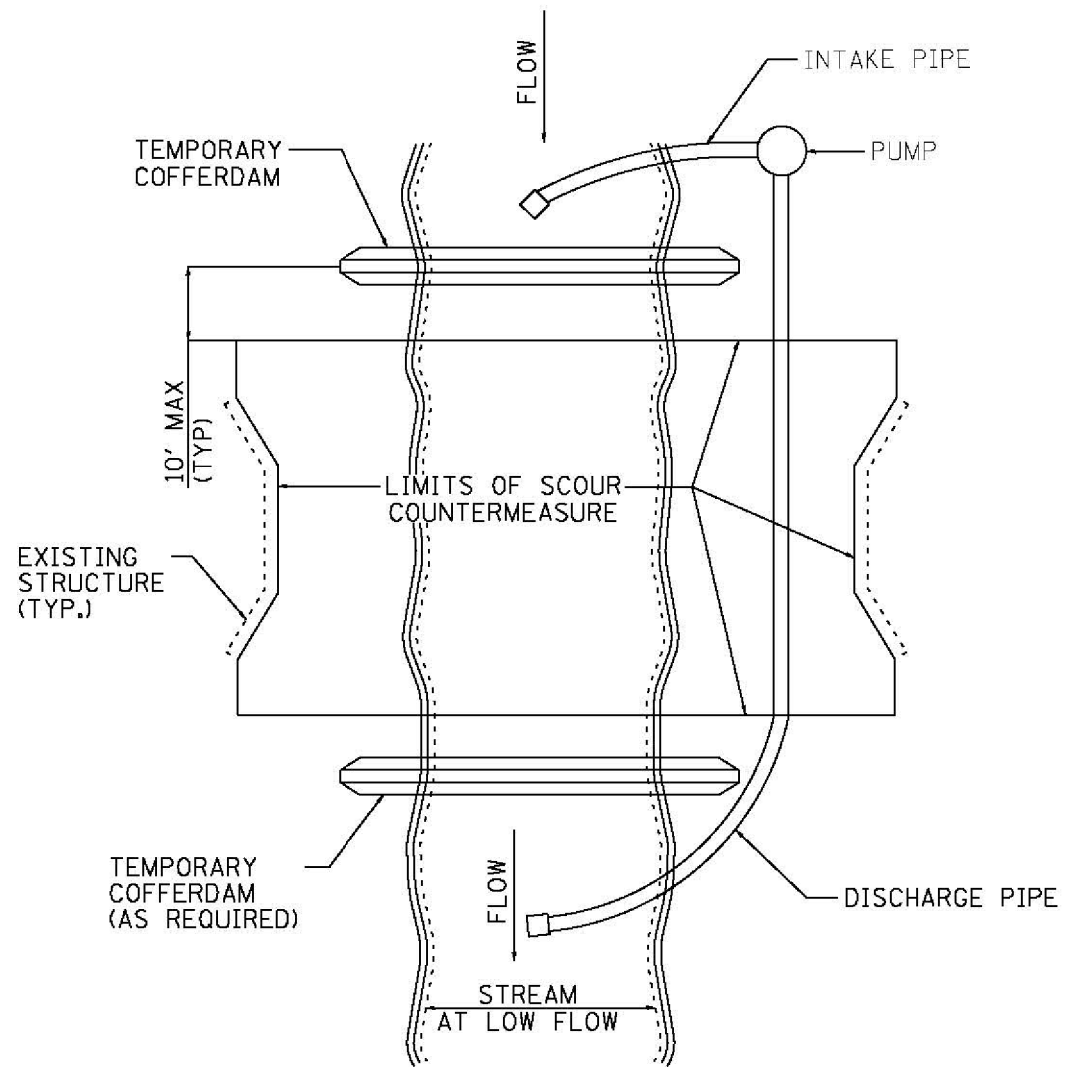

FIGURE D1. TEMPORARY COFFERDAM WITH PUMP BYPASS

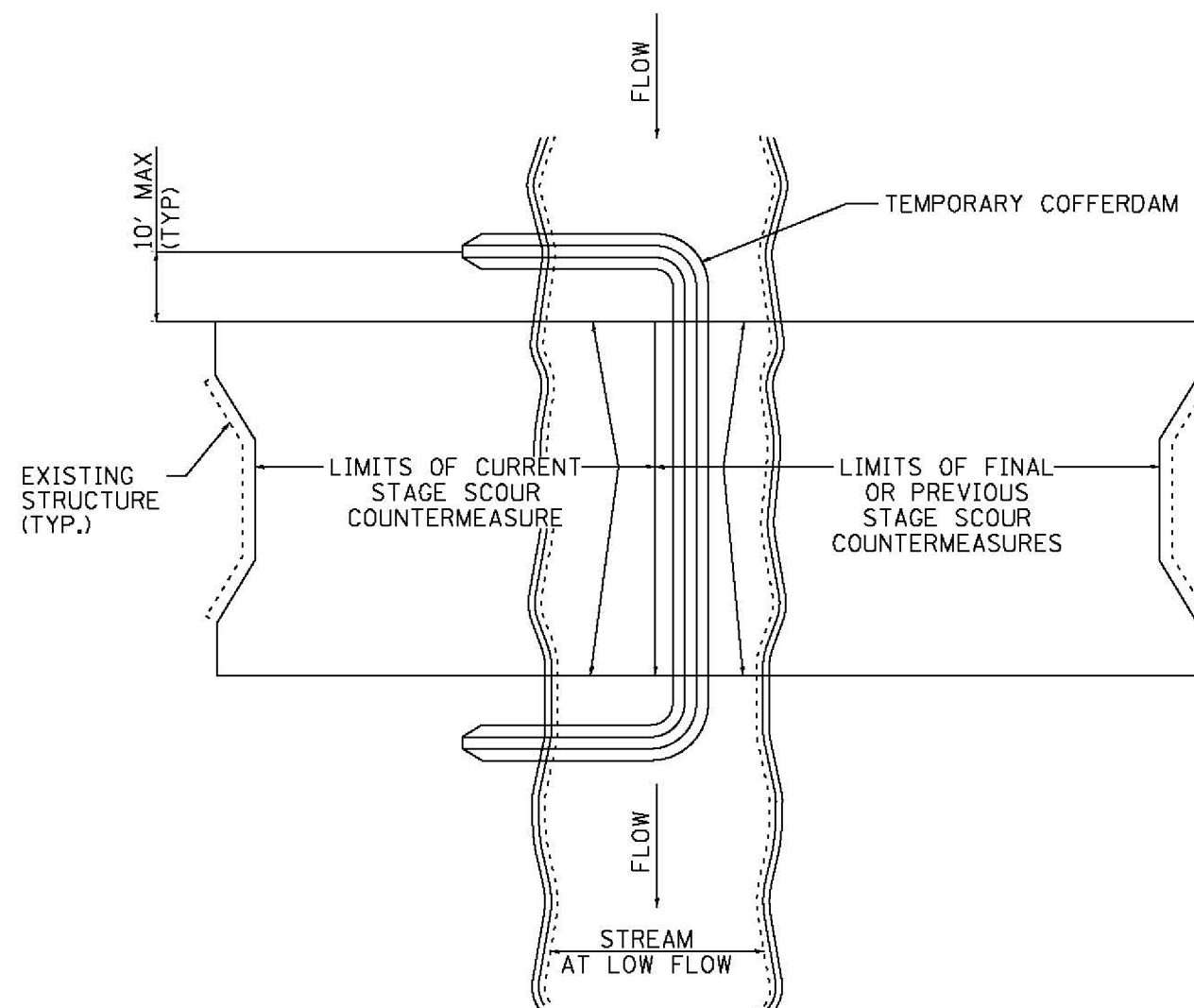
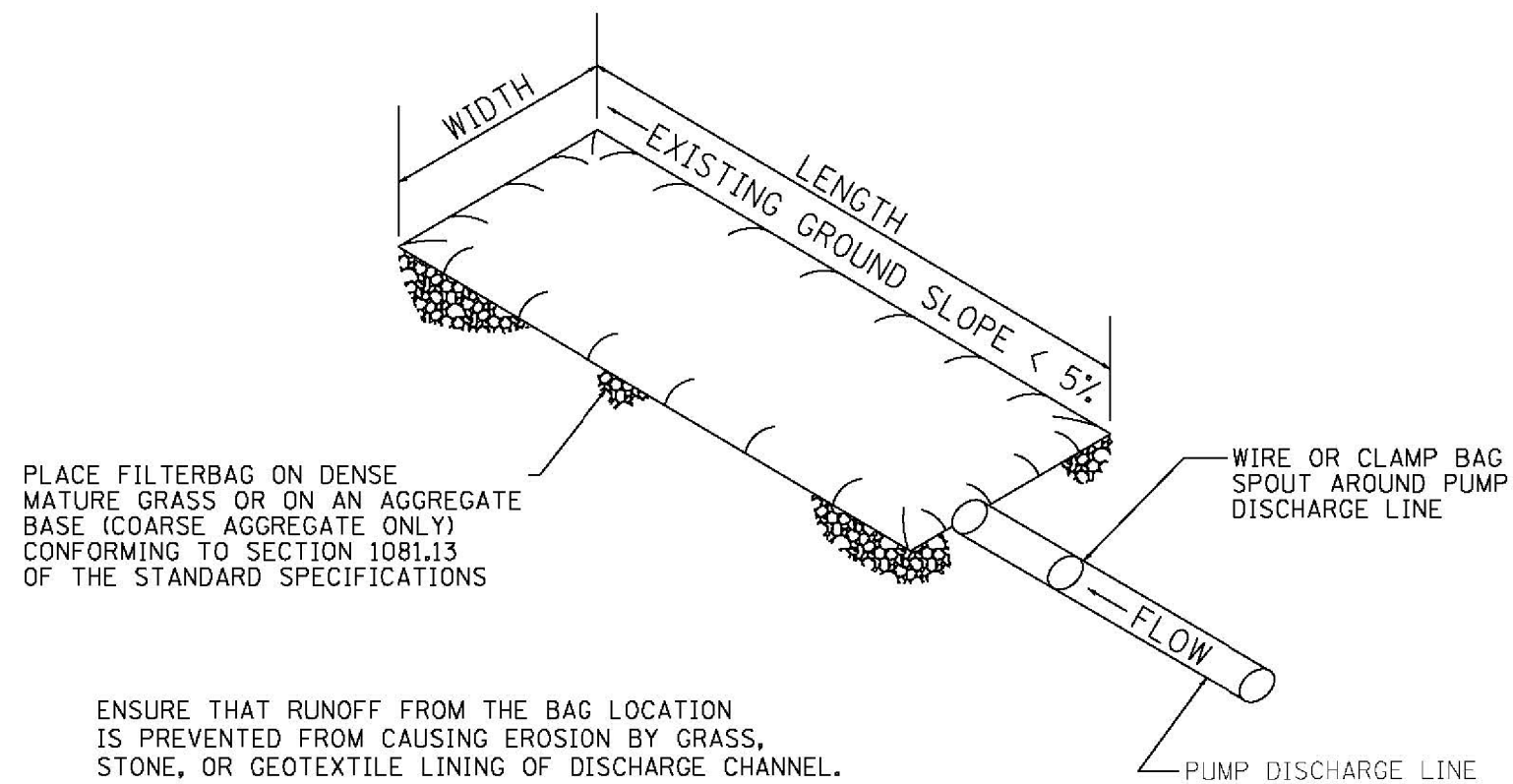

FIGURE D2. STAGED IN-STREAM COFFERDAM DIVISION

NOTE: DEWATERING SYSTEM DETAILS SHALL BE USED IN CONJUNCTION WITH THE PROJECT SPECIAL PROVISIONS.



PLACE FILTERBAG ON DENSE MATURE GRASS OR ON AN AGGREGATE BASE (COARSE AGGREGATE ONLY) CONFORMING TO SECTION 1081.13 OF THE STANDARD SPECIFICATIONS

ENSURE THAT RUNOFF FROM THE BAG LOCATION IS PREVENTED FROM CAUSING EROSION BY GRASS, STONE, OR GEOTEXTILE LINING OF DISCHARGE CHANNEL.

REMOVE SILT WHEN BAG IS HALF FULL OR MORE OFTEN IF RECOMMENDED BY THE MAUNFACUTURER. DISPOSE OF SILT BY TRANSPORTING THE FILLED BAG TO DISPOSAL AREA. SLIT THE BAG, BLEND SILT INTO EXISTING TOPOGRAPHY, SEED AND MULCH

MAINTAIN EXTRA FILTER BAGS ON SITE. REPLACE DAMAGED BAGS PROMPTLY.

TYPICAL FLOW RATE: 10 GPM x W x L

FIGURE S1. SEDIMENT FILTER BAG

NOTE: DEWATERING SYSTEM DETAILS SHALL BE USED IN CONJUNCTION WITH THE PROJECT SPECIAL PROVISIONS.

USER NAME = 1485	DESIGNED -	REVISED -
	DRAWN -	REVISED -
PLOT SCALE = 48.0000' / in.	CHECKED -	REVISED -
PLOT DATE = 12/11/2012	DATE - 12-20-2012	REVISED -

F.A.P. RTE.	SECTION	COUNTY	TOTAL SHEETS	SHEET NO.
330	2012-068 I	COOK	15	12
				CONTRACT NO. 60V73
ILLINOIS FED. AID PROJECT				

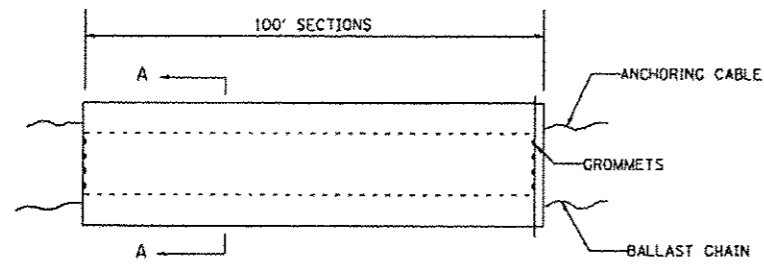

ELEVATION

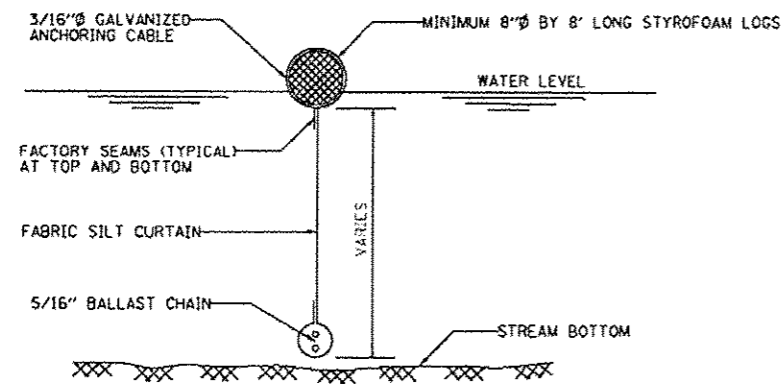

SECTION A-A

FLOTATION BOOM

NOTES:

1. FLOTATION BOOM SHALL BE ANCHORED TO PREVENT DRIFT SHOREWARD OR DOWNSTREAM. ANCHORAGES SHALL BE INSTALLED ON BOTH SHORE AND STREAM SIDE.
2. SHORE ANCHORS SHALL CONSIST OF A POST WITH DEADMAN OR APPROVED EQUAL. STREAM ANCHORS SHALL BE SUFFICIENT SIZE TO STABILIZE THE BARRIER WITH NUMBER AND SPACING DEPENDENT ON WATERWAY VELOCITIES.
3. FABRIC SECTIONS SHALL BE CONNECTED END TO END WITH MINIMUM 5/8" DIAMETER POLYPROPYLENE ROPE
4. DESIGN OF BOOM AND ANCHORAGE SHALL BE IN ACCORDANCE WITH MANUFACTURER'S RECOMMENDATIONS. BOTTOM OF BOOM SHALL REACH BOTTOM OF WATERWAY USING ONE OR TWO VERTICAL SECTIONS AS REQUIRED.
5. MAINTENANCE SHALL BE PERFORMED AS NEEDED. CONTRACTOR SHALL REMOVE THE BOOM AT COMPLETION OF WORK IN A MANNER THAT WILL PREVENT SILTATION OF THE WATERWAY.

APPLICATION: FLOTATION BOOMS TO BE USED TO CONTROL EROSION, TURBIDITY AND DEBRIS WHEN WORKING IN WATERWAYS.

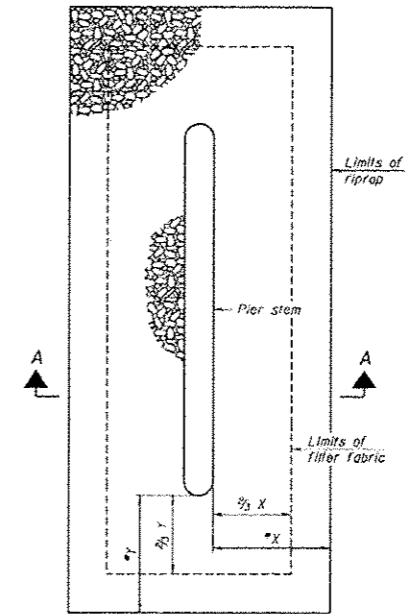

PLAN

* See Chapter 11 of Drainage Manual for procedure to calculate this dimension.

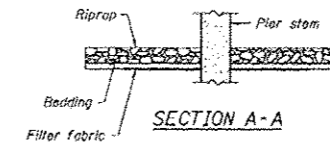

SECTION A-A

GR2EF 8501 N. Higgins Road Suite 200
Chicago, Illinois 60631
773 399-0112

USER NAME • 1485	DESIGNED -	REVISED -
	DRAWN -	REVISED -
PLOT SCALE • 48,0000' / 1" =	CHECKED -	REVISED -
PLOT DATE • 1/25/2013	DATE - 12-20-2012	REVISED -

**STATE OF ILLINOIS
DEPARTMENT OF TRANSPORTATION**

**WILLOW ROAD OVER DES PLAINES RIVER RIPRAP IMPROVEMENTS
DEWATERING SYSTEM DETAILS**

SCALE: SHEET 3 OF 3 SHEETS STA. TO STA.

F.A.P. RTE. 330	SECTION 2012-068 I	COUNTY COOK	TOTAL SHEETS 15	SHEET NO. 13
CONTRACT NO. 60V73			ILLINOIS FED. AID PROJECT	

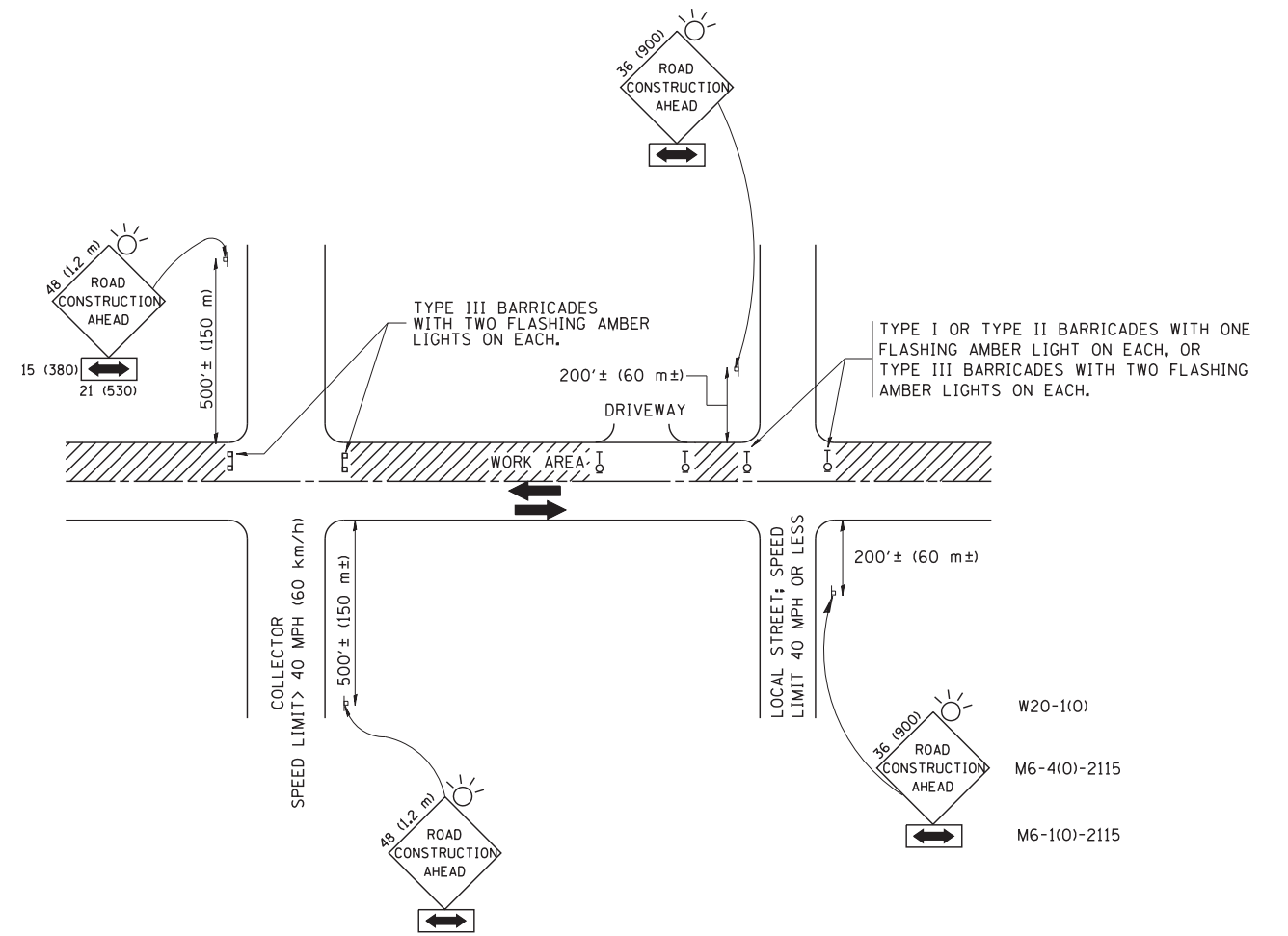

TRAFFIC CONTROL AND PROTECTION FOR SIDE ROADS, INTERSECTIONS, AND DRIVEWAYS

NOTES:

A. FOR NO LANE RESTRICTION ON THE SIDE ROAD OR DRIVEWAYS

1. SIDE ROAD WITH A SPEED LIMIT OF 40 MPH (60 km/h) OR LESS AS SHOWN ON THE DRAWING AND AS DIRECTED BY THE ENGINEER:

a) ONE **ROAD CONSTRUCTION AHEAD** SIGN 36 x 36 (900x900) WITH A FLASHER AND FLAG MOUNTED ON IT APPROXIMATELY 200' (60 m) IN ADVANCE OF THE MAIN ROUTE.

b) THE CLOSED PORTION OF THE MAIN ROUTE SHALL BE PROTECTED BY BLOCKING WITH TYPE I, TYPE II OR TYPE III BARRICADES, 1/3 OF THE CROSS SECTION OF THE CLOSED PORTION.

2. SIDE ROAD WITH A SPEED LIMIT GREATER THAN 40 MPH (60 km/h) AS SHOWN ON THE DRAWING AND AS DIRECTED BY THE ENGINEER:

a) ONE **ROAD CONSTRUCTION AHEAD** SIGN 48 x 48 (1.2 m x 1.2 m) WITH A FLASHER MOUNTED ON IT APPROXIMATELY 500' (150 m) IN ADVANCE OF THE MAIN ROUTE.

b) THE CLOSED PORTION OF THE MAIN ROUTE SHALL BE PROTECTED BY BLOCKING WITH TYPE III BARRICADES, 1/2 OF THE CROSS SECTION OF THE CLOSED PORTION.

3. WHEN THE SIDE ROAD LIES BETWEEN THE BEGINNING OF THE MAINLINE SIGNING AND THE WORK ZONE, A SINGLE HEADED ARROW (M6-1) SHALL BE USED IN LIEU OF THE DOUBLE HEADED ARROW (M6-4).

B. FOR A LANE CLOSURE ON A SIDE ROAD OR DRIVEWAY:

USE APPLICABLE PORTIONS OF THE TYPICAL APPLICATION OF TRAFFIC CONTROL DEVICES (STD. 701501, STD. 701606 OR THE APPROPRIATE STANDARD). THE SPACING OF SIGNS AND BARRICADES SHALL BE ADJUSTED FOR FIELD CONDITIONS AS DIRECTED BY THE ENGINEER. THE DIRECTIONAL ARROW SHALL BE COVERED OR REMOVED WHEN NO LONGER CONSISTENT WITH THE SIDE ROAD LANE CLOSURE.

C. ADVANCE WARNING SIGNS ARE TO BE OMITTED ON DRIVEWAY UNLESS OTHERWISE NOTED.

D. THE TRAFFIC CONTROL AND PROTECTION FOR SIDE ROADS, INTERSECTIONS, AND DRIVEWAYS SHALL BE INCIDENTAL TO THE COST OF SPECIFIED TRAFFIC CONTROL STANDARDS OR ITEMS.

All dimensions are in millimeters (inches) unless otherwise shown.

FILE NAME = W:\diststd\22x34\tc10.dgn	USER NAME = gegl10nbt	DESIGNED - LHA	REVISED - J. OBERLE 10-18-95
		DRAWN -	REVISED - A. HOUSEH 03-06-96
	PLOT SCALE = 50.000' / IN.	CHECKED -	REVISED - A. HOUSEH 10-15-96
	PLOT DATE = 1/4/2008	DATE - 06-89	REVISED - T. RAMMACH 01-06-00

STATE OF ILLINOIS
DEPARTMENT OF TRANSPORTATION

TRAFFIC CONTROL AND PROTECTION FOR
SIDE ROADS, INTERSECTIONS, AND DRIVEWAYS

SCALE: NONE SHEET NO. 1 OF 1 SHEETS STA. TO STA.

F.A.P. RTE.	SECTION	COUNTY	TOTAL SHEETS	SHEET NO.
330	2012-068 I	COOK	15	14
TC-10			CONTRACT NO. 60V73	
FED. ROAD DIST. NO. 1 ILLINOIS FED. AID PROJECT				

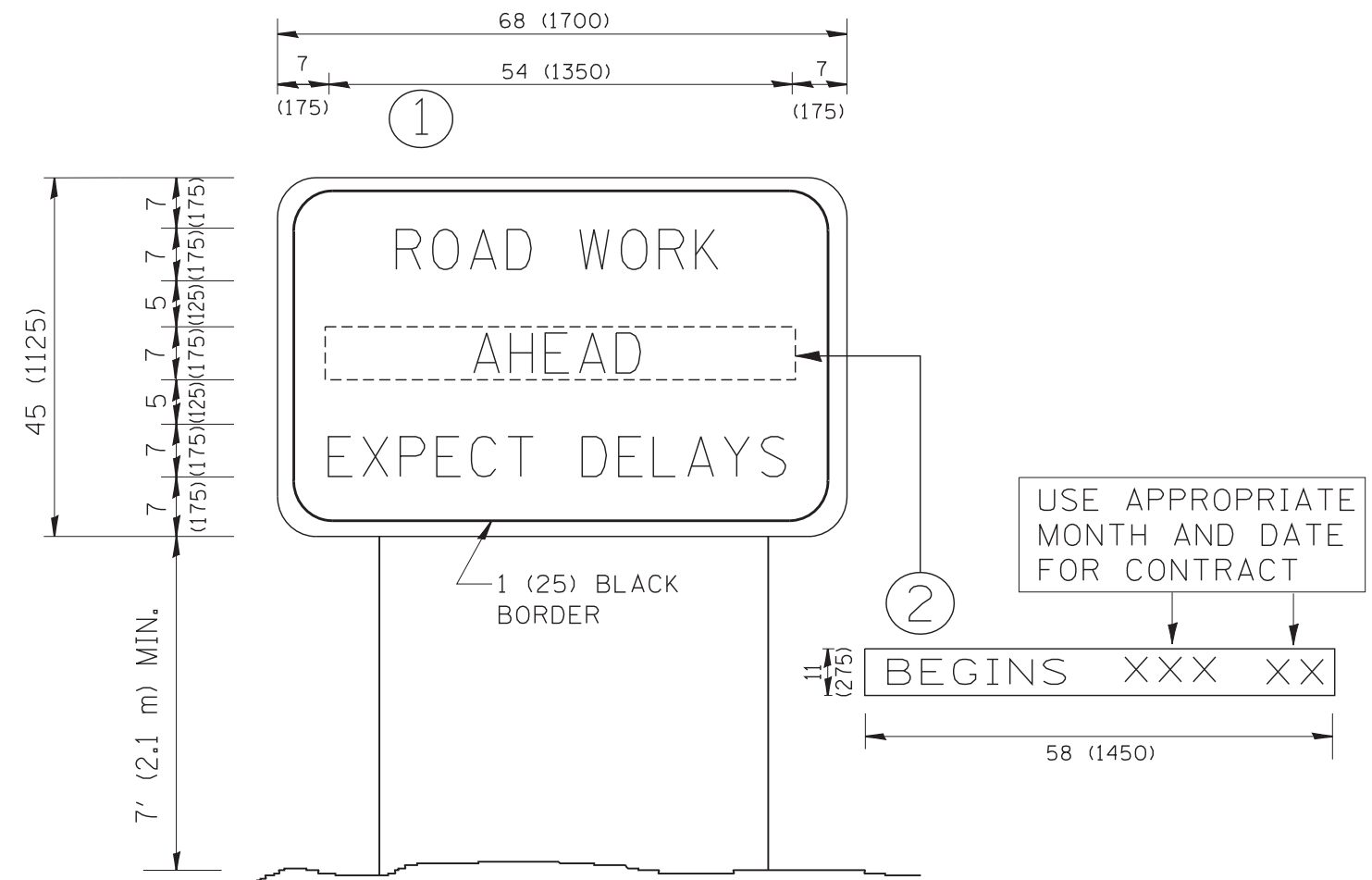

NOTES:

1. USE BLACK LETTERING ON ORANGE BACKGROUND.
2. ERECT SIGNS IN ADVANCE OF THE LOCATION FOR THE "ROAD CONSTRUCTION AHEAD" SIGN AT LOCATIONS AS DIRECTED BY THE ENGINEER.
3. ERECT SIGN ① WITH INSTALLED PANEL ② ONE WEEK PRIOR TO THE START OF CONSTRUCTION.
4. REMOVE PANEL ② SOON AFTER THE START OF CONSTRUCTION.
5. SEE SPECIAL PROVISION FOR "TEMPORARY INFORMATION SIGNING" FOR ADDITIONAL INFORMATION.
6. ONE SIGN ASSEMBLY EQUALS 25.70 SQ. FT. (2.3 SQ. M.)
7. SHALL BE PAID FOR AS TEMPORARY INFORMATION SIGNING.

ALL DIMENSIONS ARE IN INCHES (MILLIMETERS) UNLESS OTHERWISE SHOWN.

FILE NAME = W:\diststd\22x34\tc22.dgn	USER NAME = gegltonbt	DESIGNED -	REVISED - R. MIRS 09-15-97
		DRAWN -	REVISED - R. MIRS 12-11-97
	PLOT SCALE = 50.000' / IN.	CHECKED -	REVISED - T. RAMMACHER 02-02-99
	PLOT DATE = 1/4/2008	DATE -	REVISED - C. JUCIUS 01-31-07

**STATE OF ILLINOIS
DEPARTMENT OF TRANSPORTATION**

**ARTERIAL ROAD
INFORMATION SIGN**

SCALE: NONE SHEET NO. 1 OF 1 SHEETS STA. TO STA.

F.A.P. RTE.	SECTION	COUNTY	TOTAL SHEETS	SHEET NO.
330	2012-068 I	COOK	15	15
TC-22			CONTRACT NO. 60V73	
FED. ROAD DIST. NO. 1 ILLINOIS FED. AID PROJECT				