

PIPE SCHEDULE							
PIPE NO.	STR. NO. FROM	STR. NO. TO	DESCRIPTION	IN DIA.	FT LEN	SLOPE	CU YD TBF
369A	369A	373A	SS, CL A, TY 2	15	56.3	1.05%	36.1
372A	373A	EX370	SS, CL A, TY 2	15	32.9	0.94%	24.5
373A	373	373A	SS, CL A, TY 2	12	5.7	1.05%	3.6
378A	378	373	SS, CL A, TY 2	12	61.0	0.70%	20.8
379A	381	384	SS, CL A, TY 2	12	81.0	1.02%	22.5
385	384	385	SS, CL A, TY 2	12	23.2	1.08%	6.9
385A	385	EX385	SS, CL A, TY 2	12	38.7	0.57%	14.0
390A	388	391	SS, CL A, TY 2	12	81.1	1.04%	19.1

STRUCTURE SCHEDULE												
STR. NO.	STA.	OFFSET	STRUCTURE	OTHER	COVER	TEMP. RIM ELEV.	TEMP. RIM ELEV.	FINAL RIM ELEV.	N	E	S	W
						CONTRACT 60W09	CONTRACT 60M61	CONTRACT 60M61				
369A	216+95.00	6.5' RT	MH TA 4		T1F CL	703.64	704.91	705.37	698.33(NW) 12"	699.15(E) 12"	698.23(S) 12"	699.03(W) 12"
EX370	216+34.70	44.4' RT	ADJ MH					703.90	686.91(N) 48"	699.24(SE) 12"	686.81(S) 48"	697.28(W) 12"
373	216+25.00	6.5' RT	MH TA 4		T1F CL	703.35	704.63	706.42	697.70(N) 12"	698.75(E) 12"	697.80(S) 12"	698.75(W) 12"
373A	216+34.70	6.5' RT	MH TA 4		T1F CL	703.39	704.67	706.46	697.64(N) 12"	697.59(E) 15"	697.64(S) 12"	
378	215+60.00	6.5' RT	MH TA 4		T1F CL	702.88	704.31	706.11	698.23(N) 12"			698.33(W) 12"
381	213+85.00	3.6' LT	MH TA 4		T1F CL	701.12	702.52	704.16		696.58(E) 12"	696.48(S) 12"	696.58(W) 12"
384	213+00.00	2.7' LT	MH TA 4		T1F CL	699.84	701.22	702.73	695.65(N) 12"	695.16(E) 12"	695.06(S) 12"	695.29(W) 12"
EX385	212+72.80	42.1' RT	ADJ MH					699.96	685.88(N) 48"		685.78(S) 48"	694.39(W) 12"
385	212+72.80	1.6' LT	MH TA 4		T1F CL	699.36	700.79	702.34	694.81(N) 12"	694.61(E) 12"		
388	212+15.00	' RT	MH TA 4		T1F CL	698.35	699.88	699.77		693.96(E) 12"	693.87(S) 12"	693.97(W) 12"
391	211+30.00	3' RT	MH TA 4		T1F CL	696.71	698.54	698.55	693.03(N) 12"	692.75(E) 12"	692.46(S) 12"	692.66(W) 12"

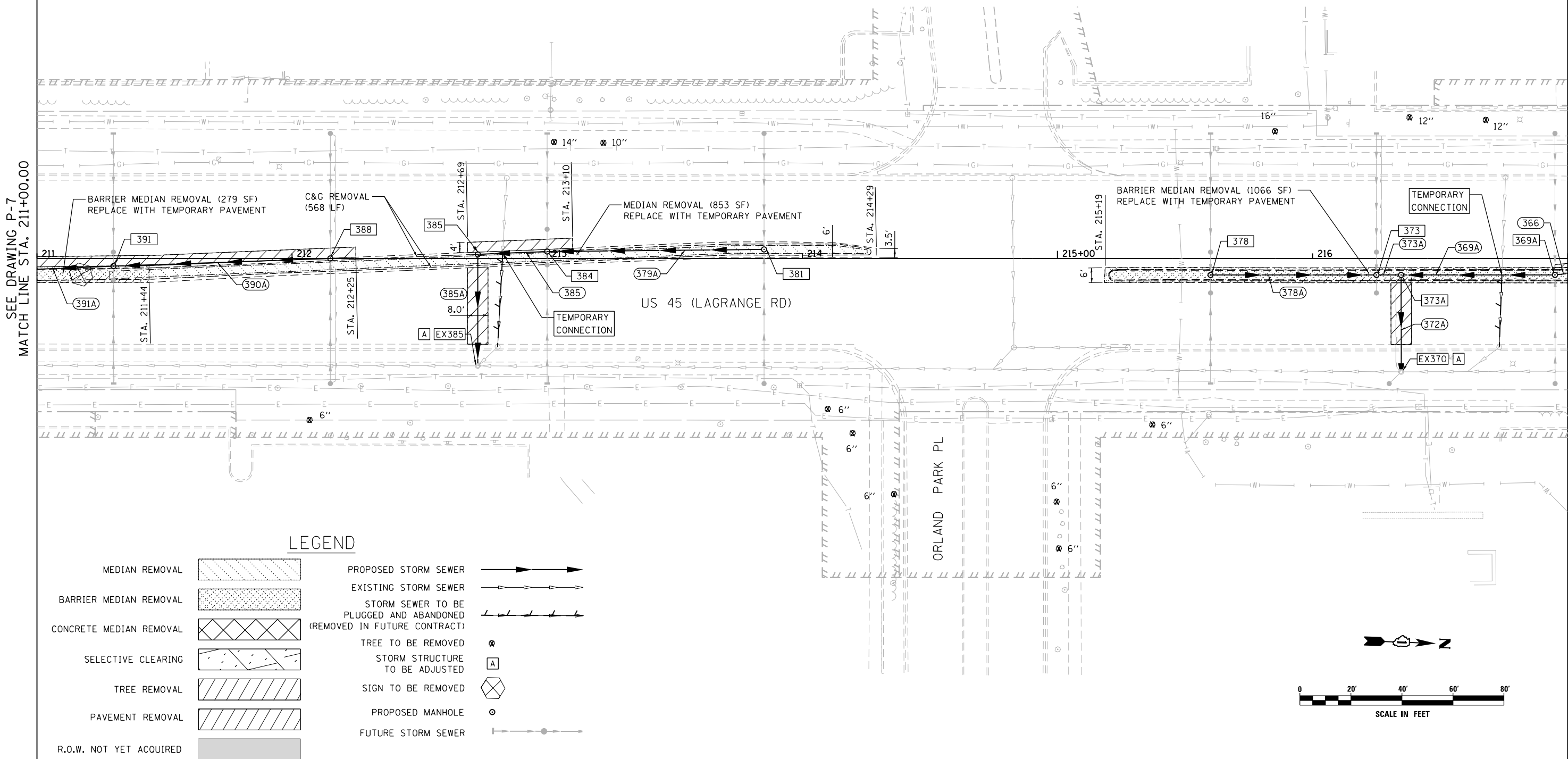

**LEGEND**

- |                         |  |  |  |
|-------------------------|--|--|--|
| MEDIAN REMOVAL          |  | PROPOSED STORM SEWER   |  |
| BARRIER MEDIAN REMOVAL  |  | EXISTING STORM SEWER   |  |
| CONCRETE MEDIAN REMOVAL |  | STORM SEWER TO BE PLUGGED AND ABANDONED (REMOVED IN FUTURE CONTRACT) |  |
| SELECTIVE CLEARING      |  | TREE TO BE REMOVED   |  |
| TREE REMOVAL            |  | STORM STRUCTURE TO BE ADJUSTED                                       |  |
| PAVEMENT REMOVAL        |  | SIGN TO BE REMOVED   |  |
| R.O.W. NOT YET ACQUIRED |  | PROPOSED MANHOLE   |  |
|                         |  | FUTURE STORM SEWER   |  |

100 S. WACKER DR.  
 SUITE 600  
 CHICAGO, IL 60606  
 TEL (312) 935-1000  
 FAX (312) 935-4998  
**URS**

FILE NAME = D160W09-SHT-DRAINPR08.dgn	USER NAME = Anthony.Plutz	DESIGNED - EJD	REVISED -
		DRAWN - EJD	REVISED -
		CHECKED - JWM	REVISED -
		DATE - 01/02/13	REVISED -

**STATE OF ILLINOIS  
DEPARTMENT OF TRANSPORTATION**

**REMOVAL, TEMPORARY PAVEMENT, AND DRAINAGE PLAN**

SCALE: 1"=20' SHEET 8 OF 37 SHEETS STA. 211+00.00 TO STA. 217+00.00

F.A.P. RTE. 330	SECTION 2012-0881	COUNTY COOK	TOTAL SHEETS 152	SHEET NO. 33
<b>P-8</b>		CONTRACT NO. 60W09		
ILLINOIS FED. AID PROJECT				