

1 STORY BUILDING  
VILLAGE GREEN  
SHOPPING CENTER

CLARK  
GAS

SEE DRAWING P-12  
MATCH LINE STA. 240+00.00

MATCH LINE STA. 246+00.00  
SEE DRAWING P-14

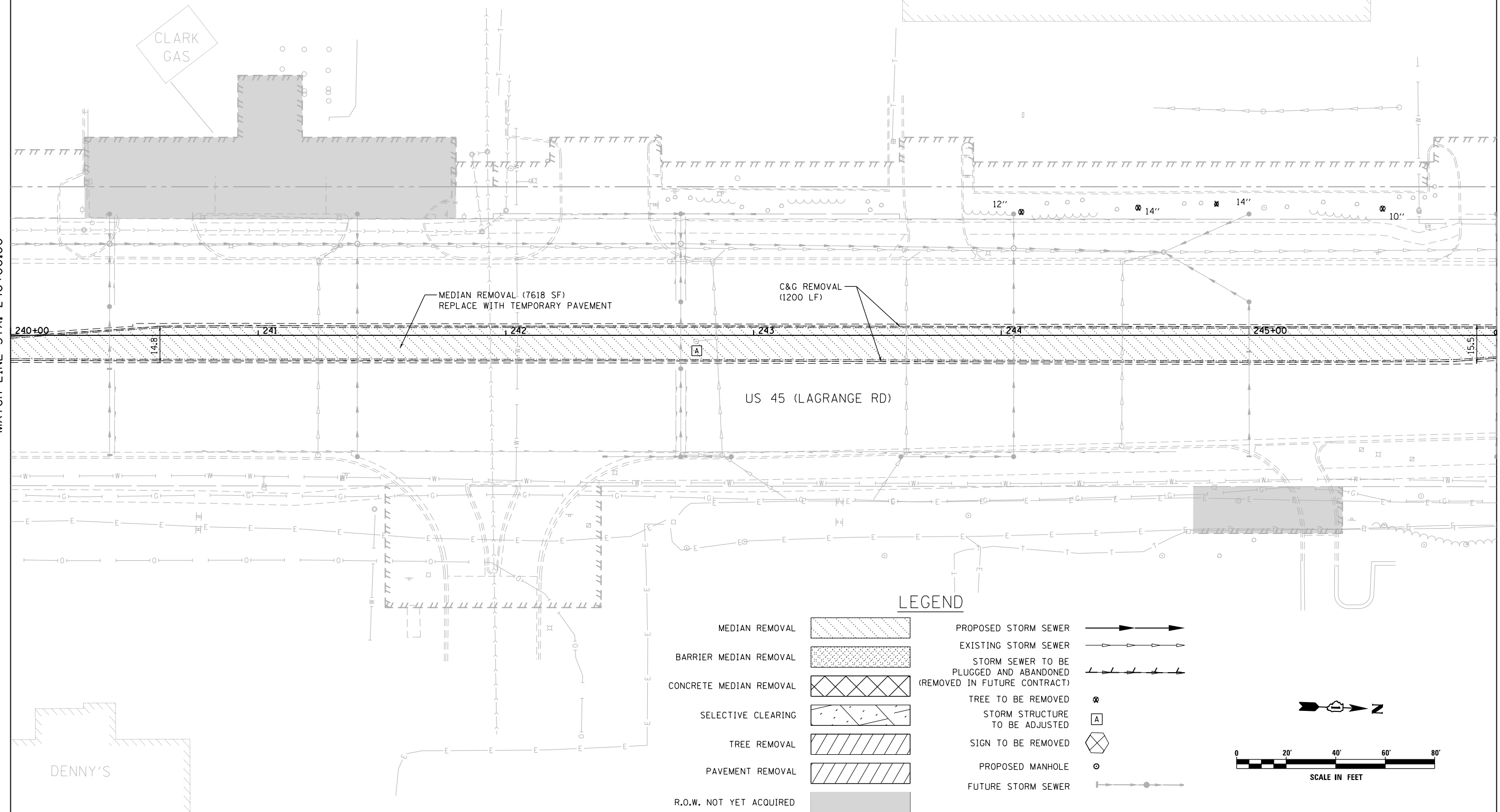

**LEGEND**

- MEDIAN REMOVAL
- BARRIER MEDIAN REMOVAL
- CONCRETE MEDIAN REMOVAL
- SELECTIVE CLEARING
- TREE REMOVAL
- PAVEMENT REMOVAL
- R.O.W. NOT YET ACQUIRED
- PROPOSED STORM SEWER
- EXISTING STORM SEWER
- STORM SEWER TO BE PLUGGED AND ABANDONED (REMOVED IN FUTURE CONTRACT)
- TREE TO BE REMOVED
- STORM STRUCTURE TO BE ADJUSTED
- SIGN TO BE REMOVED
- PROPOSED MANHOLE
- FUTURE STORM SEWER

**URS**  
100 S. WACKER DR.  
SUITE 600  
CHICAGO, IL 60606  
TEL (312) 935-1000  
FAX (312) 935-4998

FILE NAME = D160W09-SHT-DRAINPR13.dgn	USER NAME = Anthony.Plutz	DESIGNED - EJD	REVISED -
SHT_PLAN	PLOT SCALE = 48.0000' / in.	DRAWN - EJD	REVISED -
	PLOT DATE = 1/7/2013	CHECKED - JWM	REVISED -
		DATE - 01/02/13	REVISED -

**STATE OF ILLINOIS  
DEPARTMENT OF TRANSPORTATION**

**REMOVAL, TEMPORARY PAVEMENT, AND DRAINAGE PLAN**  
SCALE: 1"=20' SHEET 13 OF 37 SHEETS STA. 240+00.00 TO STA. 246+00.00

F.A.P. RTE.	SECTION	COUNTY	TOTAL SHEETS	SHEET NO.
330	2012-0881	COOK	152	38
<b>P-13</b>			<b>CONTRACT NO. 60W09</b>	
ILLINOIS FED. AID PROJECT				