

STRUCTURE SCHEDULE												
STR. NO.	STA.	OFFSET	STRUCTURE	OTHER	COVER	TEMP. RIM ELEV. CONTRACT 60W09	TEMP. RIM ELEV CONTRACT 60M61	FINAL RIM ELEV. CONTRACT 60M61	N	E	S	W
570	262+50.00	1.8' LT	MH TA 4		T1F CL	718.83	719.87	721.87	713.82(N) 12"	713.92(E) 12"		713.95(W) 12"
577	263+59.70	3.4' LT	MH TA 4		T1F CL	715.60	717.24	719.22	709.17(N) 12"		712.74(S) 12"	709.17(W) 12"
EX571	263+59.70	38.5' LT	RECON MH					716.98	698.11(N) 42"	708.84(E) 12"	698.21(S) 42"	

PIPE SCHEDULE							
PIPE NO.	STR. NO. FROM	STR. NO. TO	DESCRIPTION	IN DIA.	FT LEN	SLOPE	CU YD TBF
571A	577	EX571	SS, CL A, TY 2	12	31.1	1.06%	27.6
574	575	577	SS, CL A, TY 2	12	46.3	1.04%	17.7
577A	570	577	SS, WMR	12	105.7	1.02%	24.9

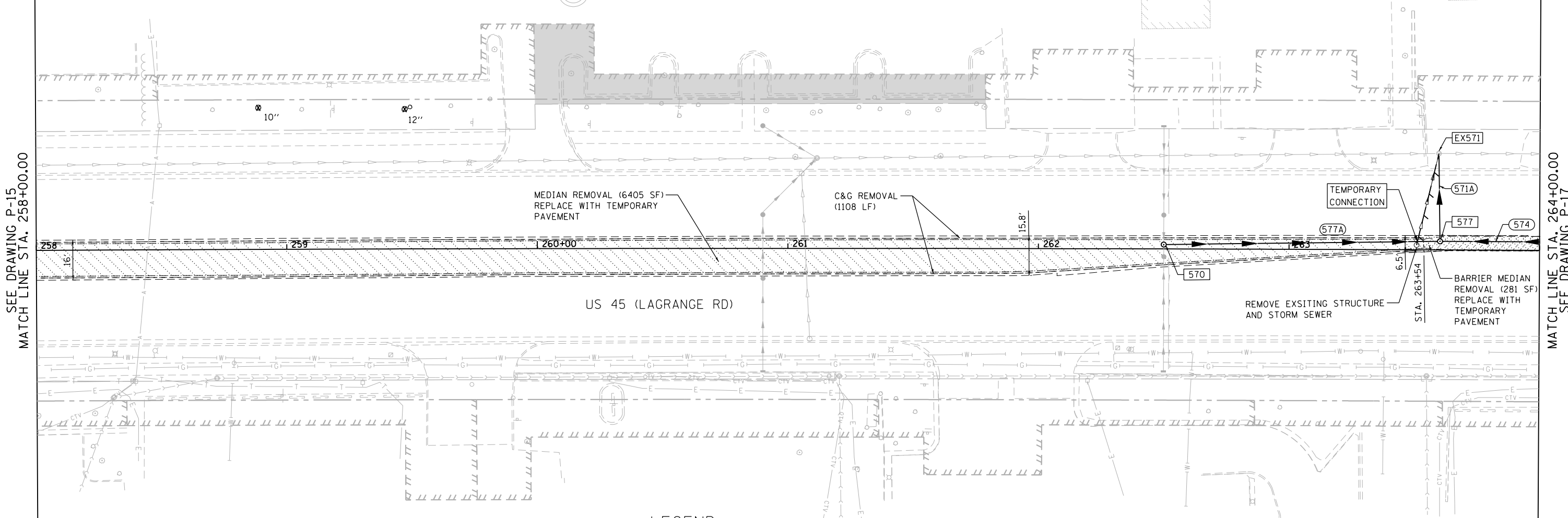

LEGEND

- MEDIAN REMOVAL
- BARRIER MEDIAN REMOVAL
- CONCRETE MEDIAN REMOVAL
- SELECTIVE CLEARING
- TREE REMOVAL
- PAVEMENT REMOVAL
- R.O.W. NOT YET ACQUIRED
- PROPOSED STORM SEWER
- EXISTING STORM SEWER
- STORM SEWER TO BE PLUGGED AND ABANDONED (REMOVED IN FUTURE CONTRACT)
- TREE TO BE REMOVED
- STORM STRUCTURE TO BE ADJUSTED
- SIGN TO BE REMOVED
- PROPOSED MANHOLE
- FUTURE STORM SEWER

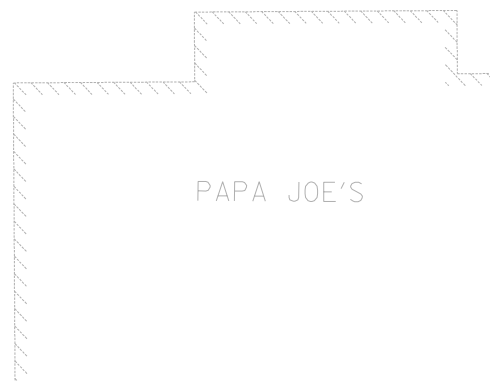

SEE DRAWING P-15
MATCH LINE STA. 258+00.00

MATCH LINE STA. 264+00.00
SEE DRAWING P-17

URS
100 S. WACKER DR.
SUITE 600
CHICAGO, IL 60606
TEL (312) 939-1000
FAX (312) 939-4998

FILE NAME = D:\160W09-SHT-DRAINPR16.dgn	USER NAME = Anthony.Plutz	DESIGNED - EJD	REVISED -	STATE OF ILLINOIS DEPARTMENT OF TRANSPORTATION	REMOVAL, TEMPORARY PAVEMENT, AND DRAINAGE PLAN			F.A.P. RTE. 330	SECTION 2012-0881	COUNTY COOK	TOTAL SHEETS 152	SHEET NO. 41
PLOT SCALE = 48.0000' / in.	CHECKED - JWM	REVISED -			SCALE: 1"=20'	SHEET 16 OF 37 SHEETS	STA. 258+00.00 TO STA. 264+00.00	P-16		CONTRACT NO. 60W09		
SHT. PLAN	PLOT DATE = 1/7/2013	DATE - 01/02/13	REVISED -		ILLINOIS FED. AID PROJECT							