



END CONSTRUCTION
G20-2-2460



LEGEND

- TYPE II BARRICADES OR DRUMS WITH MONO DIRECTIONAL STEADY BURN LIGHT
- ⇨ DIRECTION OF TRAFFIC
- ⊥ TEMPORARY TRAFFIC SIGN ON PERMANENT SUPPORT
- ⌌ TYPE III BARRICADE
- ▨ WORK ZONE
- ▩ TEMPORARY PAVEMENT

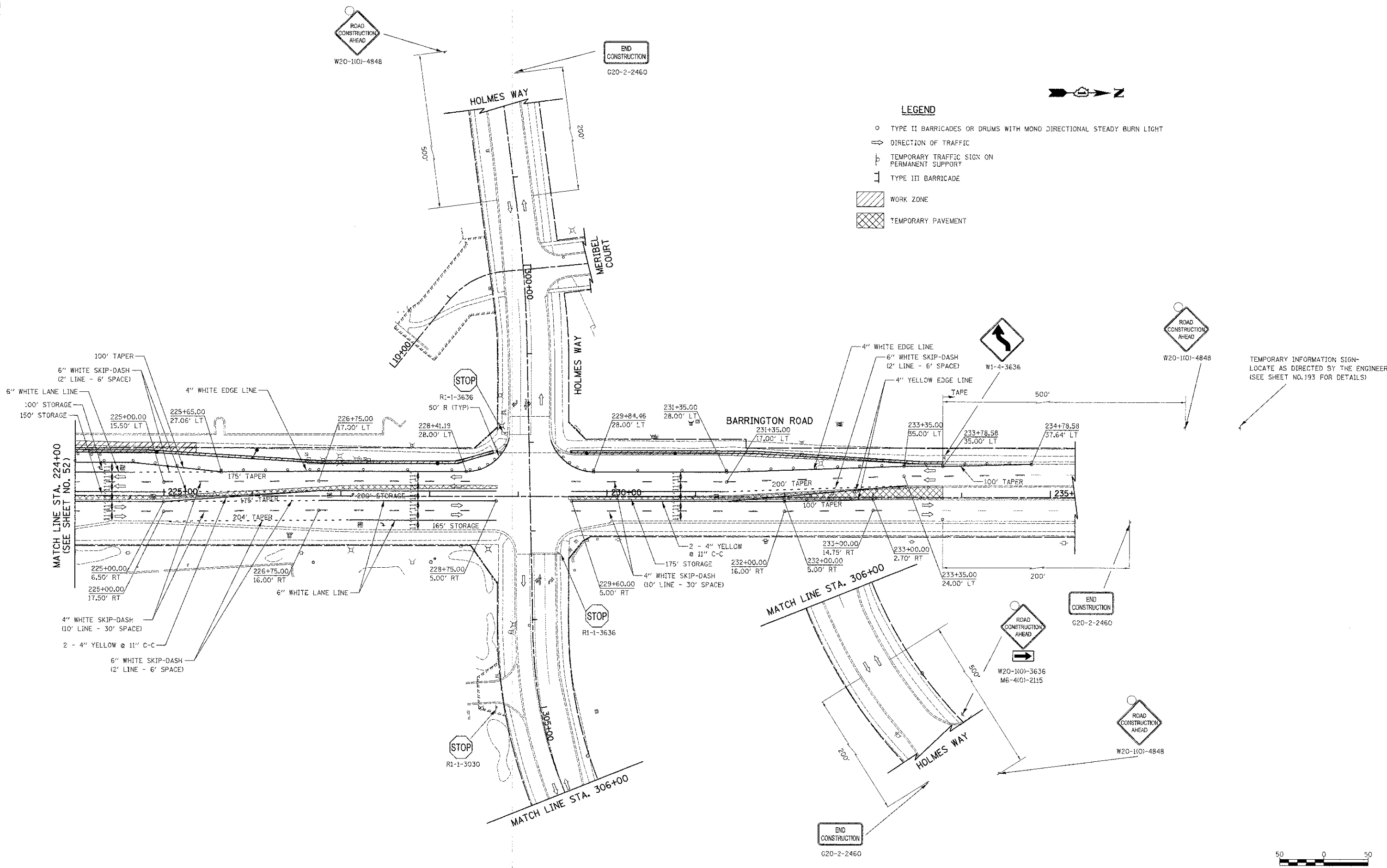

FILE NAME =
 \\sheet\2329.MOT_02_02_01.T.ogn

USER NAME = djr
 PLOT SCALE = 50.0000 / 1" = 50'
 PLOT DATE = 12/23/2012

DESIGNED - BLG
 DRAWN - BLG
 CHECKED - DJR
 DATE - 8-20-12

REVISED -
 REVISED -
 REVISED -
 REVISED -

**STATE OF ILLINOIS
 DEPARTMENT OF TRANSPORTATION**

**BARRINGTON ROAD AND SCHAUMBURG ROAD
 MAINTENANCE OF TRAFFIC - STAGE 1**
 SCALE: 1" = 50' SHEET NO. 2 OF 10 SHEETS STA. 224+00 TO STA. 233+78.58

F.A.U. RTE.	SECTION	COUNTY	TOTAL SHEETS	SHEET NO.
1322	01-00074-00-CH	COOK	245	53
CONTRACT NO. 63629				
FED. ROAD DIST. NO. 1 ILLINOIS FED. AID PROJECT M-CMM-800305D				