

NOTE:

THE CONTRACTOR SHALL INSTALL THE PERMANENT STOP AND NO LEFT TURN SIGNS AT ALL SIDEROADS AND DRIVEWAYS AS SHOWN ON THE PERMANENT SIGNING PLAN AT THE START OF STAGE 3. IF THE CONTRACTOR CHOOSES TO INSTALL TEMPORARY SIGNS, THIS WORK SHALL BE AT THE CONTRACTORS' EXPENSE.

* REMOVE STOP SIGNS AFTER PERMANENT SIGNAL IS INSTALLED AND ACTIVATED.

LEGEND

- TYPE II BARRICADES OR DRUMS WITH MONO DIRECTIONAL STEADY BURN LIGHT
- ⇨ DIRECTION OF TRAFFIC
- ⊥ TEMPORARY TRAFFIC SIGN ON PERMANENT SUPPORT
- ⌈ TYPE II BARRICADE
- ▨ WORK ZONE
- ▩ TEMPORARY PAVEMENT

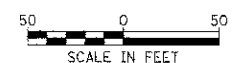
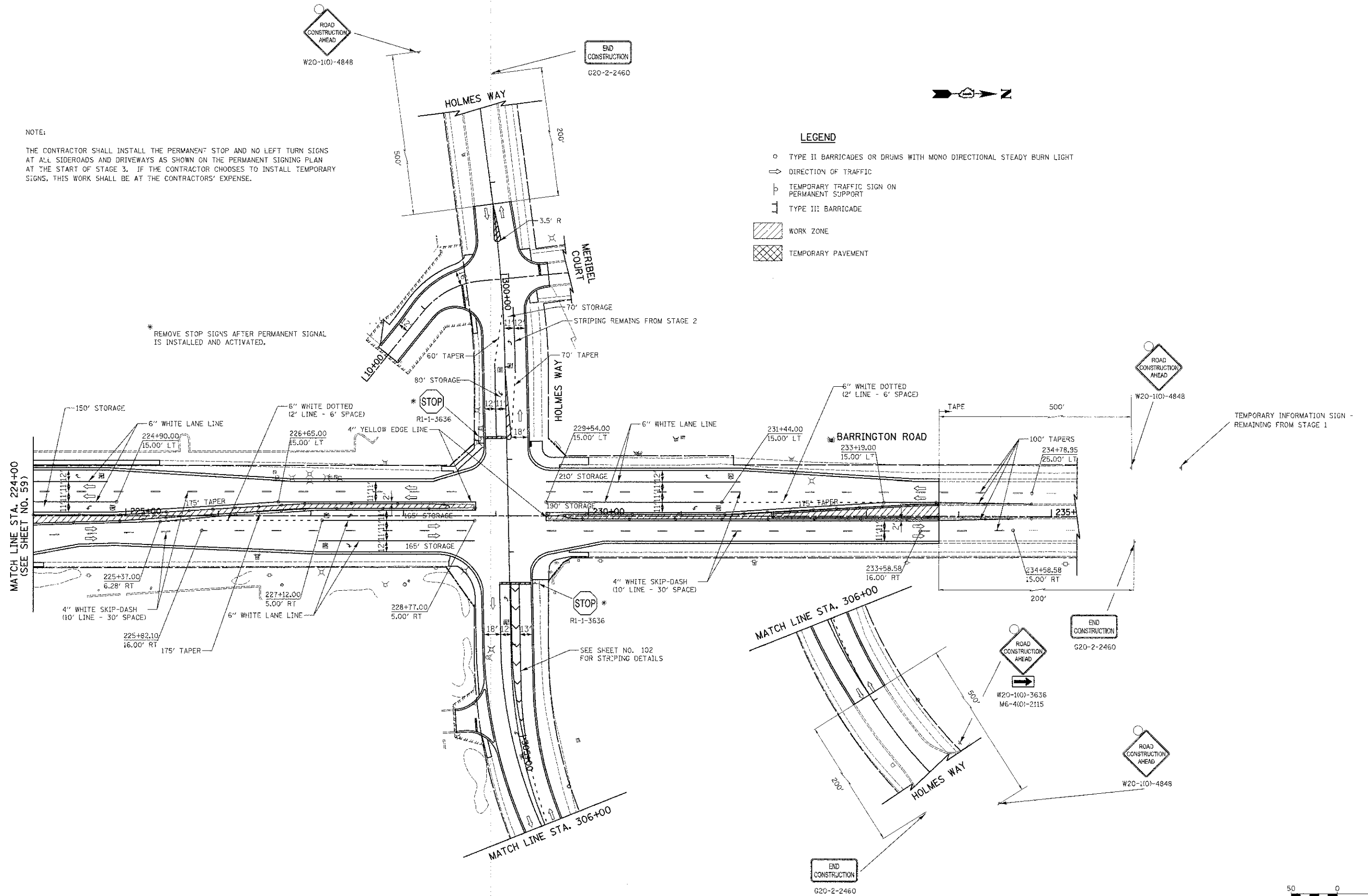

FILE NAME = ...sheet\2329.M01_03_02.dwg	USER NAME = dj	DESIGNED - BLG	REVISED -	STATE OF ILLINOIS DEPARTMENT OF TRANSPORTATION	BARRINGTON ROAD AND SCHAUMBURG ROAD MAINTENANCE OF TRAFFIC - STAGE 3	F.A.U. RTE. 1322	SECTION 01-00074-00-CH	COUNTY COOK	TOTAL SHEETS: NO. 245 60	
PLT SCALE = 56.8338' / in.	CHECKED - DJK	REVISED -	SCALE: 1" = 50'			SHEET NO. 9 OF 10 SHEETS	STA. 224+00 TO STA. 233+78.58	CONTRACT NO. 63629		
PLOT DATE = 10/23/2012	DATE - 8-20-12	REVISED -	FED. ROAD DIST. NO. 1 ILLINOIS FED. AID PROJECT M-CMM-6003051							