

TEMPORARY INFORMATION SIGN
REMAINING FROM STAGE 1

END
CONSTRUCTION
G20-2-2460



W20-1(0)-4848

LEGEND

- TYPE II BARRICADES OR DRUMS WITH MONO DIRECTIONAL STEADY BURN LIGHT
- DIRECTION OF TRAFFIC
- ⊥ TEMPORARY TRAFFIC SIGN ON PERMANENT SUPPORT
- ⊥ TYPE III BARRICADE
- ▨ WORK ZONE
- ▩ TEMPORARY PAVEMENT

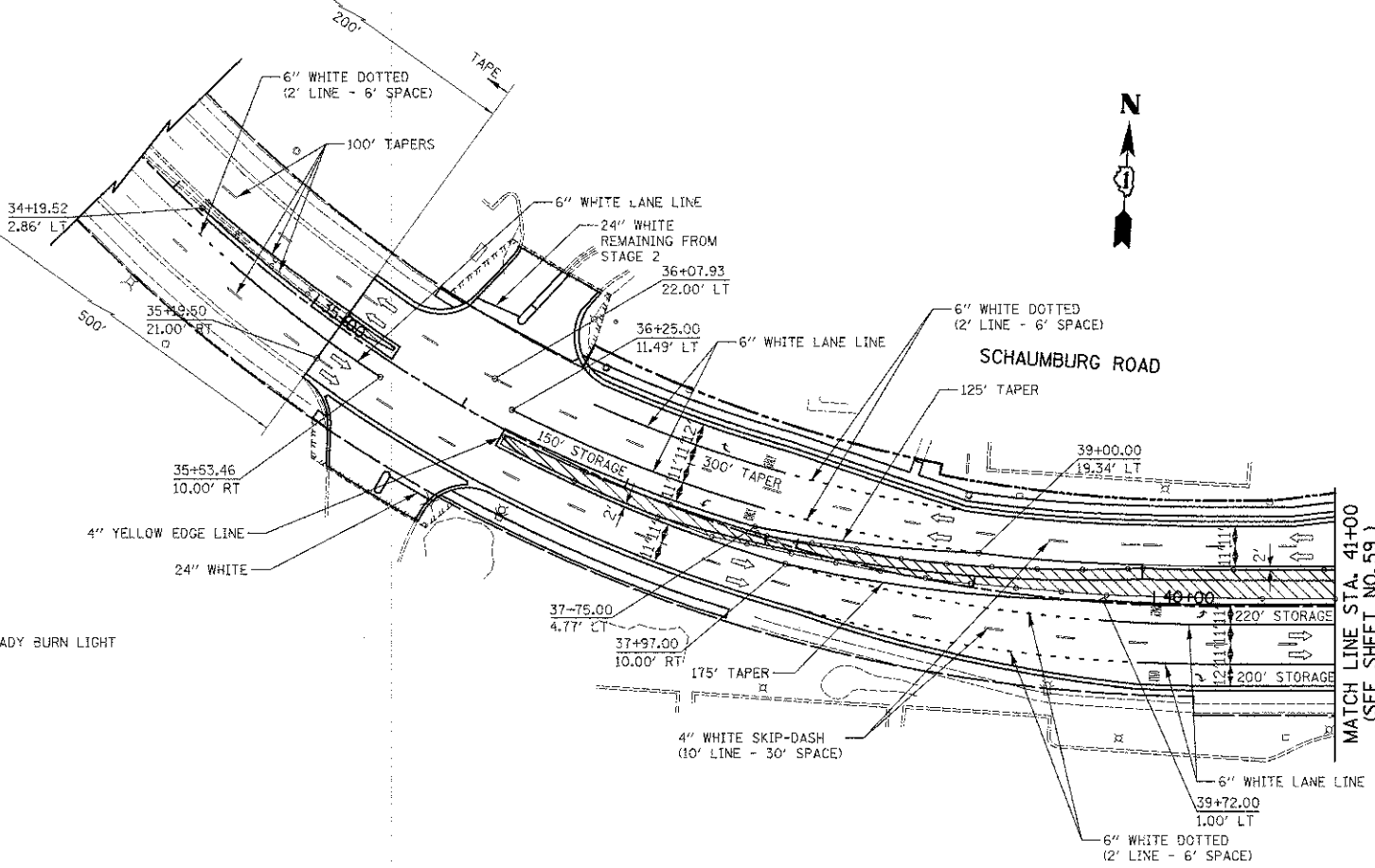

NOTE:

THE CONTRACTOR SHALL INSTALL THE PERMANENT STOP AND NO LEFT TURN SIGNS AT ALL SIDEROADS AND DRIVEWAYS AS SHOWN ON THE PERMANENT SIGNING PLAN AT THE START OF STAGE 3. IF THE CONTRACTOR CHOOSES TO INSTALL TEMPORARY SIGNS, THIS WORK SHALL BE AT THE CONTRACTORS' EXPENSE.

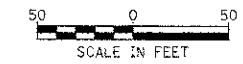
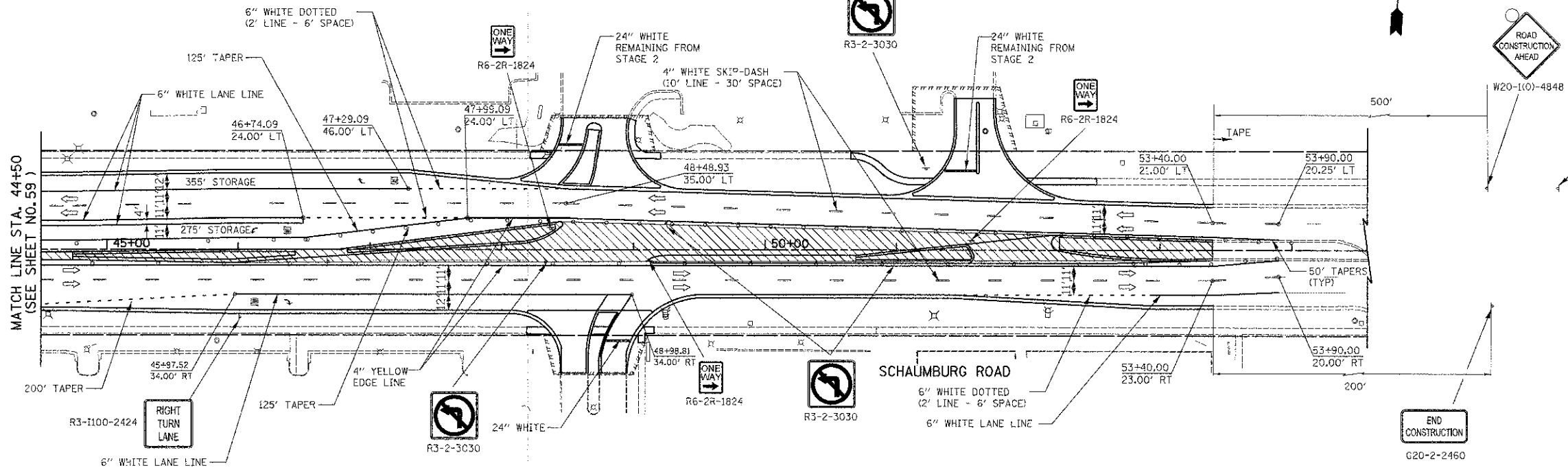

FILE NAME =	USER NAME = djk	DESIGNED - BLG	REVISED -	STATE OF ILLINOIS DEPARTMENT OF TRANSPORTATION	BARRINGTON ROAD AND SCHAUMBURG ROAD MAINTENANCE OF TRAFFIC - STAGE 3			F.A.U. R.T.E. 1322	SECTION 01-00074-00-CH	COUNTY COOK	TOTAL SHEETS 245	SHEET NO. 61
...sheet\2329\407_03_23_01.ctb		DRAWN - BLG	REVISED -		SCALE: 1" = 50'	SHEET NO. 10 OF 10 SHEETS	STA. 31+19.50 TO STA. 52+99.92	CONTRACT NO. 63629				
		CHECKED - DJK	REVISED -					FED. ROAD DIST. NO. 1 ILLINOIS FED. AID PROJECT M-CMM-6003(051)				
		DATE - 8-20-12	REVISED -									