

156 STA. 230+76.6, 49.0' LT
 CB T-C
 TYPE 24 F & G
 RIM = 829.16
 INV = 825.84 (12" S)

157 STA. 231+51.2, 7.8' LT
 FR & LIDS ADJUST SPL
 EX RIM = 829.81
 PR RIM = 830.40

158 STA. 231+51.9, 31.9' RT
 MH TO BE ADJUSTED
 EX RIM = 830.00
 PR RIM = 830.05



MATCH LINE STA. 230+50
 (SEE SHEET NO. 72)

IMPROVEMENT ENDS
 STA. 233+78.58

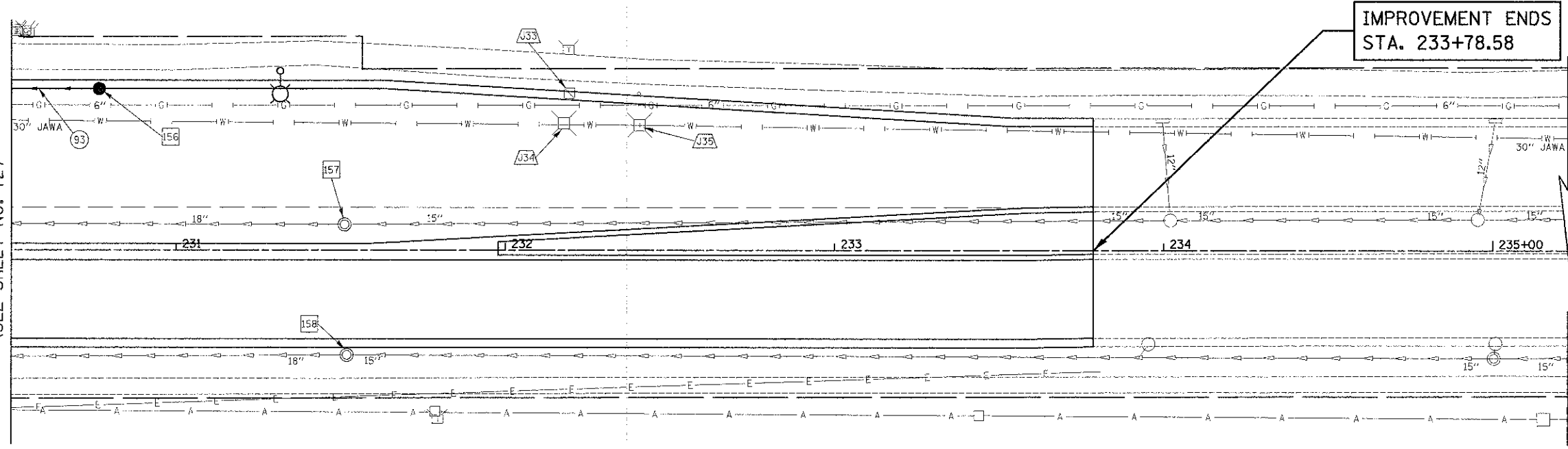

93 SEE SHEET NO. 72

- U33 JAWA HANDHOLE TO BE RELOCATED (BEHIND CURB AND GUTTER)
- U34 JAWA VALVE VAULT TO BE ADJUSTED
- U35 JAWA VALVE VAULT TO BE ADJUSTED



BARRINGTON ROAD

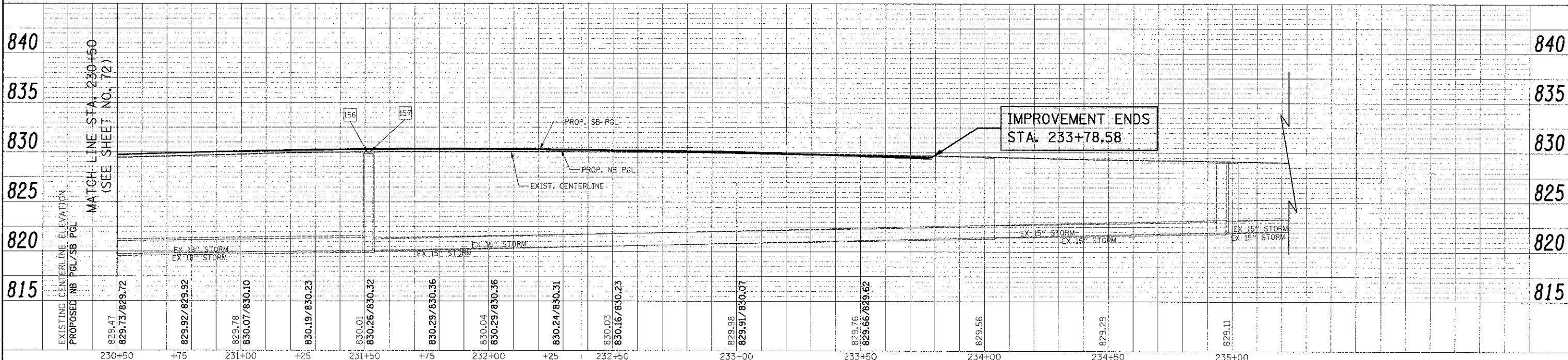

IMPROVEMENT ENDS
 STA. 233+78.58

FILE NAME = ...\2325\cad\sheet\2325_Dr_08.dgn	USER NAME = djj	DESIGNED = JAT	REVISED =	STATE OF ILLINOIS DEPARTMENT OF TRANSPORTATION	BARRINGTON ROAD DRAINAGE AND UTILITIES	F.A.U. RTE. 1322	SECTION 01-00074-00-CH	COUNTY COOK	TOTAL SHEET SHEETS: NO. 245 73
	PLST SCALE = 20.7800' / in.	CHECKED = DJK	REVISED =			SCALE: 1" = 20'	SHEET NO. 8 OF 15 SHEETS	STA. 230+50 TO STA. 233+78.58	FED. ROAD DIST. NO. 1 ILLINOIS FED. AID PROJECT M-CMM-800305D
	PLST DATE = 8/17/2012	DATE = 8-20-12	REVISED =						CONTRACT NO. 63629