

**LEGEND**

1	EXISTING SIGN
4	PROPOSED SIGN
NEW	NEW SIGN PANEL OF THE TYPE REQUIRED
REL	RELOCATE SIGN PANEL ASSEMBLY
REMAIN	SIGN PANEL TO REMAIN IN SAME LOCATION
REM	REMOVE SIGN PANEL ASSEMBLY

**NOTES:**

1. THE PROPOSED COLLAPSIBLE STOP SIGNS SHALL BE VERTICAL FOLD SIGN PANELS WITH A MANUFACTURER INSTALLED MECHANISM TO KEEP THE PANELS CLOSED WHEN NOT IN USE, AS APPROVED BY THE ENGINEER. THIS WORK SHALL BE PAID FOR AS "SIGN PANEL TYPE 1 (SPECIAL)".
2. ANY SIGNS DAMAGED DURING CONSTRUCTION SHALL BE REPLACED BY THE CONTRACTOR AT HIS EXPENSE.
3. ALL NEW SIGNS ON BARRINGTON ROAD AND HOLMES WAY SHALL BE ON TELESCOPING STEEL SIGN SUPPORTS.
4. ALL NEW SIGNS ON SCHAUMBURG ROAD SHALL BE ON METAL POST, TYPE B.
5. ALL RELOCATED SIGNS SHALL BE PLACED ON METAL POST, TYPE A.

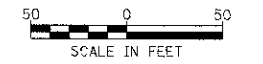
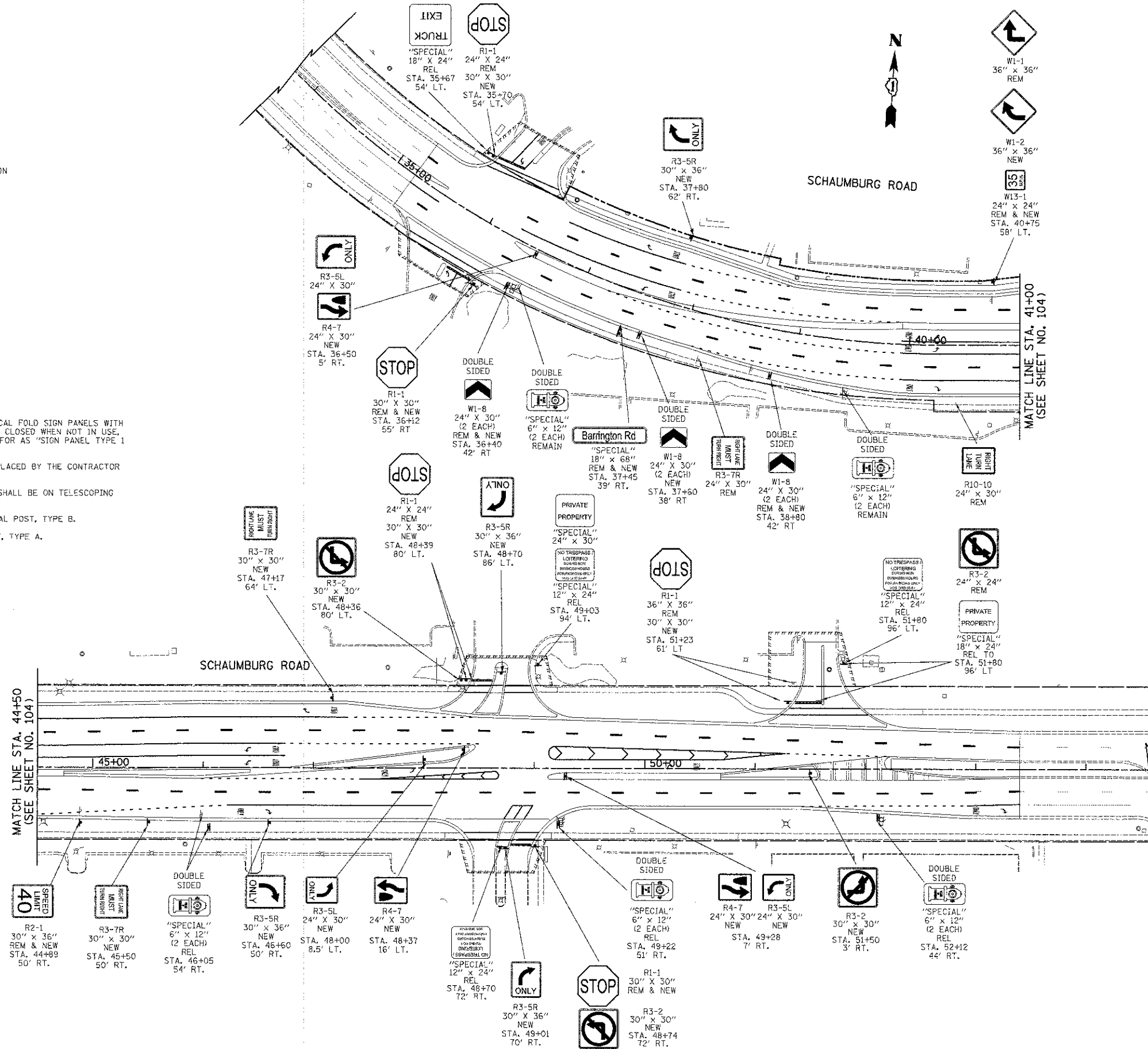

FILE NAME = ...cod\sheet\2329_SIGN_03.dgn	USER NAME = djk	DESIGNED - BLG	REVISED -	<b>STATE OF ILLINOIS DEPARTMENT OF TRANSPORTATION</b>	<b>BARRINGTON ROAD AND SCHAUMBURG ROAD SIGNING PLAN</b>	F.A.U. RTE. 1322	SECTION 01-00074-00-CH	COUNTY COOK	TOTAL SHEETS 245	SHEET NO. 106
PLOT SCALE = 50.0000' / in.	CHECKED - DJK	REVISIED -	REVISIED -			SCALE: 1" = 50'	SHEET NO. 3 OF 3 SHEETS	STA. 35+19.50 TO STA. 52+99.92	CONTRACT NO. 63629	
PLOT DATE = 8/17/2012	DATE = 8-20-12	REVISIED -	REVISIED -			FED. ROAD DIST. NO. 1 [ILLINOIS] FED. AID PROJECT M-CUM-800310512				