



CURVE DATA  
 PC = 108+91.80  
 PI = 109+06.44  
 PT = 109+20.80  
 Da = 67°24'24"  
 Dc = 72°03'50"  
 T = 14.64  
 R = 85.00  
 L = 29.00  
 C = 28.86  
 E = 1.25  
 M = 1.23

CURVE DATA  
 PC = 109+25.09  
 PI = 109+43.42  
 PT = 109+61.38  
 Da = 54°34'03"  
 Dc = 56°52'26"  
 T = 18.33  
 R = 105.00  
 L = 38.28  
 C = 36.10  
 E = 1.59  
 M = 1.56

CURVE DATA  
 PC = 109+65.28  
 PI = 109+83.58  
 PT = 110+01.54  
 Da = 54°34'03"  
 Dc = 56°52'26"  
 T = 18.33  
 R = 105.00  
 L = 38.28  
 C = 36.10  
 E = 1.59  
 M = 1.56

CURVE DATA  
 PC = 110+06.12  
 PI = 110+21.00  
 PT = 110+35.59  
 Da = 67°24'24"  
 Dc = 72°03'50"  
 T = 14.64  
 R = 85.00  
 L = 29.00  
 C = 28.86  
 E = 1.25  
 M = 1.27

REED-KEPLER PARK  
 WEST CHICAGO PARK DISTRICT  
 (OWNED BY CITY OF WEST CHICAGO)

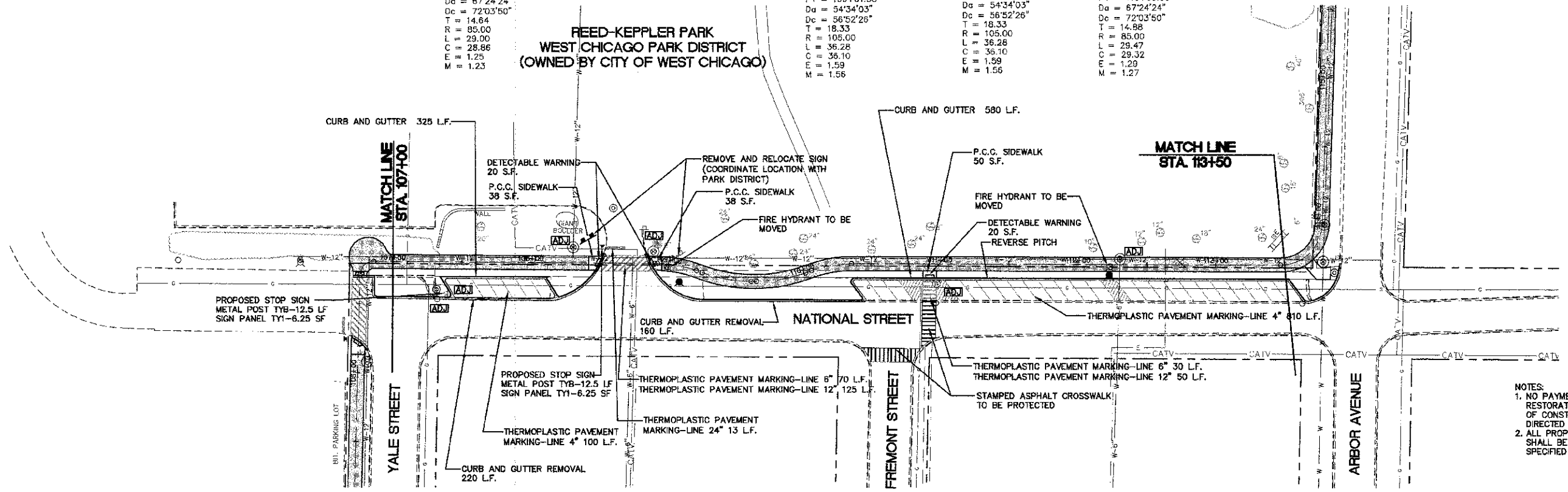

- NOTES:  
 1. NO PAYMENT WILL BE MADE FOR RESTORATION OUTSIDE THE LIMITS OF CONSTRUCTION AREA UNLESS DIRECTED BY THE ENGINEER.  
 2. ALL PROPOSED CURB AND GUTTER SHALL BE TYPE B6.12 UNLESS SPECIFIED OTHERWISE.

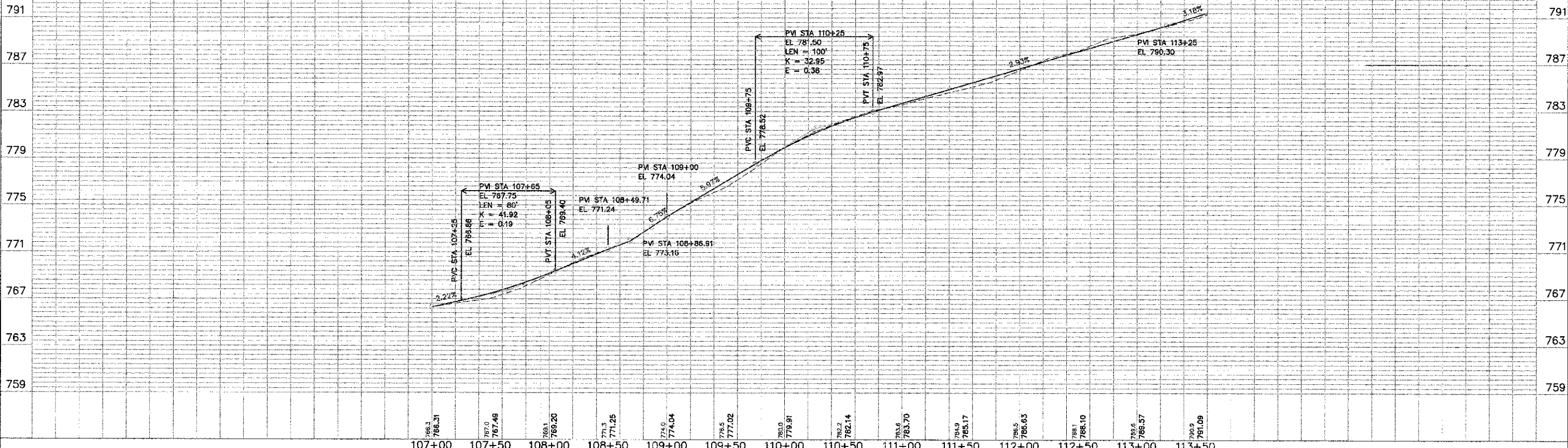
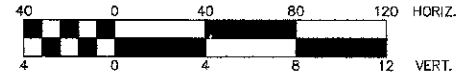

DATE	
BY	
CHECKED	
NO.	
DATE	
BY	
CHECKED	
NO.	

DATE	
BY	
CHECKED	
NO.	
DATE	
BY	
CHECKED	
NO.	

ENGINEERING RESOURCE ASSOC., INC.  
 CONSULTING ENGINEERS, SCIENTISTS & SURVEYORS  
 1530 W. 113TH ST., SUITE 150  
 WEST BURNHAM, ILL. 60491  
 PHONE (630) 393-3460 FAX (630) 393-3152

FILE NAME =	H:\West Chicago\100810.00 Bkx Trail
CONNECTOR	CA00\Final Design\RCp02003.dwg
USER NAME	artanner
DESIGNED	BD
DRAWN	RT
CHECKED	JFM
DATE	APRIL, 2012
REVISED	04-14-2013
REVISOR	
REVISION	
REVISION	
REVISION	

PLOT SCALE =	
PLOT DATE =	1/14/2013

STATE OF ILLINOIS	
DEPARTMENT OF TRANSPORTATION	
SCALE: H=40H/V=4V	SHEET NO. 2 OF 7 SHEETS

NATIONAL STREET	
PLAN AND PROFILE	
STA. 107+00 TO STA. 113+50	

F.A. RTE.	SECTION	COUNTY	TOTAL SHEETS	SHEET NO.
	00-00064-00-BT	DUPAGE	31	10
				CONTRACT NO. 63730
FED. ROAD DIST. NO. 1   ILLINOIS FED. AID PROJECT				