

PROP. CURVE CL131-1
 PI STA. = 229+83.20
 $\Delta = 3^\circ 39' 42''$ (L.T.)
 $D = 0^\circ 30' 00''$
 $R = 11,460.00'$
 $T = 366.31'$
 $L = 732.36'$
 $E = 5.85'$
 $\theta = NC$
 P.C. STA. = 226+16.90
 P.T. STA. = 233+49.26

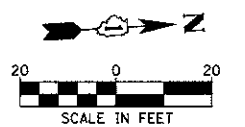

NOTE: THE GENERAL CONTRACTOR IS REQUIRED TO HIRE AN ENVIRONMENTAL FIRM WITH AT LEAST FIVE (5) DOCUMENTED LEAKING UNDERGROUND STORAGE TANK CLEANUPS OR THAT IS PRE-QUALIFIED IN HAZARDOUS WASTE BY THE ILLINOIS DEPARTMENT OF TRANSPORTATION TO REMEDIATE THE SOIL CONTAMINATION AND MONITOR FOR WORKER PROTECTION.

04-30-300-013
 04-30-300-016
 HJORTNESS

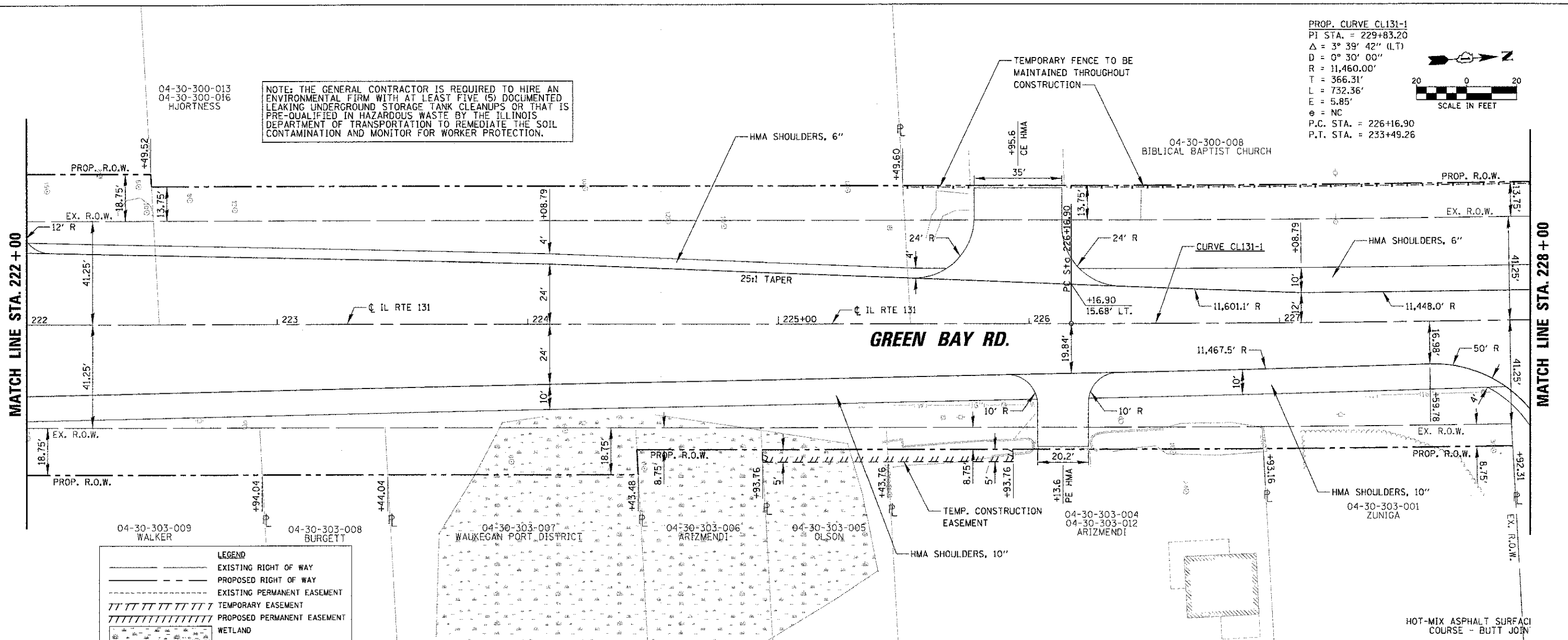

LEGEND

	EXISTING RIGHT OF WAY
	PROPOSED RIGHT OF WAY
	EXISTING PERMANENT EASEMENT
	TEMPORARY EASEMENT
	PROPOSED PERMANENT EASEMENT
	WETLAND

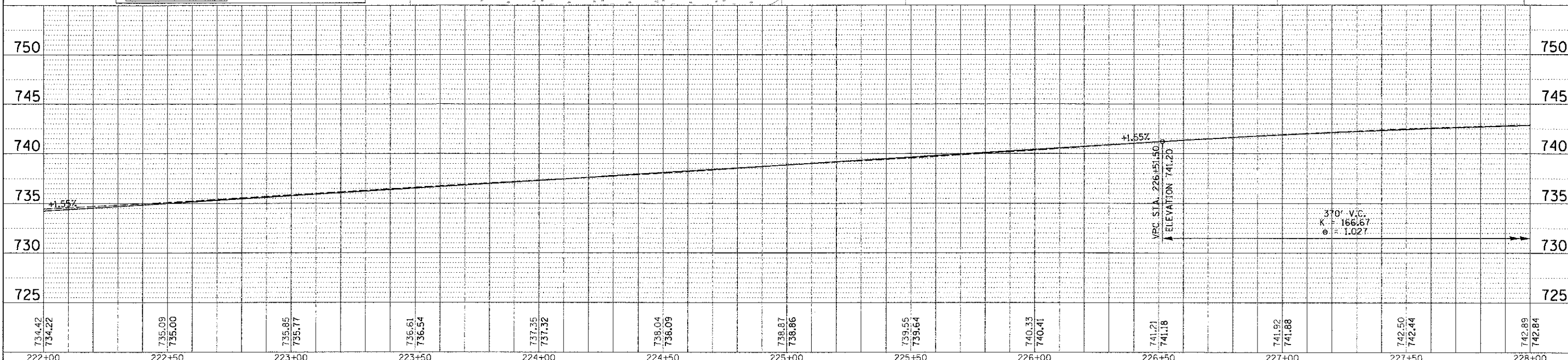

734.42	735.09	735.85	736.61	737.35	738.04	738.87	739.55	740.33	741.21	741.92	742.50	742.89
734.22	735.00	735.77	736.54	737.32	738.09	738.86	739.64	740.41	741.18	741.88	742.44	742.84
222+00	222+50	223+00	223+50	224+00	224+50	225+00	225+50	226+00	226+50	227+00	227+50	228+00

PLAN

DATE	BY
DESIGNED	BY
CHECKED	BY
DATE	BY

PROFILE

DATE	BY
DESIGNED	BY
CHECKED	BY
DATE	BY

STATE OF ILLINOIS
 DEPARTMENT OF TRANSPORTATION

IL RTE 131 (GREEN BAY ROAD)
 ROADWAY PLAN AND PROFILE
 STA. 222+00.00 TO STA. 228+00.00

F.A.U. RTE.	SECTION	COUNTY	TOTAL SHEETS	SHEET NO.
1209	03-00033-12-CH	LAKE	189	43
CONTRACT NO. 63766			FED. ROAD DIST. NO. 1 ILLINOIS FED. AID PROJECT	

SCALE: SHEET NO. OF SHEETS STA. TO STA.