

NOTE: THE GENERAL CONTRACTOR IS REQUIRED TO HIRE AN ENVIRONMENTAL FIRM WITH AT LEAST FIVE (5) DOCUMENTED LEAKING UNDERGROUND STORAGE TANK CLEANUPS OR THAT IS PRE-QUALIFIED IN HAZARDOUS WASTE BY THE ILLINOIS DEPARTMENT OF TRANSPORTATION TO REMEDIATE THE SOIL CONTAMINATION AND MONITOR FOR WORKER PROTECTION.

STRUCTURE NO.	STRUCTURE TYPE	STATION	OFFSET	RIM	INV (N)	INV (S)	INV (W)	INV (E)
S1301	CB, TYPE A, 4', TYPE 24 F&G	178+15	33.0 LT	726.22		721.80		
S1302	CB, TYPE A, 4', TYPE 24 F&G	178+15	33.0 RT	726.22	721.50	721.40		
S1303	CB, TYPE A, 5', TYPE 8 GRATE	178+15	40.6 RT	726.75	721.35		719.20	719.30
S1304	CB, TYPE A, 4', TYPE 24 F&G	180+15	62.0 LT	728.87				724.80
S1305	CB, TYPE A, 4', TYPE 24 F&G	181+00	33.0 LT	729.10			725.10	
S1306	CB, TYPE A, 4', TYPE 24 F&G	180+38	38.3 LT	728.78			724.70	724.80
S1307	CB, TYPE A, 4', TYPE 24 F&G	180+28	46.7 LT	728.69			724.35	724.60
S1308	CB, TYPE A, 4', TYPE 24 F&G	180+22	53.2 RT	729.02				724.77
S1309	CB, TYPE A, 4', TYPE 24 F&G	181+00	33.0 RT	729.10			724.85	
S1310	CB, TYPE A, 4', TYPE 24 F&G	180+50	36.6 RT	728.92			725.40	
S1311	MH, TYPE A, 5', TYPE 24 F&G	180+38	41.6 RT	728.87	725.30		723.27	723.37

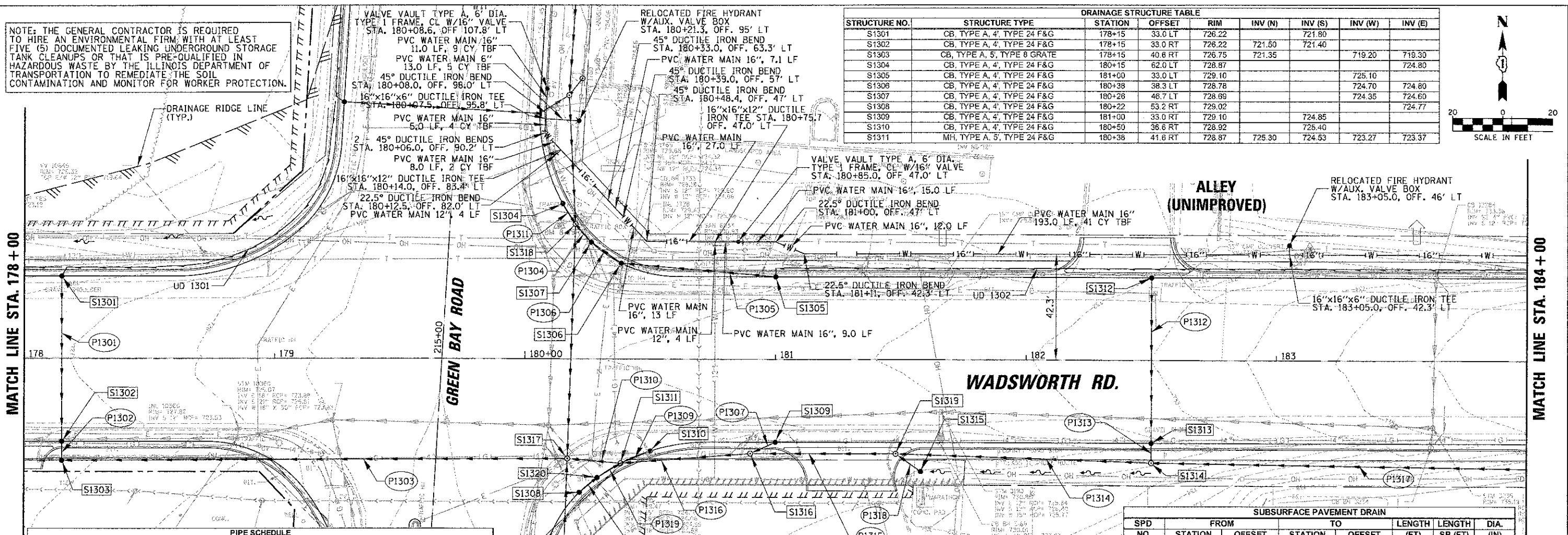
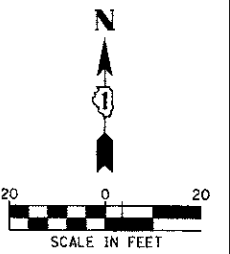

PIPE NO.	FROM	TO	LENGTH (FT)	DIA. (IN)	PIPE TYPE	SLOPE (%)	TBF (CY)
P1301	S1301	S1302	66	12	WATER MAIN QUALITY	0.45	14.2
P1302	S1302	S1303	8	12	SS CLASS A TYPE 2	0.62	2.1
P1303	S1317	S1303	199	36	SS CLASS A TYPE 2	0.85	105.2
P1304	S1307	S1318	10	12	SS CLASS A TYPE 1	0.50	1.3
P1305	S1305	S1306	62	12	WATER MAIN QUALITY	0.45	8.2
P1306	S1306	S1307	15	12	WATER MAIN QUALITY	0.67	2.4
P1307	S1309	S1316	10	12	WATER MAIN QUALITY	1.00	2.6
P1308	S1308	S1320	9	12	WATER MAIN QUALITY	0.78	1.6
P1309	S1310	S1311	13	12	WATER MAIN QUALITY	0.78	2.4
P1310	S1311	S1317	11	18	WATER MAIN QUALITY	1.36	2.0
P1311	S1304	S1318	9	12	SS CLASS A TYPE 1	0.56	1.4
P1312	S1312	S1313	66	12	WATER MAIN QUALITY	0.53	13.5
P1313	S1313	S1314	8	15	SS CLASS A TYPE 2	1.25	2.3
P1314	S1314	S1319	100	15	SS CLASS A TYPE 1	1.75	5.4
P1315	S1319	S1316	56	15	WATER MAIN QUALITY	0.89	21.6
P1316	S1316	S1311	50	18	WATER MAIN QUALITY	1.40	11.1
P1317	S1410	S1314	200	12	SS CLASS A TYPE 1	2.13	0.0
P1318	S1315	S1319	11	12	WATER MAIN QUALITY	1.36	2.2
P1319	S1320	S1311	9	12	WATER MAIN QUALITY	0.78	2.4

SPD NO.	FROM STATION	TO STATION	LENGTH (FT)	LENGTH SP (FT)	DIA. (IN)
1301	179+24.21	102.71 LT	178+17.00	36.58 LT	147
1302	186+00.00	35.55 LT	181+00.00	36.58 LT	500

STRUCTURE NO.	STRUCTURE TYPE	STATION	OFFSET	RIM	INV (N)	INV (S)	INV (W)	INV (E)
S1312	CB, TYPE A, 4', TYPE 24 F&G	182+50	33.0 LT	731.76		727.40		
S1313	CB, TYPE A, 4', TYPE 24 F&G	182+50	33.0 RT	731.76	727.05	726.80		
S1314	MH, TYPE A, 4', TYPE 1, CL	182+50	40.9 RT	732.25			726.60	726.85
S1315	CB, TYPE A, 4', TYPE 8 GRATE	181+58	44.6 RT	729.47			727.00	
S1316	MH, TYPE A, 5', TYPE 1, CL	180+90	37.5 RT	729.37	724.75		724.00	724.25
S1317	MH, TYPE A, 6', TYPE 1, CL	180+17	39.8 RT	729.25	721.14	723.30	721.00	723.05
S1318	MH, TYPE A, 6', TYPE 1, CL	180+20	53.9 LT	728.79	721.70	721.60	724.75	724.30
S1319	MH, TYPE A, 4', TYPE 1, CL	181+48	37.5 RT	729.80		726.85	724.75	724.85
S1320	CB, TYPE A, 4', TYPE 24 F&G	180+29	47.3 RT	728.95			724.70	724.60

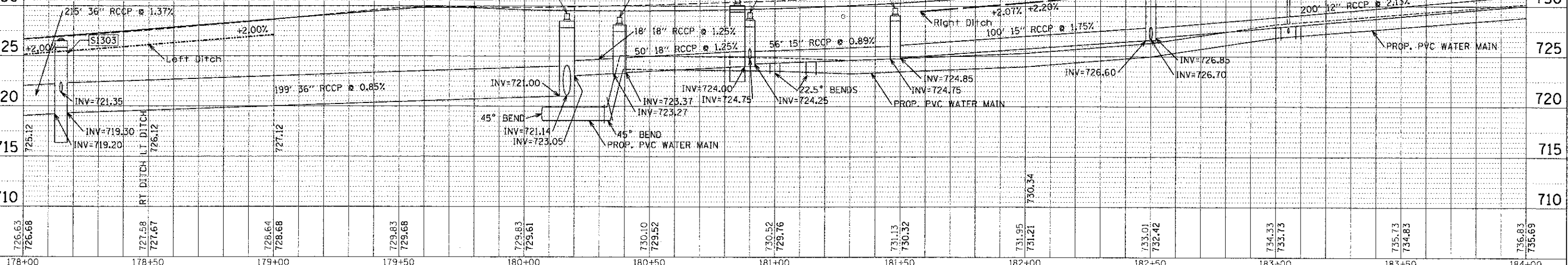

DATE	
BY	
REVIEWED	
APPROVED	
NOTED	
NO.	

DATE	
BY	
REVIEWED	
APPROVED	
NOTED	
NO.	