

DRAINAGE STRUCTURE TABLE								
STRUCTURE NO.	STRUCTURE TYPE	STATION	OFFSET	RIM	INV (N)	INV (S)	INV (W)	INV (E)
S301	CB, TYPE A, 4' TYPE 24 F&G	212+50	33.0 LT	730.82				726.55
S302	CB, TYPE A, 4' TYPE 24 F&G	212+50	45.0 RT	730.46			726.15	726.05
S303	MH, TYPE A, 4' TYPE 1, CL	212+50	55.0 RT	731.00	725.50		726.00	
S304	CB, TYPE A, 4' TYPE 24 F&G	213+50	33.0 LT	730.13				725.85
S305	CB, TYPE A, 4' TYPE 24 F&G	213+50	45.0 RT	729.77	725.45	725.45	725.45	725.35
S306	MH, TYPE A, 5' TYPE 1, CL	213+50	55.0 RT	730.50	724.40	724.50	725.25	
S307	CB, TYPE A, 4' TYPE 24 F&G	213+20	45.0 RT	729.97	725.75			

NOTE: THE GENERAL CONTRACTOR IS REQUIRED TO HIRE AN ENVIRONMENTAL FIRM WITH AT LEAST FIVE (5) DOCUMENTED LEAKING UNDERGROUND STORAGE TANK CLEANUPS OR THAT IS PRE-QUALIFIED IN HAZARDOUS WASTE BY THE ILLINOIS DEPARTMENT OF TRANSPORTATION TO REMEDIATE THE SOIL CONTAMINATION AND MONITOR FOR WORKER PROTECTION.

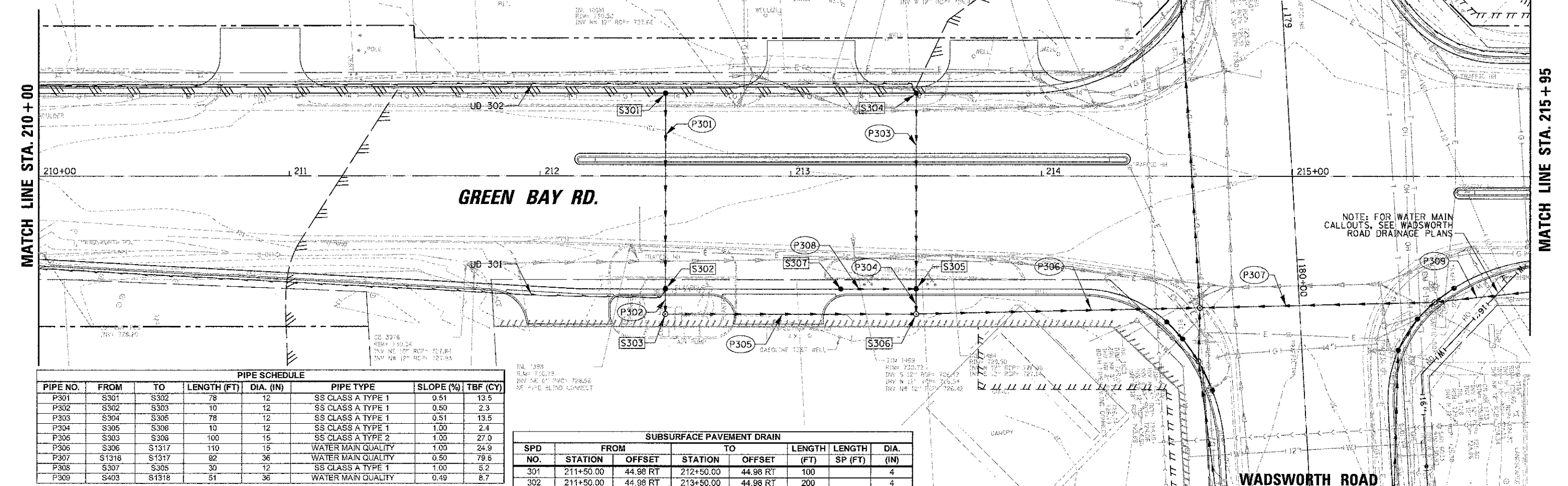

NOTE: FOR WATER MAIN CALLOUTS, SEE WADSWORTH ROAD DRAINAGE PLANS

PIPE SCHEDULE							
PIPE NO.	FROM	TO	LENGTH (FT)	DIA. (IN)	PIPE TYPE	SLOPE (%)	TBF (CY)
P301	S301	S302	78	12	SS CLASS A TYPE 1	0.51	13.5
P302	S302	S303	10	12	SS CLASS A TYPE 1	0.50	2.3
P303	S304	S306	78	12	SS CLASS A TYPE 1	0.51	13.5
P304	S305	S306	10	12	SS CLASS A TYPE 1	1.00	2.4
P305	S303	S306	100	15	SS CLASS A TYPE 2	1.00	27.0
P306	S306	S1317	110	15	WATER MAIN QUALITY	1.00	24.9
P307	S1318	S1317	92	36	WATER MAIN QUALITY	0.50	79.6
P308	S307	S305	30	12	SS CLASS A TYPE 1	1.00	5.2
P309	S403	S1318	51	36	WATER MAIN QUALITY	0.49	8.7

SUBSURFACE PAVEMENT DRAIN								
SPD NO.	FROM STATION	TO STATION	LENGTH (FT)	LENGTH SP (FT)	DIA. (IN)			
301	211+50.00	212+50.00	100		4			
302	211+50.00	213+50.00	200		4			

