

DATE: \_\_\_\_\_ BY: \_\_\_\_\_  
 CHECKED: \_\_\_\_\_  
 DATE: \_\_\_\_\_ BY: \_\_\_\_\_  
 CHECKED: \_\_\_\_\_  
 DATE: \_\_\_\_\_ BY: \_\_\_\_\_  
 CHECKED: \_\_\_\_\_

CHRISTOPHER B. BURKE ENGINEERING LTD.  
 3000 S. WADSWORTH ROAD, SUITE 600  
 ROSEMOUNT, ILLINOIS 60018  
 (847) 823-0500

**CONSTRUCTION NOTES:**

- ① THE TRAFFIC SIGNAL CONTROLLER SHALL BE NTCIP COMPATIBLE.
- ② THE FINAL LOCATIONS OF ALL MAST ARM FOUNDATIONS WILL BE DETERMINED IN THE FIELD AFTER ALL UTILITY LOCATES HAVE BEEN PERFORMED. MAST ARMS SHALL NOT BE ORDERED UNTIL THE FOUNDATION LOCATION HAS BEEN VERIFIED AND THE FINAL LENGTH OF MAST ARM DETERMINED.

**TRAFFIC SIGNAL LEGEND**

- |  |  |          |  |
|--|--|----------|--|
| CONTROLLER CABINET   |  | EXISTING |  |
| SERVICE INSTALLATION   |  |          |  |
| SIGNAL HEAD  |  |          |  |
| SIGNAL HEAD WITH BACKPLATE   |  |          |  |
| PEDESTRIAN SIGNAL HEAD   |  |          |  |
| SIGNAL POST  |  |          |  |
| STEEL MAST ARM ASSEMBLY AND POLE   |  |          |  |
| ALUMINUM MAST ARM ASSEMBLY AND POLE  |  |          |  |
| STEEL COMBINATION MAST ARM ASSEMBLY AND POLE WITH LUMINAIRE  |  |          |  |
| UNIT DUCT  |  |          |  |
| CONDUIT SPLICE   |  |          |  |
| HANDHOLE   |  |          |  |
| HEAVY DUTY HANDHOLE  |  |          |  |
| DOUBLE HANDHOLE  |  |          |  |
| G.S. CONDUIT IN GROUND (CIG)   |  |          |  |
| PEDESTRIAN PUSHBUTTON DETECTOR   |  |          |  |
| PEDESTRIAN PUSHBUTTON SIGN   |  |          |  |
| DETECTOR LOOP  |  |          |  |
| EMERGENCY VEHICLE LIGHT DETECTOR   |  |          |  |
| CONFIRMATION BEACON  |  |          |  |
| SIGNAL HEAD OPTICALLY PROGRAMMED   |  |          |  |
| RAILROAD CONTROL CABINET   |  |          |  |
| VIDEO DETECTION CAMERA   |  |          |  |
| PAN, TILT, ZOOM CAMERA   |  |          |  |
| APPROXIMATE DETECTION ZONE   |  |          |  |
| STREET NAME SIGN   |  |          |  |
| ABANDON  |  |          |  |
| COMBINATION CURB AND GUTTER REMOVAL AND COMBINATION CONCRETE CURB & GUTTER, TYPE B-6.24 (DEPRESSED CURB) |  |          |  |
| P.C.C. SIDEWALK 5"   |  |          |  |
| BITUMINOUS SHOULDER REMOVAL AND P.C.C. SIDEWALK, 5"  |  |          |  |
| VIDEO COMMUNICATIONS CABINET   |  |          |  |
| TELEPHONE DROP   |  |          |  |
| UNINTERRUPTIBLE POWER SUPPLY   |  |          |  |

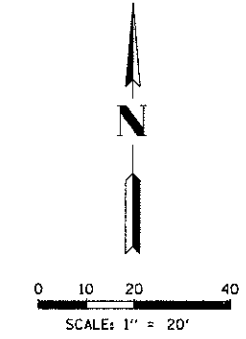

NOTE: THE GENERAL CONTRACTOR IS REQUIRED TO HIRE AN ENVIRONMENTAL FIRM WITH AT LEAST FIVE (5) DOCUMENTED LEAKING UNDERGROUND STORAGE TANK CLEANUPS OR THAT IS PRE-QUALIFIED IN HAZARDOUS WASTE BY THE ILLINOIS DEPARTMENT OF TRANSPORTATION TO REMEDIATE THE SOIL CONTAMINATION AND MONITOR FOR WORKER PROTECTION.

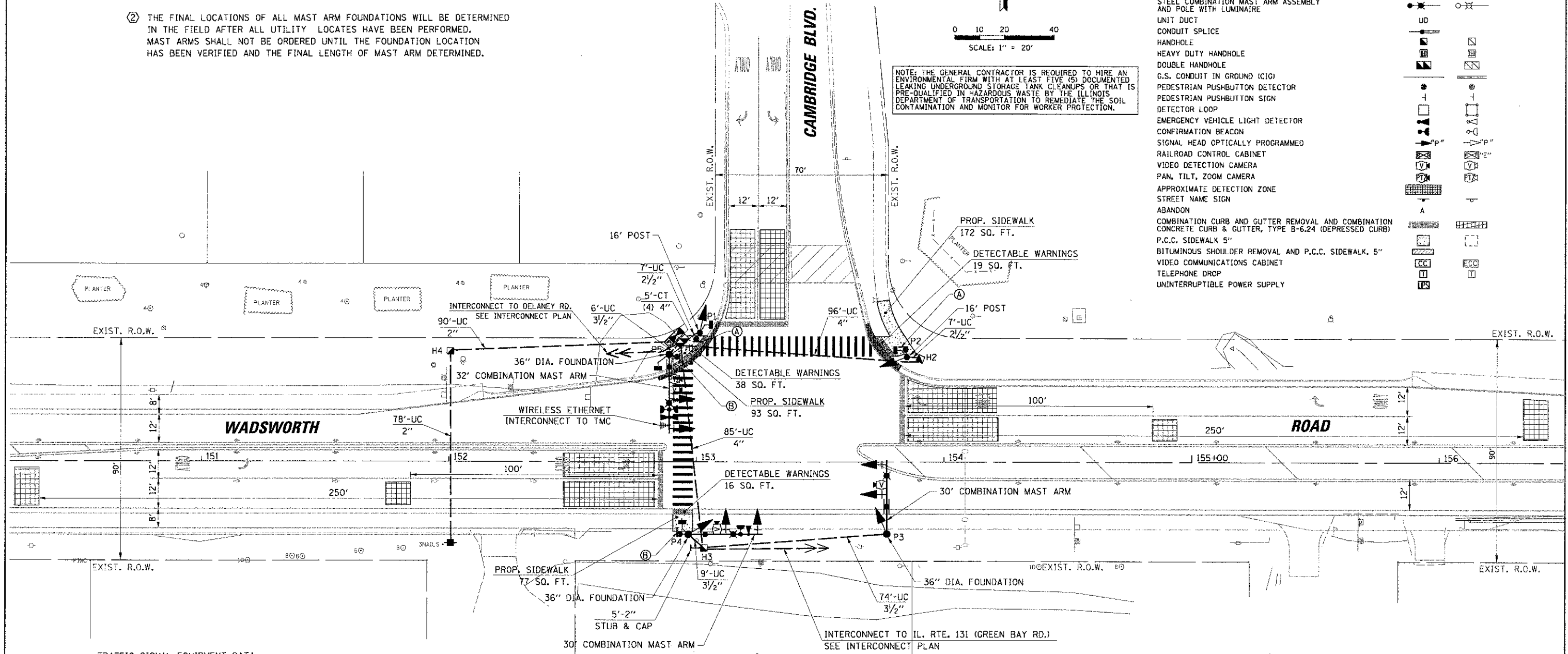

**TRAFFIC SIGNAL EQUIPMENT DATA**

WADSWORTH ROAD			
ITEM	STATIONING	OFFSET	POSSIBLE UTILITY CONFLICT
P5	152+88.88	43.46' LT	-
H1	152+94.16	48.87' LT	-
P4	152+96.71	29.24' RT	COMED
H4	152+00.48	44.66' LT	WATERMAIN
H3	153+03.23	34.89' RT	-
P1	153+01.22	52.21' LT	-
P3	153+76.88	29.00' RT	COMED
P2	153+86.67	43.00' LT	STORM
H2	153+90.37	41.75' LT	WATERMAIN

NOTE: THE TRAFFIC SIGNAL CONTROLLER EQUIPMENT FOR THIS PROJECT SHALL BE "ECONOLITE" TO MATCH THE EXISTING ADJACENT SYSTEM.

