

PROFILE: SEARCHED _____
 PHOTO: CHECKED _____
 PLAN: REVIEWED _____
 STRUCTURE: ASSESSED _____
 NO. _____
 DATE: _____
 BY: _____
 CHECKED: _____
 DATE: _____
 FILE NAME: _____

PLAN
 30% BOOK
 NO. _____
 DATE: _____
 FILE NAME: _____

CHRISTOPHER B. BURKE
 ENGINEERING LTD.
 9575 West Higgins Road, Suite 600
 Rosemont, Illinois 60018
 (847) 823-0600
 CBB
 ELL

PANEL DESIGN TYPE 1

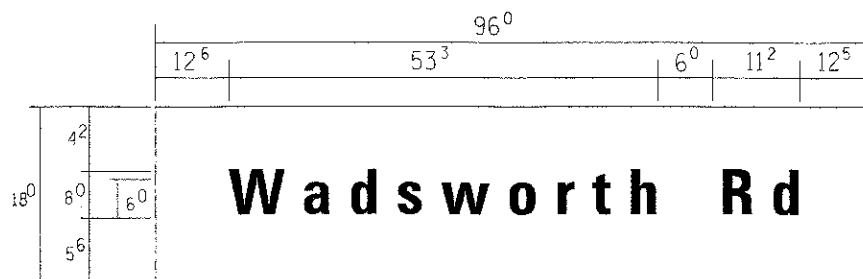

ALL DIMENSIONS SHOWN IN INCHES

12.0 SQ. FT. EACH

1 REQUIRED
 SINGLE SIDED REQUIRED
 DOUBLE SIDED REQUIRED
 DESIGN SERIES D

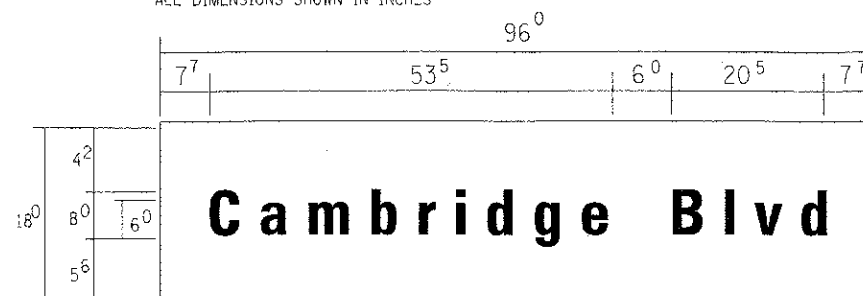

ALL DIMENSIONS SHOWN IN INCHES

12.0 SQ. FT. EACH

2 REQUIRED
 SINGLE SIDED REQUIRED
 DOUBLE SIDED REQUIRED
 DESIGN SERIES D

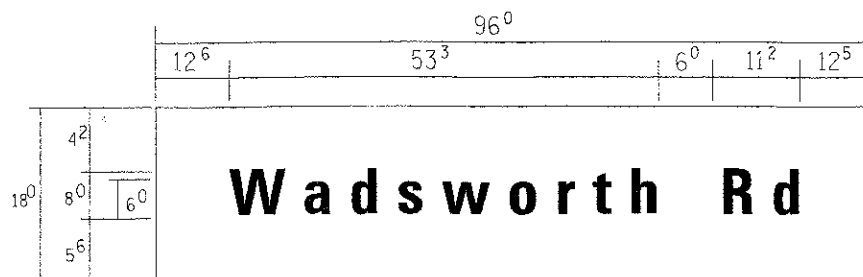

ALL DIMENSIONS SHOWN IN INCHES

12.0 SQ. FT. EACH

2 REQUIRED
 SINGLE SIDED REQUIRED
 DOUBLE SIDED REQUIRED
 DESIGN SERIES D

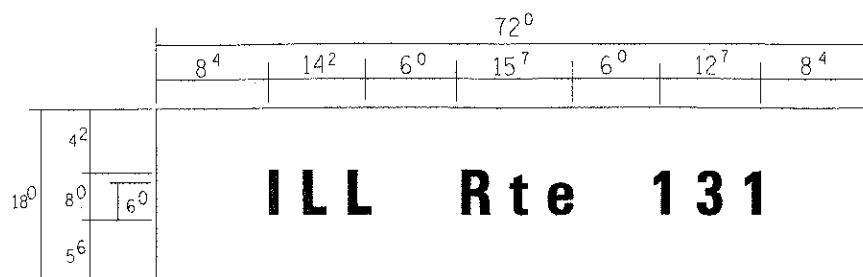

ALL DIMENSIONS SHOWN IN INCHES

9.0 SQ. FT. EACH

2 REQUIRED
 SINGLE SIDED REQUIRED
 DOUBLE SIDED REQUIRED
 DESIGN SERIES D

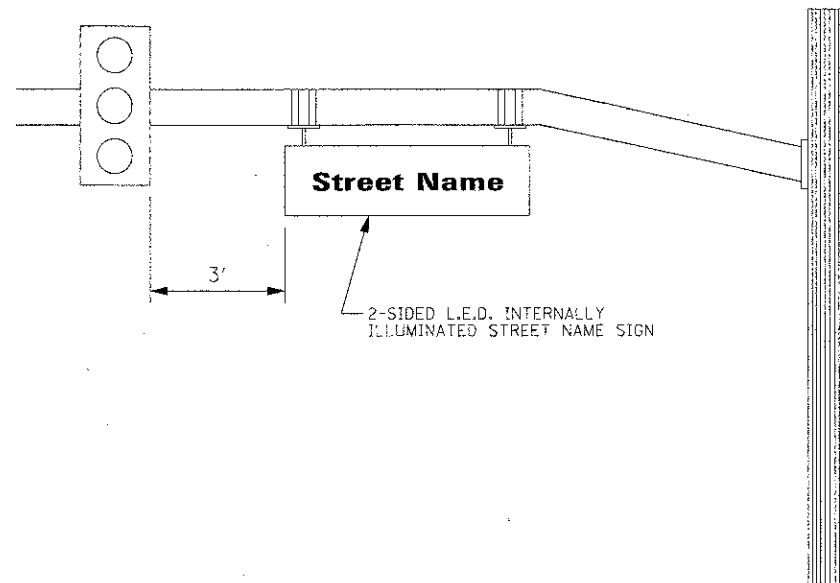

NOTE: L.E.D. ILLUMINATED
 STREET NAME SIGNS
 AVAILABLE ONLY IN
 2 FOOT INCREMENTS

REVISIONS / REMARKS				SCALE: NONE		DATE: 5/22/08		DESIGNED BY: JPS	
								CHECKED BY: JPN	
NO.	DESCRIPTION	DATE	BY	SURVEYOR:		ROUTE	SECTION	SECTION NUMBER	SHEET
		/ /		DSGNR/LIAISON:					
		/ /		PLOTTER:					
				PLOT DATE: 11/13/2012					
						MAST ARM MOUNTED STREET NAME SIGNS			
				STATE OF ILLINOIS DEPARTMENT OF TRANSPORTATION		MAST ARM MOUNTED STREET NAME SIGNS			
				FILE NAME: N:\DOT\04229\Traffic\2011\STN_04229.dwg USER NAME: rmorel PLOT SCALE: 1/20 PLOT DATE: 11/13/2012		F.A.U. RTE: 1209 SECTION: 03-00033-12-CH COUNTY: LAKE TOTAL SHEETS: 189 SHEET NO.: 125		CONTRACT NO. 63766	
				SCALE: _____ SHEET NO. _____ OF _____ SHEETS STA. _____ TO STA. _____		FED. ROAD DIST. NO. 1 ILLINOIS FED. AID PROJECT			