

STONINGTON AVENUE

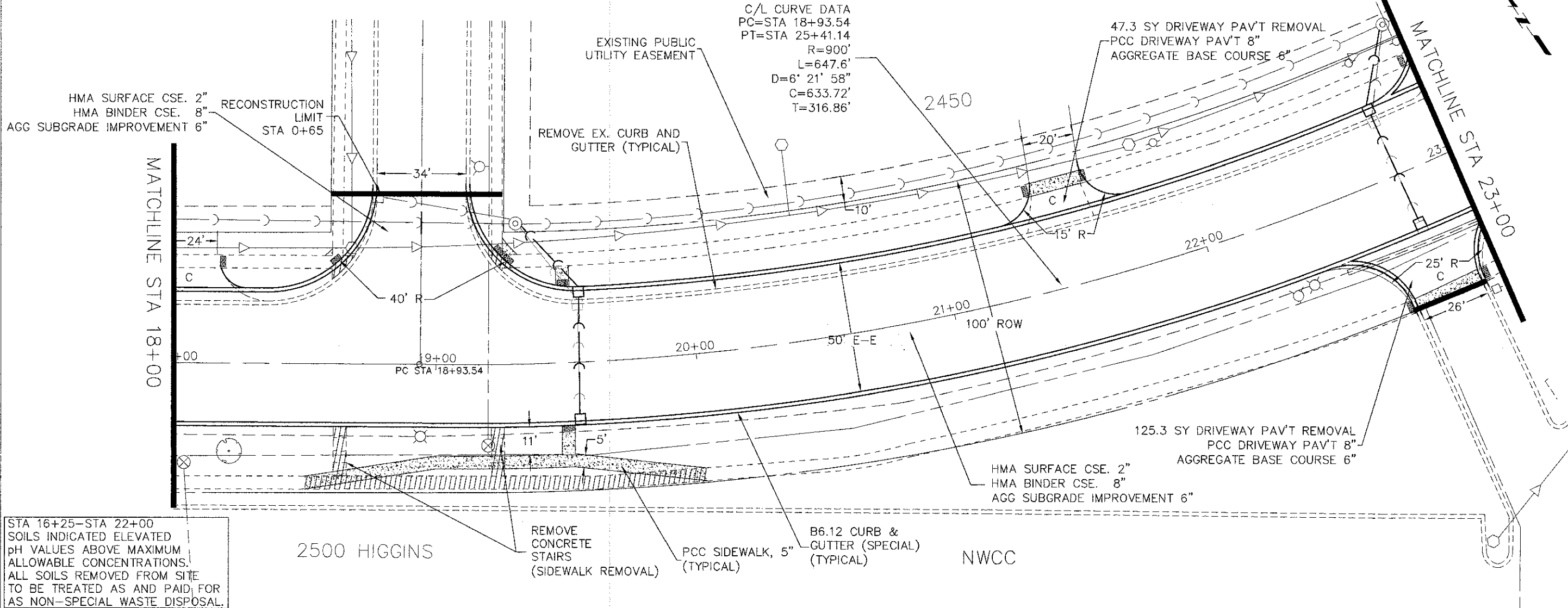

STA 16+25-STA 22+00
SOILS INDICATED ELEVATED
pH VALUES ABOVE MAXIMUM
ALLOWABLE CONCENTRATIONS.
ALL SOILS REMOVED FROM SITE
TO BE TREATED AS AND PAID FOR
AS NON-SPECIAL WASTE DISPOSAL.

2500 HIGGINS

NWCC

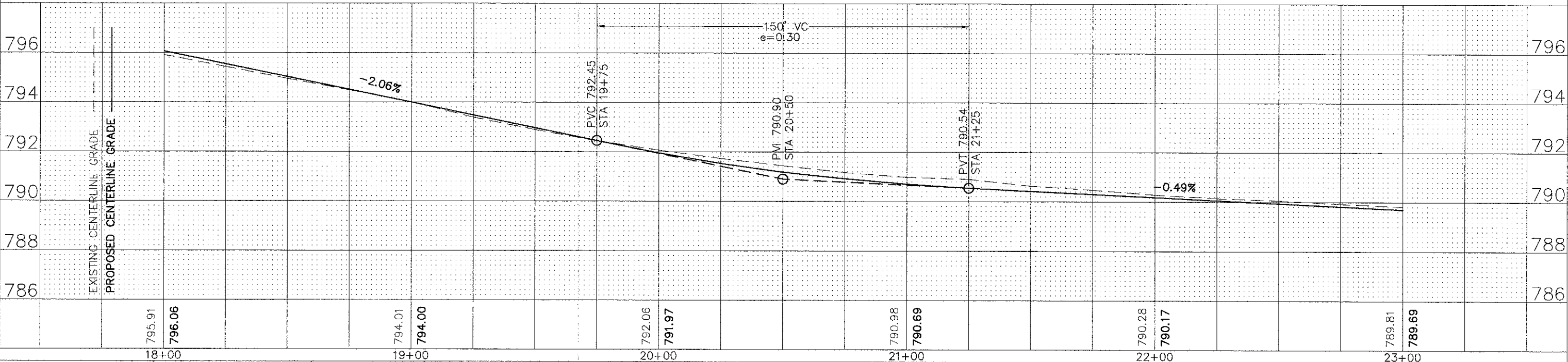

PLAN	DATE	BY
DESIGNED		
DRAWN		
CHECKED		
DATE		

PROFILE	DATE	BY
DESIGNED		
DRAWN		
CHECKED		
DATE		

FILE NAME =	DESIGNED -	REVISED -
Hassell Plan-Profile.dwg	DRAWN -	REVISED -
	CHECKED -	REVISED -
	DATE -	REVISED -

18+00	19+00	20+00	21+00	22+00	23+00
795.91	794.01	792.06	790.98	790.28	789.81
796.06	794.00	791.97	790.69	790.17	789.69

STATE OF ILLINOIS
DEPARTMENT OF TRANSPORTATION

Hassell Road STP Project
Plan and Profile

SCALE: 1" = 20' SHEET NO. 3 OF 16 SHEETS STA. 18+00 TO STA 23+00

F.A.U. RTE.	SECTION	COUNTY	TOTAL SHEETS	SHEET NO.
1100	11-00087-00-FP	Cook	164	17
CONTRACT NO. 63770			ILLINOIS FED. AID PROJECT CMM 9003(757)	