

NUMBER	LOCATION	MOUNT	EXISTING/PROPOSED	DESCRIPTION	PRIMARY SIGN			SECONDARY SIGN				
					MUTCD	W	H	EXISTING/PROPOSED	DESCRIPTION	MUTCD	W	H
26	28+21L	NEW POST	PROPOSED	BICYCLE	W11-1	30	30	PROPOSED	SHARE THE ROAD	W16-1P	18	24
27	29+00R	NEW POST	PROPOSED	VILLAGE HALL 0.7	DI-2C	30	6	PROPOSED	TRIPHAN CENTER 1.4	DI-2C	30	6
28	29+58L	NEW POST	PROPOSED	BIKE LANE	R3-17	24	18	PROPOSED	ROSELLE RD TRL 3.2	DI-2C	30	6
29	30+33L	NEW POST	PROPOSED	TWO-WAY LEFT TURN ONLY	R3-9b	24	36	PROPOSED	ENDS	M4-6	12	6
30	30+70R	EX. POST	MAINTAIN EXISTING	SPEED LIMIT 30	R2-1	30	24	PROPOSED	TWO-WAY LEFT TURN ONLY	R3-9b	24	36
31	32+14R	NEW POST	PROPOSED	BIKE LANE	R3-17	24	18					
32	34+17L	NEW POST	PROPOSED	POPLAR CREEK TRL 0.8	DI-2C	30	6					
33	36+00R	NEW POST	PROPOSED	BIKE LANE	R3-17	24	18					
34	37+44L	EX. POST	MAINTAIN EXISTING	SPEED LIMIT 30	R2-1	30	24					

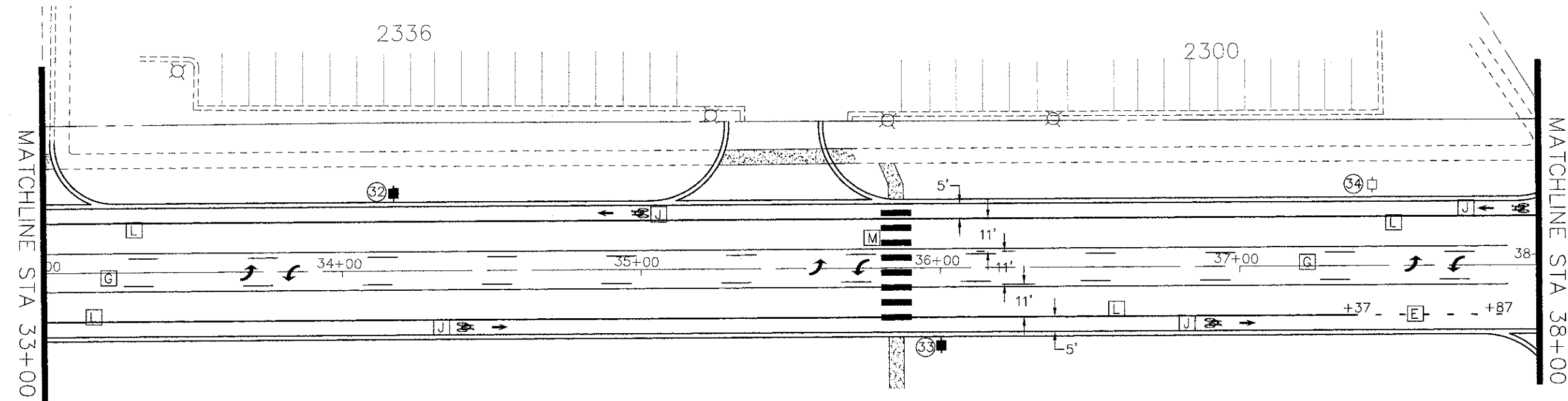
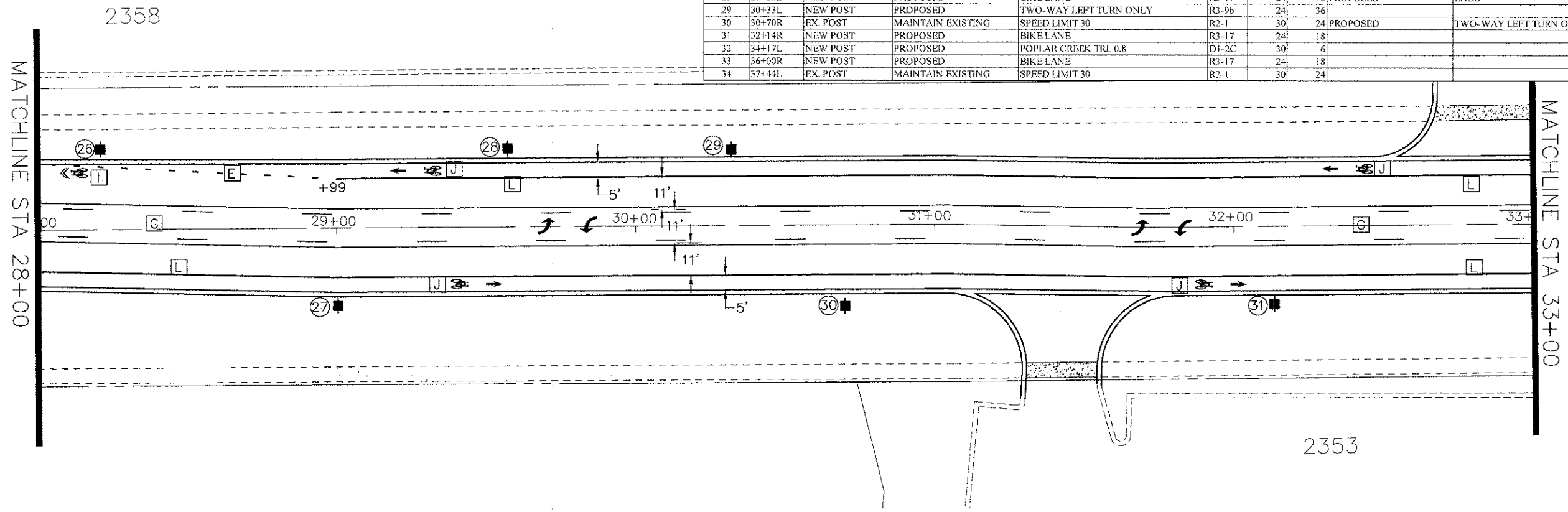

- [A] 4" THERMOPLASTIC DOUBLE YELLOW CENTERLINE
- [B] 4" THERMOPLASTIC YELLOW CENTER SKIP
- [C] 6" THERMOPLASTIC WHITE LANE LINE
- [D] 6" THERMOPLASTIC WHITE CROSSWALK
- [E] 6" THERMOPLASTIC WHITE SKIP DASH
- [F] 24" THERMOPLASTIC WHITE STOP BAR
- [G] 4" THERMOPLASTIC YELLOW TWO-WAY TURN MARKINGS
- [H] THERMOPLASTIC WHITE 'ARROW' AND 'ONLY'
- [I] PREFORMED THERMOPLASTIC WHITE SHARROW SYMBOL
- [J] PREFORMED THERMOPLASTIC WHITE BIKE LANE SYMBOL
- [K] THERMOPLASTIC YELLOW PAINTED MEDIAN
- [L] 4" THERMOPLASTIC WHITE EDGE LINE
- [M] 24" THERMOPLASTIC WHITE CROSSWALK - 2' STRIPE, 3' GAP

PLAN
 DESIGNED -
 DRAWN -
 CHECKED -
 DATE -

PROFILE
 DESIGNED -
 DRAWN -
 CHECKED -
 DATE -

FILE NAME =
 Hassell Plan-Profile.dwg

DESIGNED -	REVISED -
DRAWN -	REVISED -
CHECKED -	REVISED -
DATE -	REVISED -

STATE OF ILLINOIS
 DEPARTMENT OF TRANSPORTATION

Hassell Road STP Project
 Striping and Signage Plan
 SCALE: 1" = 20'
 SHEET NO. 3 OF 9 SHEETS
 STA. 28+00 TO STA 38+00

F.A.U. RTE. 1100	SECTION 11-00087-00-FP	COUNTY Cook	TOTAL SHEETS 164	SHEET NO. 75
CONTRACT NO. 63770				ILLINOIS FED. AID PROJECT CMM 9003(757)