

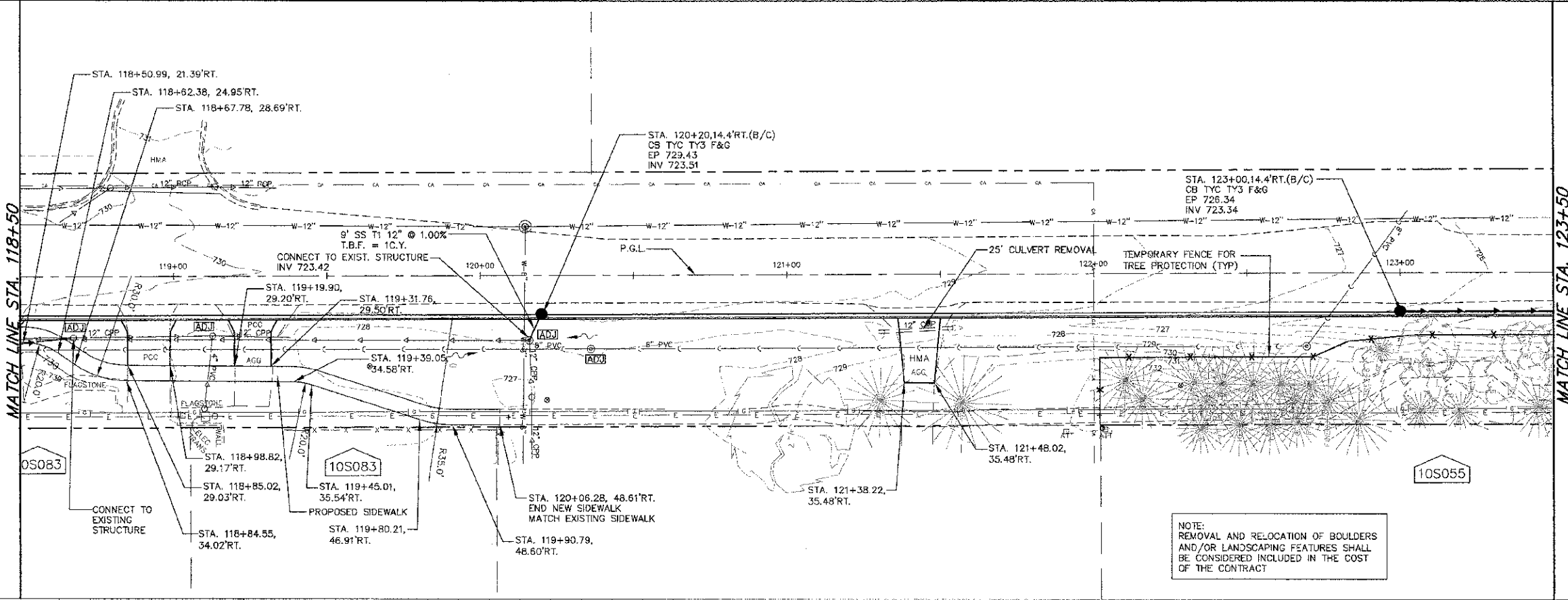

DATE	
BY	
REVISION	
PLANNED	
ALIGNED	
NOTED	
NO.	

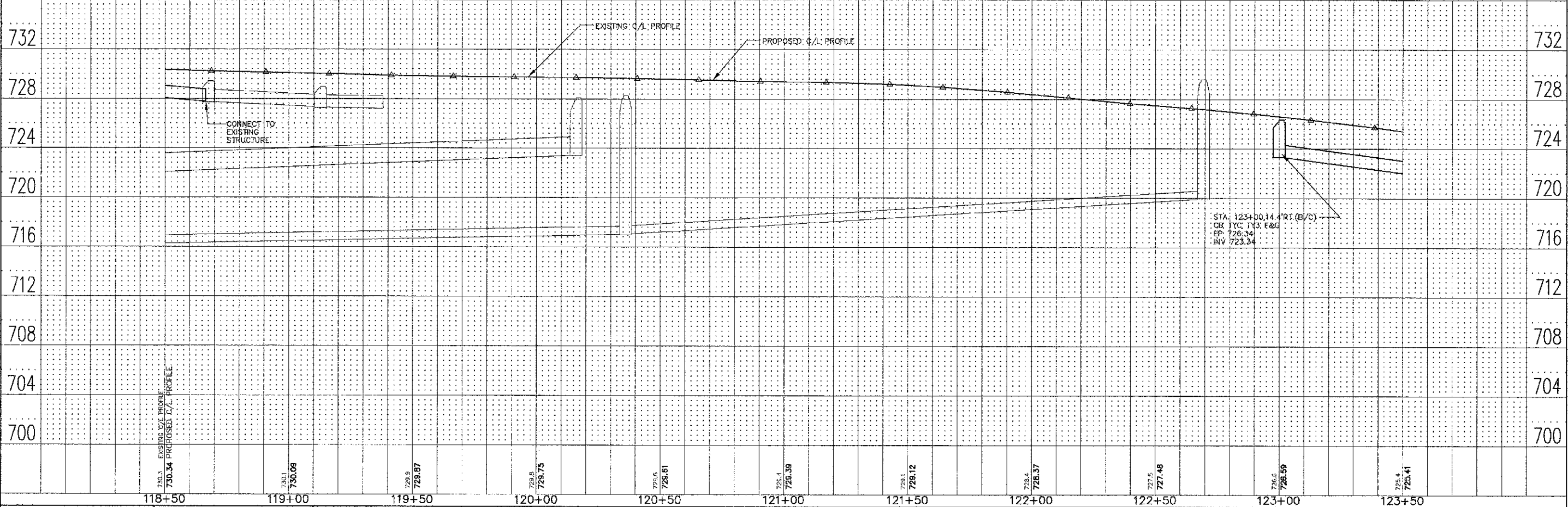

DATE	
BY	
REVISION	
PROFILE	
NOTED	
NO.	



118+50	119+00	119+50	120+00	120+50	121+00	121+50	122+00	122+50	123+00	123+50
730.3	730.1	729.9	729.8	729.6	729.4	729.1	728.4	727.5	726.6	725.4
730.34	730.09	729.87	729.75	729.61	729.39	729.12	728.37	727.48	726.59	725.41

ENGINEERING RESOURCE ASSOCIATES, INC.
CONSULTING ENGINEERS, SCIENTISTS & SURVEYORS

USER NAME = rlanter	DESIGNED = BD	REVISED = 01 24 2013
FILE NAME = \\Server\lbgp\120701.00\Madison Street	DRAWN = RT	REVISED =
PLOT SCALE = 1"=20'	CHECKED = SW	REVISED =
PLOT DATE = 1/24/2013	DATE = 10-19-12	REVISED =

STATE OF ILLINOIS DEPARTMENT OF TRANSPORTATION

MADISON STREET

SCALE: 1"=20' SHEET NO. 2 OF 3 SHEETS STA. 118+50 TO STA. 123+50

F.A.L. R.T.E.	SECTION	COUNTY	TOTAL SHEETS
2674	II-0045-00-RS	DUPAGE	29 7
CONTRACT NO. 63784			