

DATE	
BY	
APPROVED	
PLOTTED	
NOTE BOOK	
AREAS CHECKED	

DATE	
BY	
APPROVED	
PLOTTED	
NOTE BOOK	
AREAS CHECKED	

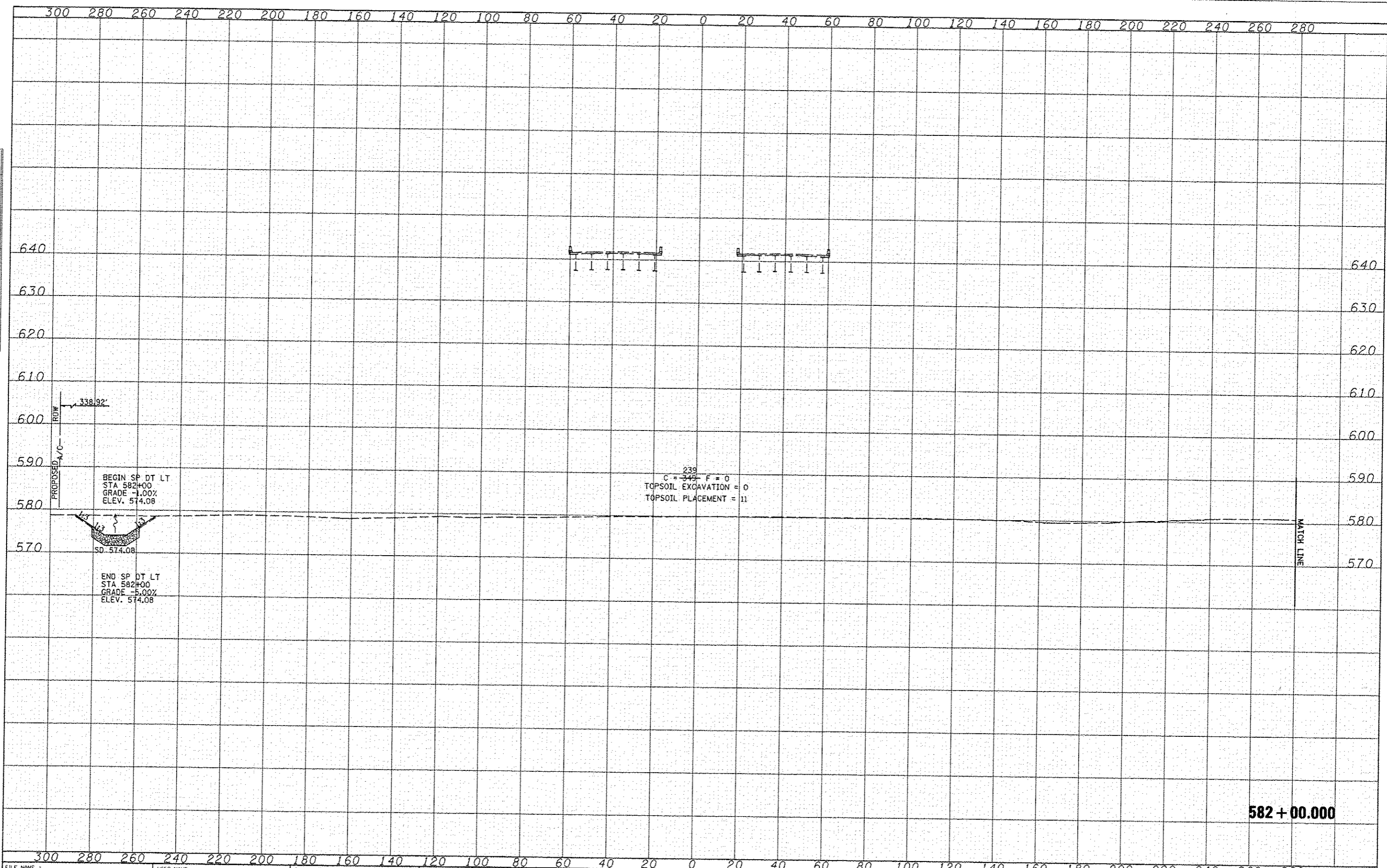

582 + 00.000

FILE NAME: V:\Transportation\289\Grading Plans\CA00 Sheet	USER NAME: jdeen	DESIGNED: JRB	REVISED: 02/07/2013	STATE OF ILLINOIS DEPARTMENT OF TRANSPORTATION	FAP ROUTE 407 (IL RTE 336) CROSS SECTIONS			F.A.P. RTE.	SECTION	COUNTY	TOTAL SHEETS	SHEET NO.
	ND46842-ht-wsht.dgn	DRAWN: TJD	REVISED: 02/21/2013		407	155-31A	MCDONOUGH	671	370			
PLT SCALE: 48.00' / IN.		CHECKED: AWM	REVISED:		CONTRACT NO. 68A42							
PLT DATE: 2/21/2013		DATE: 12-12-12	REVISED:		ILLINOIS FED. AID PROJECT							

SCALE: 1"=30' H, 1"=100' V | SHEET NO. 40 OF 176 SHEETS | STA. 582+00.000 TO STA. 582+00.000