

DATE	
BY	
DESIGNED	
DRAWN	
CHECKED	
DATE	
REVISIONS	
NO. 1	
NO. 2	
NO. 3	
NO. 4	
NO. 5	

DATE	
BY	
DESIGNED	
DRAWN	
CHECKED	
DATE	
REVISIONS	
NO. 1	
NO. 2	
NO. 3	
NO. 4	
NO. 5	

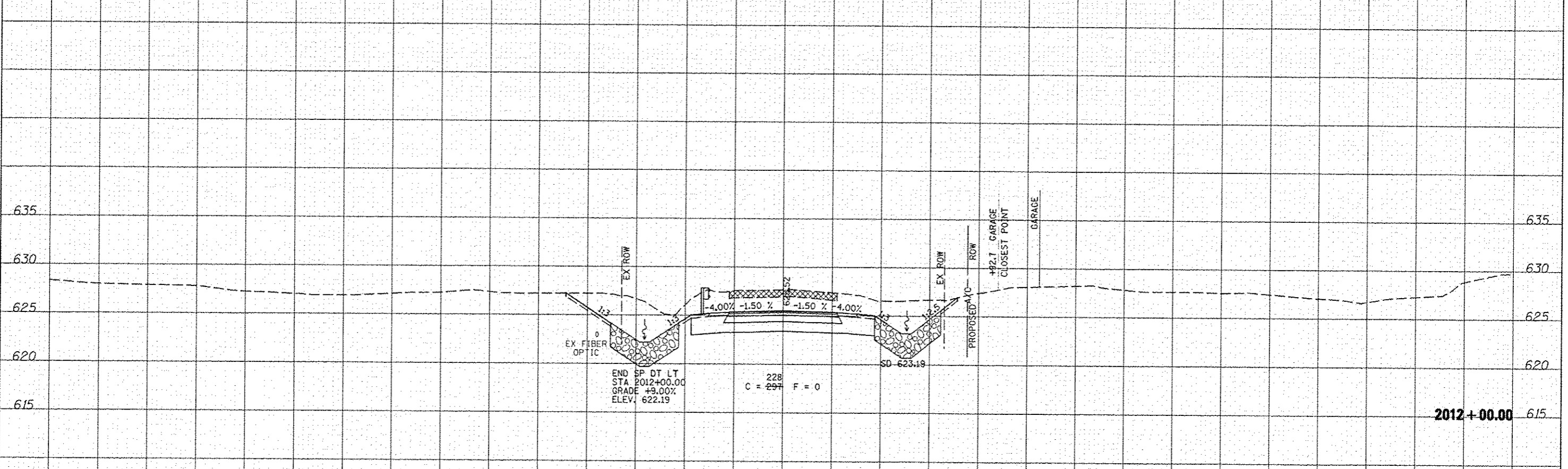
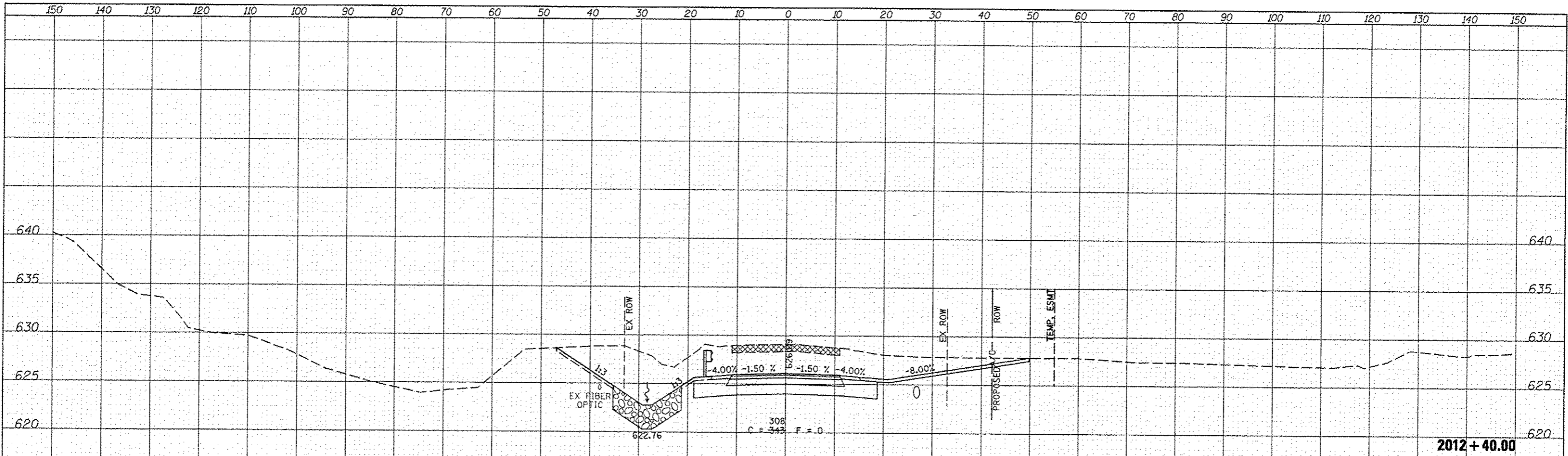

1 REVISIONS
 REVISION 1: REVISE PAVEMENT STRUCTURE
 REVISION 2: REVISE EARTHWORK QUANTITIES

FILE NAME	USER NAME	DESIGNED	REVISIONS
W:\Transportation\2091\Grading Plans\CADD Sheets\12468442-shs-wash\CH14.dgn	jdon	JRB	02/07/2013
		TJD	02/21/2013
		AWM	

STATE OF ILLINOIS
 DEPARTMENT OF TRANSPORTATION

FAP 407 (IL RTE 336)
 CROSS SECTIONS - CH14
 SCALE: 1"=20' H
 1"=50' V
 SHEET 5 OF 19 SHEETS
 STA. 2012+00.00 TO STA. 2012+40.00

F.A.P. RTE.	SECTION	COUNTY	TOTAL SHEETS	SHEET NO.
407	ISS-31A	MCDONOUGH	671	535
			CONTRACT NO. 68A42	
ILLINOIS FED. AID PROJECT				