

PLAN	SURVEYED	DATE
	PLOTTED	
	NOTED	
	BY	
	NO.	

PROFILE	SURVEYED	DATE
	PLOTTED	
	NOTED	
	BY	
	NO.	

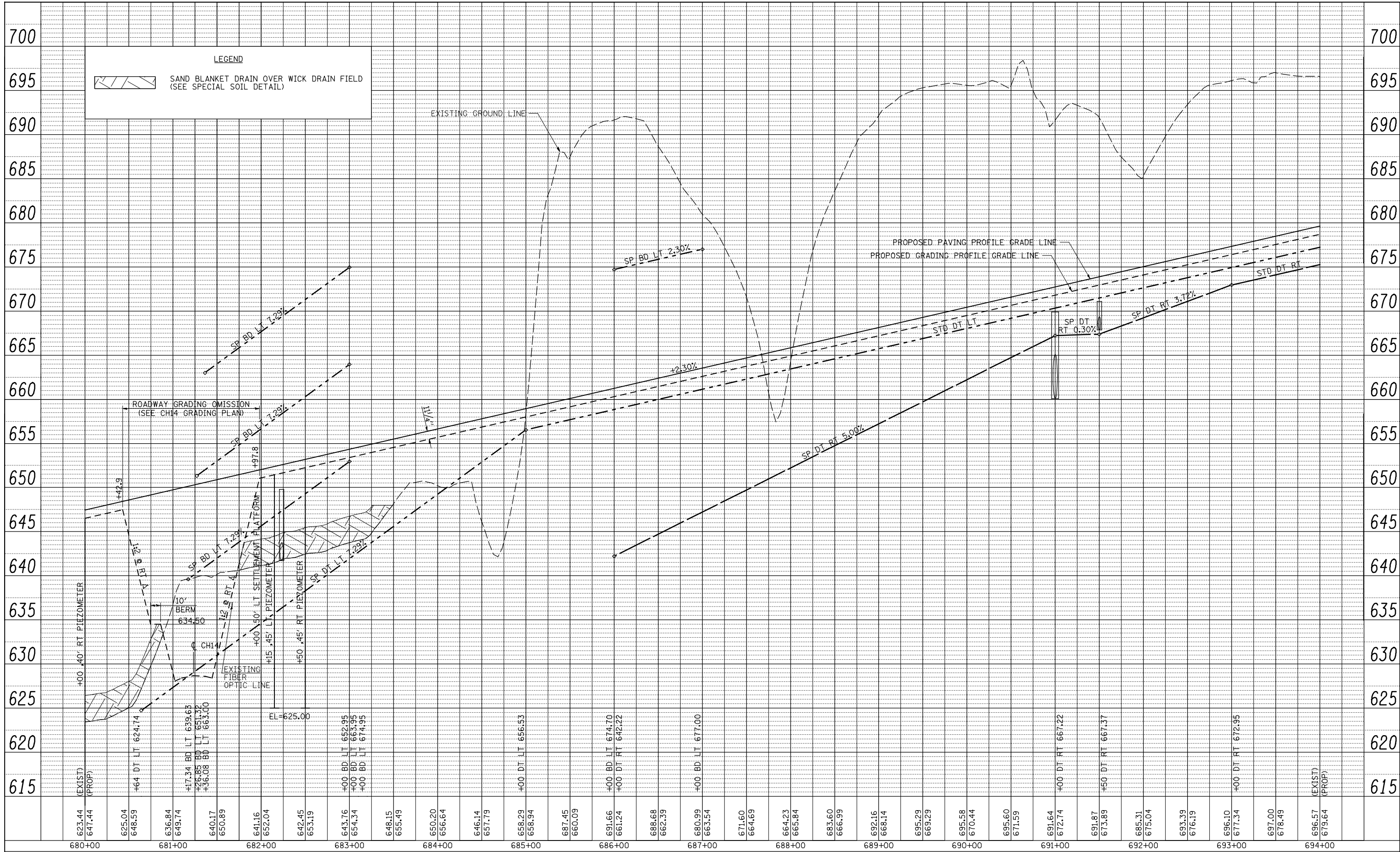

FILE NAME =	USER NAME = jdeen	DESIGNED - JRB	REVISED -	STATE OF ILLINOIS DEPARTMENT OF TRANSPORTATION FAP 407 (IL RTE 336) GRADING & DRAINAGE PLAN & PROFILE STATION 680+00 TO STATION 694+00	F.A.P. RTE. 407	SECTION (55-31A)	COUNTY McDONOUGH	TOTAL SHEETS 671	SHEET NO. 128	
V:\Transportation\2891\Grading Plans\2891DPr-f11.dgn	PLOT SCALE = 100.00' / IN.	DRAWN - RLR	REVISED -		SCALE: 1"=50'	SHEET NO. 22 OF 37 SHEETS	STA. 680+00	TO STA. 694+00	CONTRACT NO. 68A42	ILLINOIS FED. AID PROJECT
	PLOT DATE = 12/12/2012	CHECKED - AWM	REVISED -							
		DATE - 12-12-12	REVISED -							