

SEC 4, T 5 N, R 34 W, 4th PM

LEGEND	
	PERIMETER EROSION BARRIER
	TEMPORARY DITCH CHECKS
	INLET AND PIPE PROTECTION
	SEDIMENT BASIN
	RIPRAP
	HEAVY DUTY EROSION CONTROL BLANKET
	FABRIC FORMED CONCRETE REVETMENT MAT
	ENERGY DISSIPATOR BASIN

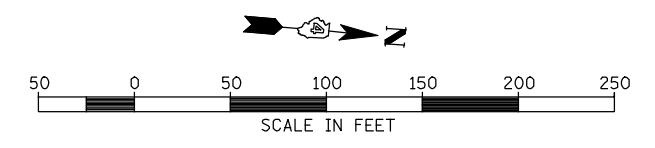
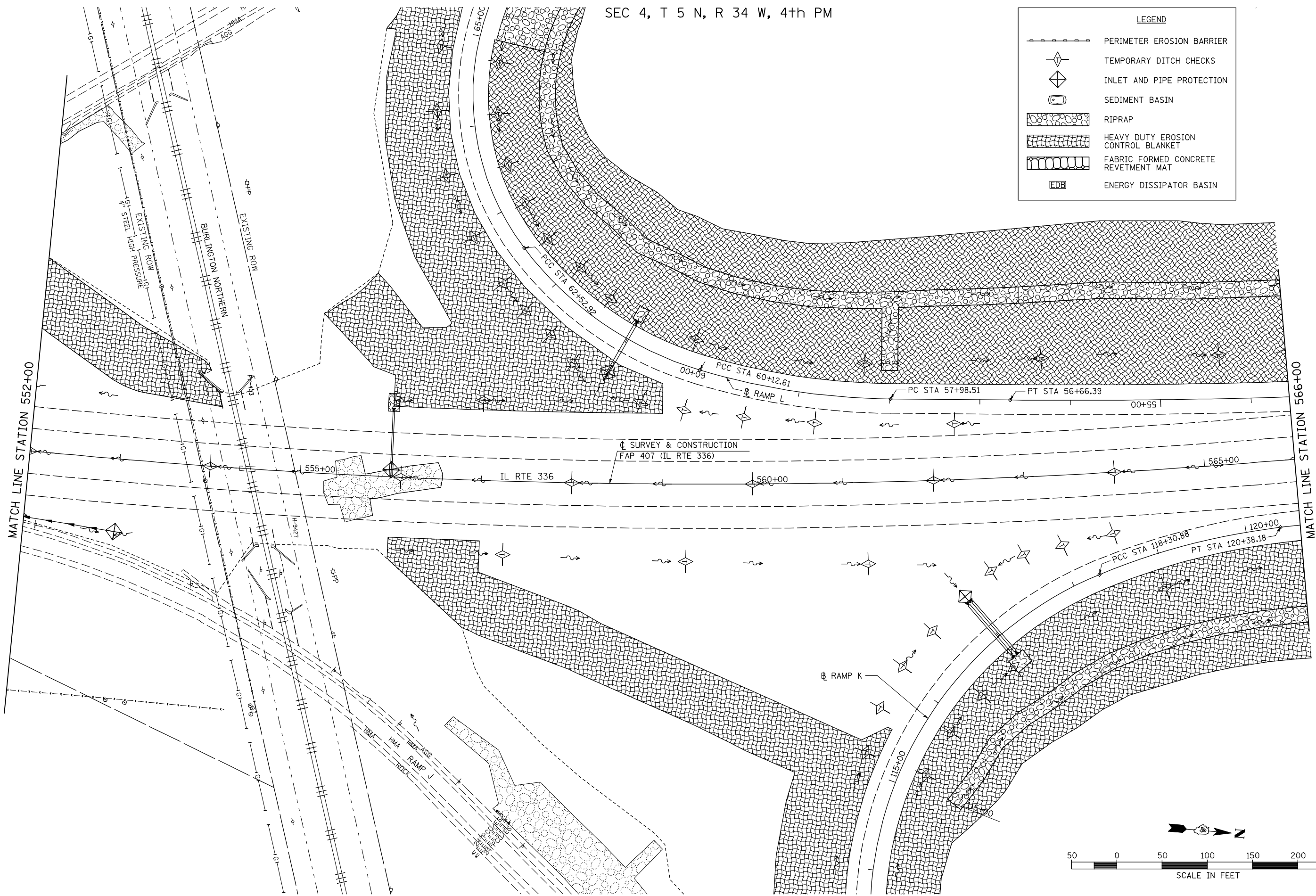

FILE NAME =	USER NAME = jdeen	DESIGNED - JRB	REVISED -	<b>STATE OF ILLINOIS DEPARTMENT OF TRANSPORTATION</b>	<b>FAP 407 (IL RTE 336) EROSION CONTROL PLAN - STATION 552+00 TO STATION 566+00</b>			F.A.P. RTE. 407	SECTION (55-31A)	COUNTY McDONOUGH	TOTAL SHEETS 671	SHEET NO. 179
W:\Transportation\2891\Grading Plans\2891E02.dgn	PLOT SCALE = 100.00' / IN.	CHECKED - AWM	REVISED -		SCALE: 1"=50'	SHEET NO. 2 OF 21 SHEETS	STA. 552+00	TO STA. 556+00	CONTRACT NO. 68A42			
PLOT DATE = 12/12/2012	DATE - 12-12-12	REVISED -			ILLINOIS FED. AID PROJECT							