

SEC 22, T 6 N, R 3 W, 4th PM

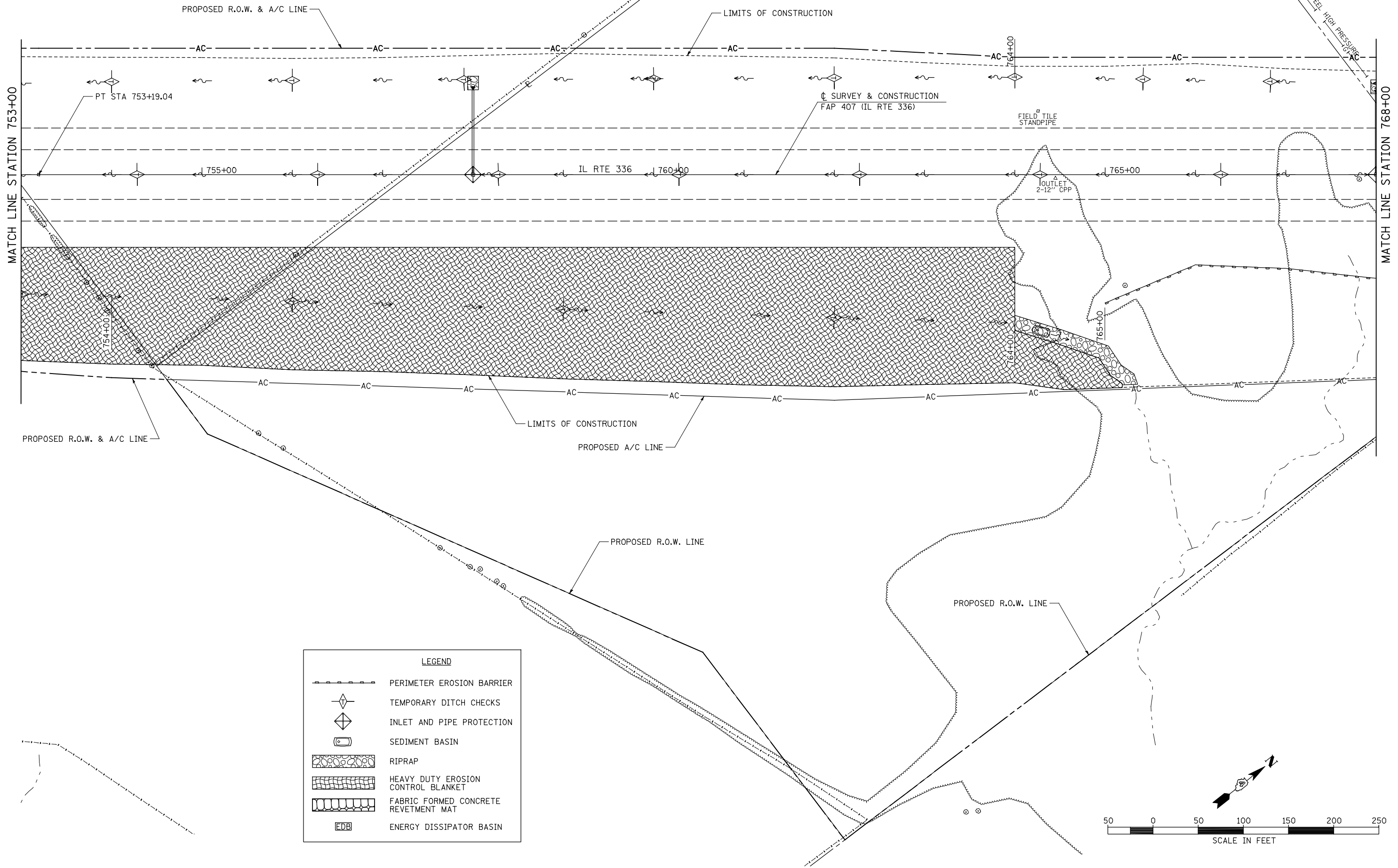

PLAN	SURVEYED	DATE
	PLOTTED	BY
	GRADES CHECKED	
	STRUCTURE NOTATIONS OK'D	
	NOTE BOOK NO.	
	CADD FILE NAME	

PROFILE	SURVEYED	DATE
	PLOTTED	BY
	GRADES CHECKED	
	STRUCTURE NOTATIONS OK'D	
	NOTE BOOK NO.	
	CADD FILE NAME	

LEGEND	
	PERIMETER EROSION BARRIER
	TEMPORARY DITCH CHECKS
	INLET AND PIPE PROTECTION
	SEDIMENT BASIN
	RIPRAP
	HEAVY DUTY EROSION CONTROL BLANKET
	FABRIC FORMED CONCRETE REVETMENT MAT
	ENERGY DISSIPATOR BASIN

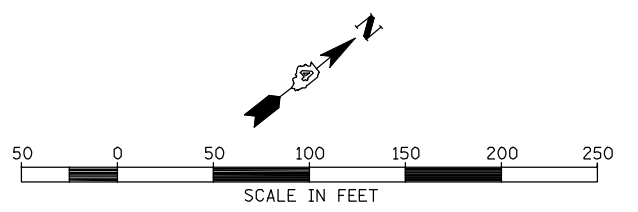

FILE NAME =	USER NAME = jdeen	DESIGNED - JRB	REVISED -
V:\Transportation\2891\Grading Plans\2891E14-B.dgn		DRAWN - JMO	REVISED -
	PLOT SCALE = 100.00' / IN.	CHECKED - AWM	REVISED -
	PLOT DATE = 12/12/2012	DATE - 12-12-12	REVISED -

**STATE OF ILLINOIS
DEPARTMENT OF TRANSPORTATION**

**FAP 407 (IL RTE 336)
EROSION CONTROL PLAN - STA 753+00 TO STA 768+00**

F.A.P. RTE.	SECTION	COUNTY	TOTAL SHEETS	SHEET NO.
407	(55-3)A	McDONOUGH	671	192
				CONTRACT NO. 68A42

SCALE: 1"=50' SHEET NO. 15 OF 21 SHEETS STA. 753+00 TO STA. 768+00

ILLINOIS FED. AID PROJECT