

☐ SURVEY & CONSTRUCTION
1350N (CH 14)

PROPOSED A/C LINE

LIMITS OF CONSTRUCTION



☐ SURVEY & CONSTRUCTION
FAP 407 (IL RTE 336)

MATCH LINE STATION 680+00

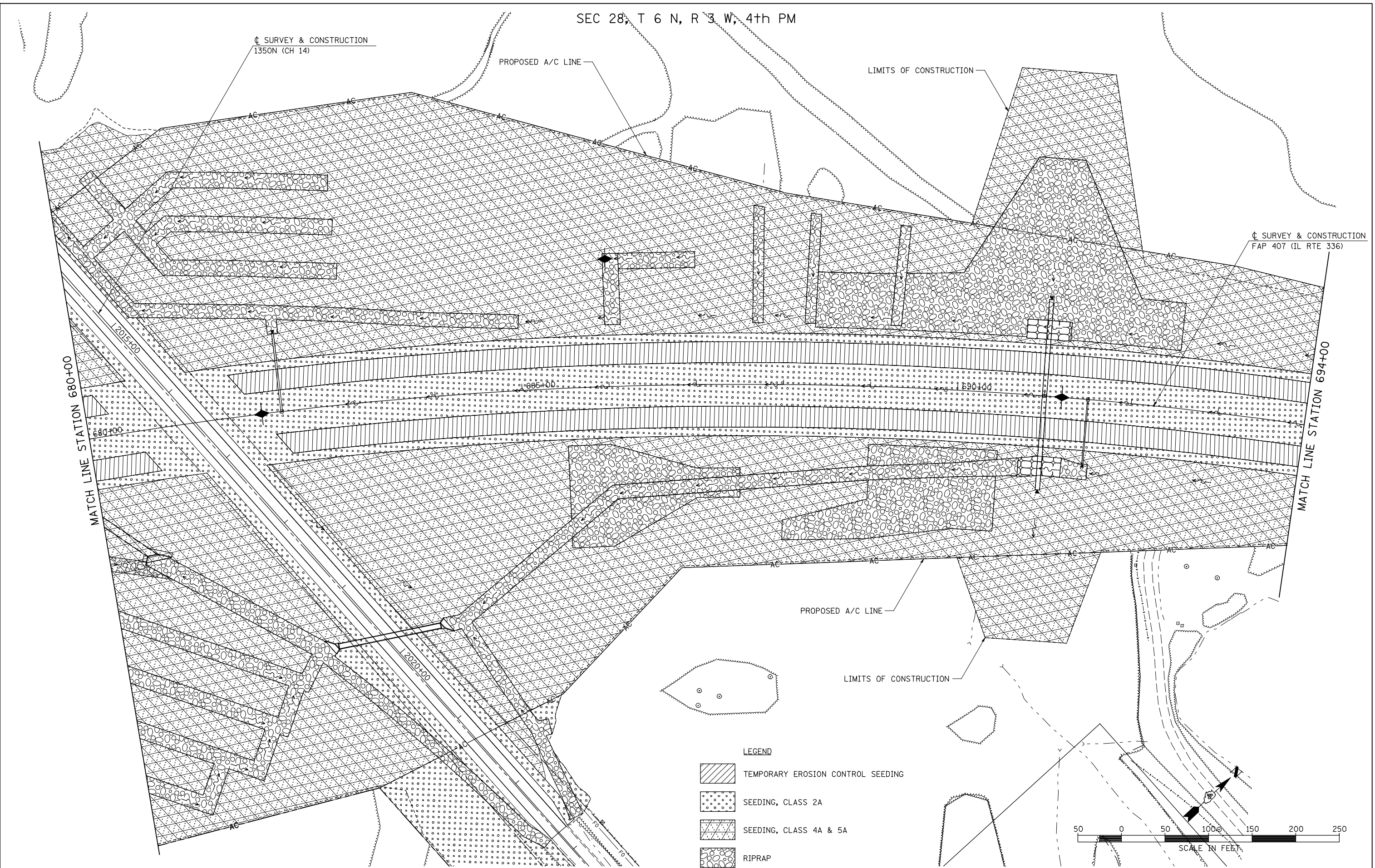
MATCH LINE STATION 694+00

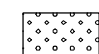
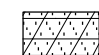

LEGEND

-  TEMPORARY EROSION CONTROL SEEDING
-  SEEDING, CLASS 2A
-  SEEDING, CLASS 4A & 5A
-  RIPRAP

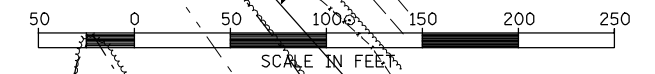

FILE NAME =	USER NAME = jdeen	DESIGNED - JRB	REVISED -
v:\transportation\2891\grading plans\2891\11.dgn		DRAWN - JMO	REVISED -
	PLOT SCALE = 100.00' / IN.	CHECKED - AWM	REVISED -
	PLOT DATE = 12/12/2012	DATE - 12-12-12	REVISED -

STATE OF ILLINOIS
DEPARTMENT OF TRANSPORTATION

FAP 407 (IL RTE 336)
LANDSCAPING PLAN - STATION 680+00 TO STATION 694+00

SCALE: 1"=50' SHEET NO. 11 OF 21 SHEETS STA. 680+00 TO STA. 694+00

F.A.P. RTE.	SECTION	COUNTY	TOTAL SHEETS	SHEET NO.
407	(55-3)A	McDONOUGH	671	220
			CONTRACT NO. 68A42	
ILLINOIS FED. AID PROJECT				