

SEC 13, T 6 N, R 3 W, 4th PM

SW 1/4 SEC 13

SE 1/4 SEC 13

4AEC029 + TE  
HEW FARMS, LTD.,  
AN ILLINOIS CORPORATION  
07-000-118-00

4AEC028 + TE  
AFC ILLINOIS II, LLC,  
A DELAWARE LIMITED LIABILITY COMPANY  
07-000-117-00; 07-000-119-00; 07-000-120-00  
07-000-127-00; 07-000-128-00

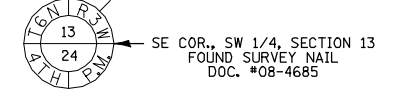
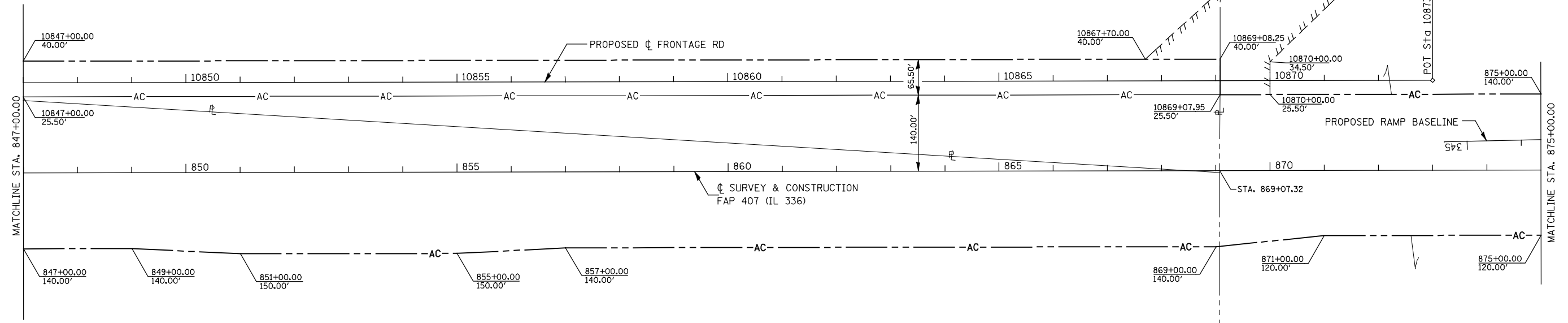

**LEGEND**

- PROPOSED CENTERLINE
- EXISTING RIGHT OF WAY LINE
- AC — EXISTING RIGHT OF WAY & ACCESS CONTROL LINE
- AC — EXISTING ACCESS CONTROL LINE
- - - PROPOSED RIGHT OF WAY LINE
- - - AC - PROPOSED RIGHT OF WAY & ACCESS CONTROL LINE
- - - AC - PROPOSED ACCESS CONTROL LINE
- /// PROPOSED TEMPORARY EASEMENT LINE
- //// PROPOSED PERMANENT EASEMENT LINE
- SECTION LINE
- - - QUARTER SECTION LINE
- P — PROPERTY LINE

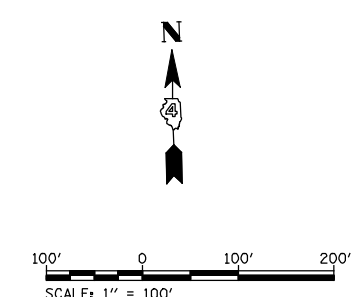

FILE NAME	USER NAME = jdeen	DESIGNED -	REVISED - 05/2012
W:\Transportation\2891\Grading Plans\2891ROWPlan12.dgn		DRAWN - DJH	REVISED -
	PLOT SCALE = 200.0000' / IN.	CHECKED - JWD	REVISED -
	PLOT DATE = 12/12/2012	DATE - 05/2012	REVISED -

**STATE OF ILLINOIS  
DEPARTMENT OF TRANSPORTATION**

RIGHT OF WAY PLANS			F.A.P. RTE.	SECTION	COUNTY	TOTAL SHEETS	SHEET NO.
SCALE: 1" = 100'	PROJECT	JOB NO. R-94-004-11	407	(55-3)A	McDONOUGH	671	253
	SHEET NO. 12 OF 15 SHEETS	STA. 847+00.00 TO STA. 875+00.00	CONTRACT NO. 68A42				
			FED. ROAD DIST. NO. ILLINOIS FED. AID PROJECT				