

Benchmark: RR spike in 15" tree, sta. 779+90.13, 239.00' LT, Elev. 714.76
 Existing Structure: None

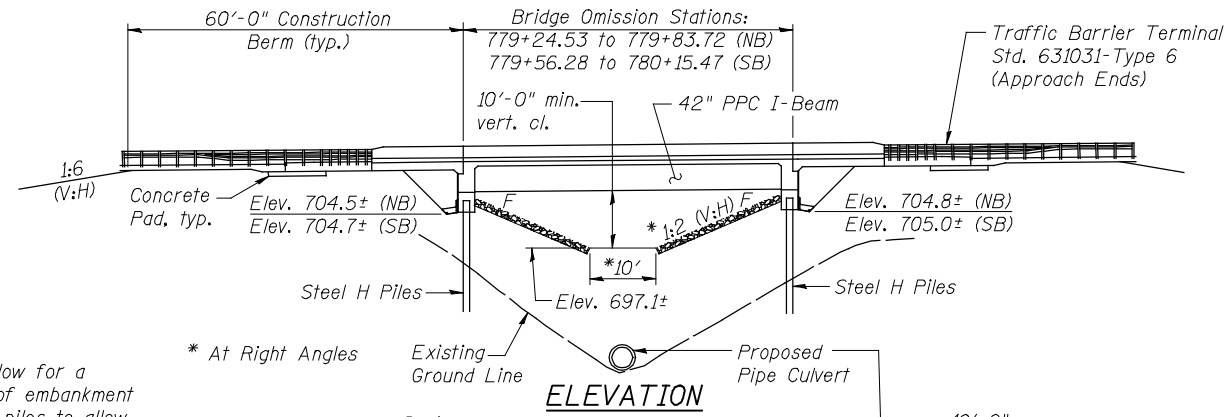

Note:
 The construction schedule should allow for a 30 day delay between placement of embankment fill and installation of the abutment piles to allow for consolidation of the underlying soils. Settlement of the fill should be monitored during this period to confirm that the settlement is complete.

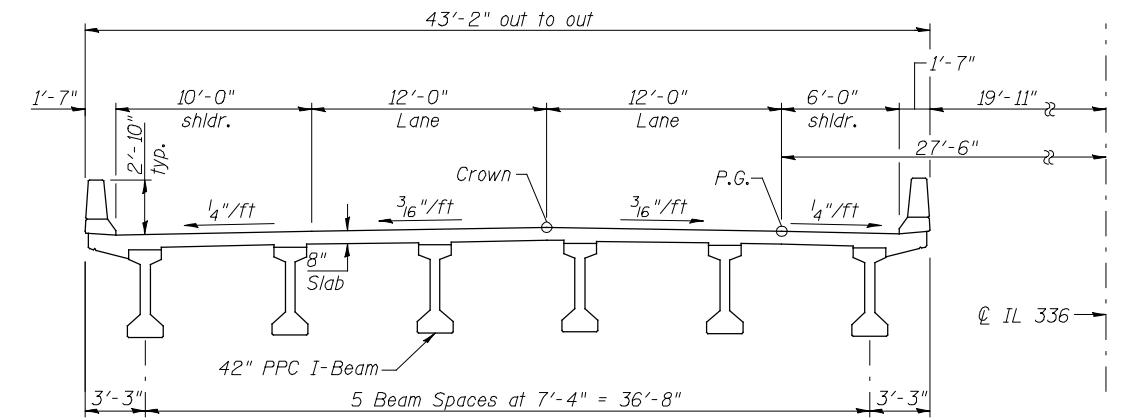

CROSS SECTION
 (S.N. 055-0076 Looking North shown, S.N. 055-0075 similar)

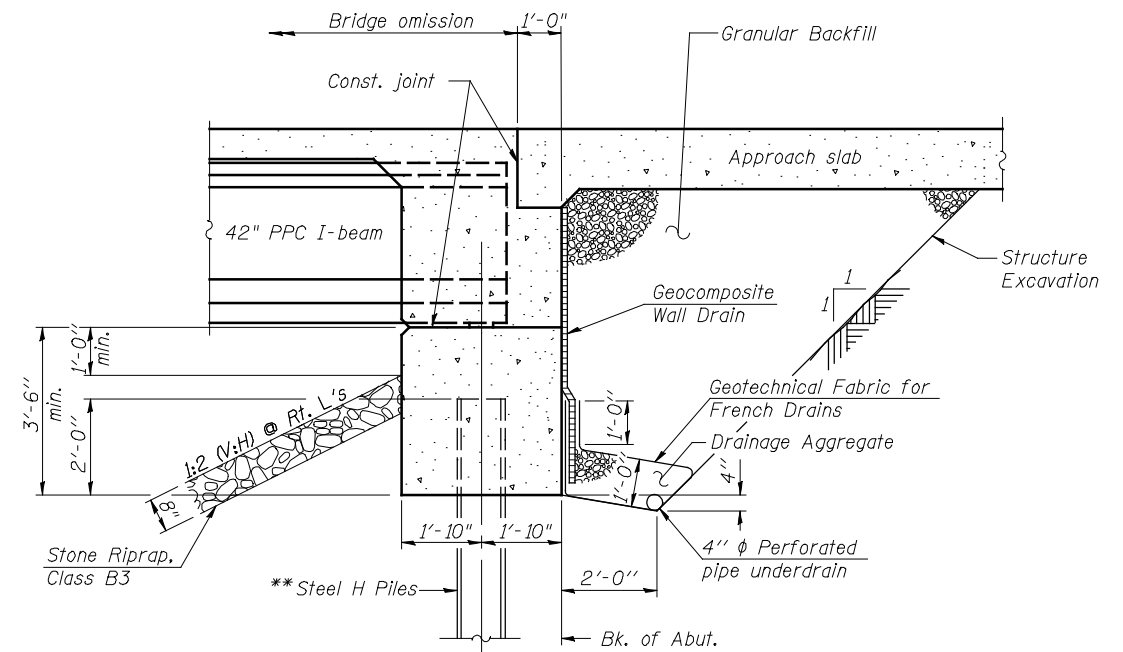

SECTION THRU ABUTMENT
 (Horiz. dim. @ Rt. L's)

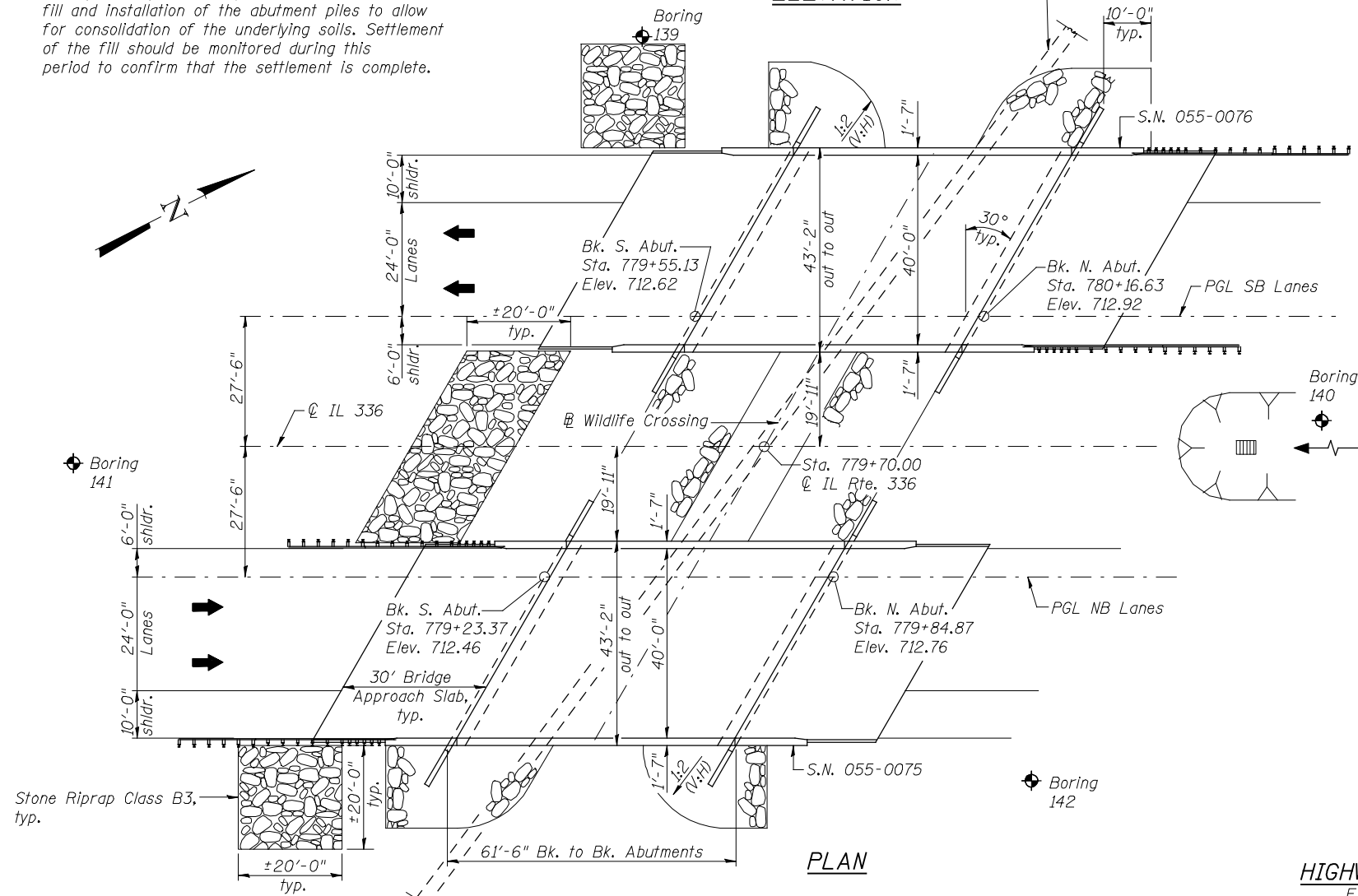

PLAN

HIGHWAY CLASSIFICATION

F.A.P. 407 - (IL 336)
 Functional Class: Freeway
 ADT: 3045 (2015); 3715 (2035)
 DHV: 305 (2015); 372 (2035)
 ADTT = 10%
 Design Speed: 70 m.p.h.
 Posted Speed: 65 m.p.h.
 Two-Way Traffic
 Directional Distribution: 50:50

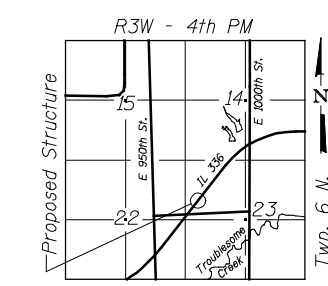

LOCATION SKETCH

DESIGN STRESSES

FIELD UNITS
 $f'c = 3,500$ psi
 $f_y = 60,000$ psi (Reinforcement)
PRECAST PRESTRESSED UNITS
 $f'c = 6,000$ psi
 $f'ci = 5,000$ psi
 $f_{pu} = 270,000$ psi ($1/2$ " ϕ low lax. strands)
 $f_{pbt} = 201,960$ psi ($1/2$ " ϕ low lax. strands)

DESIGN SPECIFICATIONS

2012 AASHTO LRFD Bridge Design Specifications, 6th Edition

LOADING HL-93

Allow 50# / sq. ft. for future wearing surface.

SEISMIC DATA

Seismic Performance Zone (SPZ) = 1
 Design Spectral Acceleration at 1.0 sec. (S_{D1}) = 0.08g
 Design Spectral Acceleration at 0.2 sec. (S_{D5}) = 0.13g
 Soil Site Class = C

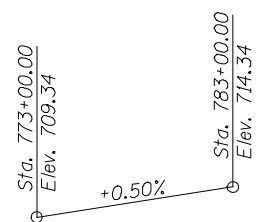

PROFILE GRADE
 (along P.G.L. IL 336)

NOT FOR CONSTRUCTION FOR ROADWAY REFERENCE ONLY

GENERAL PLAN AND ELEVATION
IL 336 OVER WILDLIFE CROSSING #3
F.A.P. 407 - SECTION 55-3
McDONOUGH COUNTY
STATION 779+70.00
STRUCTURE NO. 055-0075 (NB)
STRUCTURE NO. 055-0076 (SB)



| | | |
|--------------|----------------|-----------|
| USER NAME = | DESIGNED - MTH | REVISED - |
| FILE NAME = | CHECKED - ADB | REVISED - |
| PLOT SCALE = | DRAWN - TBP | REVISED - |
| PLOT DATE = | CHECKED - MTH | REVISED - |

STATE OF ILLINOIS
DEPARTMENT OF TRANSPORTATION

FAP 407 (IL RTE 336)
WILDLIFE CROSSING #3 TS & L

SHEET NO. 1 OF 1 SHEETS

| F.A.P. RTE. | SECTION | COUNTY | TOTAL SHEETS | SHEET NO. |
|---------------------------|---------|-----------|--------------------|-----------|
| 407 | 55-3 | McDONOUGH | 671 | 262 |
| | | | CONTRACT NO. 68418 | |
| ILLINOIS FED. AID PROJECT | | | | |