

BENCH MARK

Description
Sta.
Elev.

EXISTING STRUCTURE

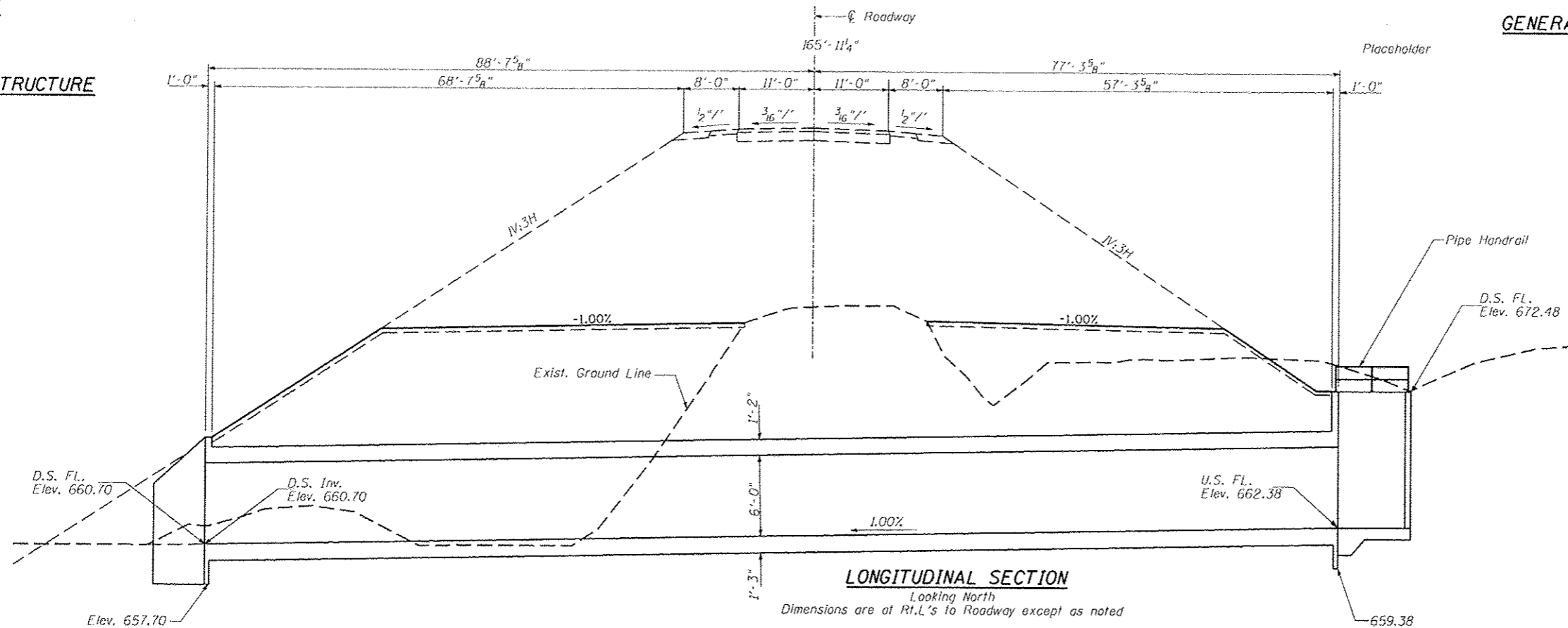

GENERAL NOTES

INDEX TO SHEETS

- 1. General Plan
- 2-3. Culvert Details

TOTAL BILL OF MATERIAL

ITEM	UNIT	TOTAL
Removal of Existing Structures	EACH	1
Concrete Box Culverts	CU YD	246
Reinforcement Bars	POUND	62,100
Pipe Handrail	FOOT	43.3
Porous Granular Embankment	CU YD	1573

LOADING HL-93

Allow 50#/sq. ft. for future wearing surface.

DESIGN SPECIFICATIONS

2012 AASHTO LRFD Bridge Design Specifications, 6th Edition

DESIGN STRESSES

FIELD UNITS

$f'_c = 3,500$ psi
 $f_y = 60,000$ psi (Reinforcement)

LONGITUDINAL SECTION

Looking North
Dimensions are at Rt.L.'s to Roadway except as noted

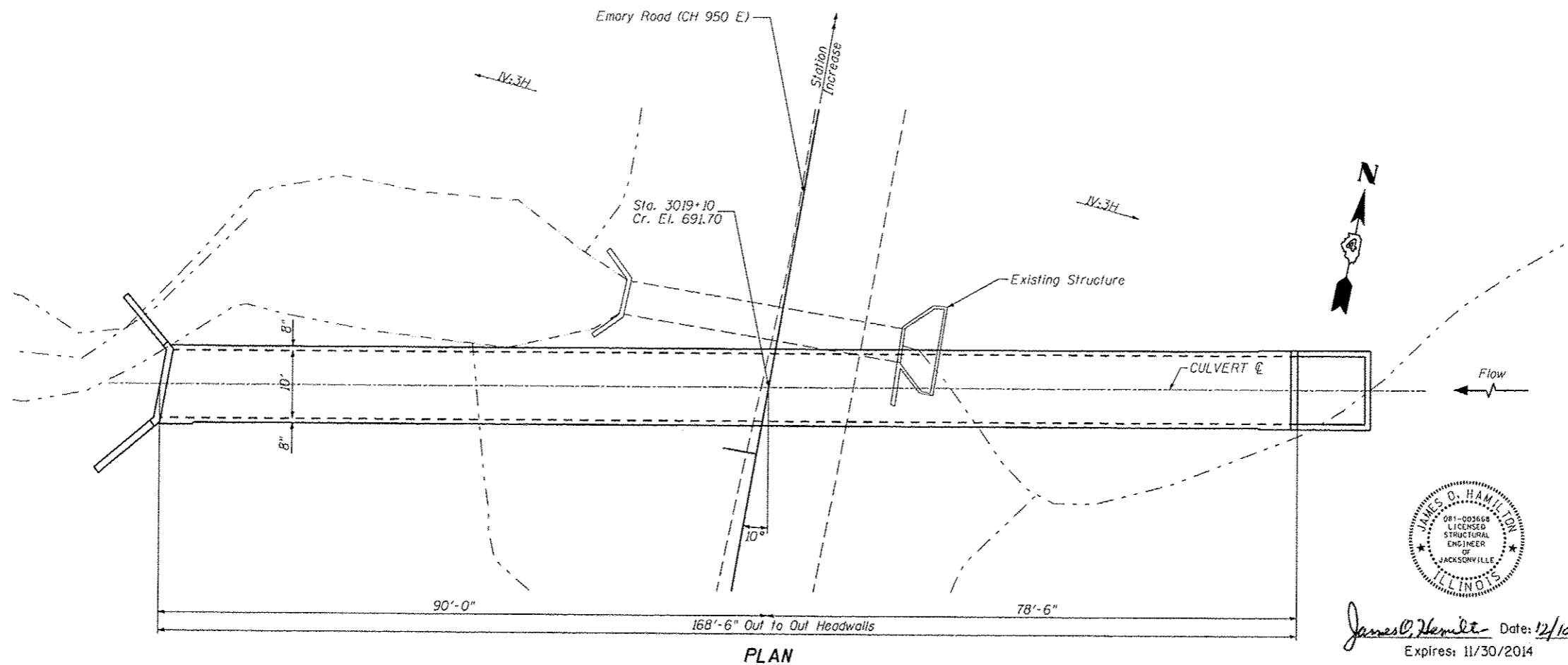

PROFILE GRADE
PROFILE ALONG CENTERLINE OF ROAD

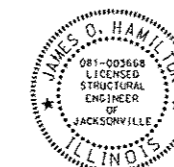
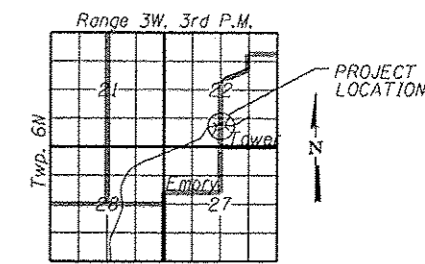

James O. Hamilton Date: 12/10/2012
Expires: 11/30/2014

FILE NAME *	USER NAME * jdean	DESIGNED -	REVISED -
\\transportation\2891\grading plans\W...	\\senn\fine\CULVERT PLAN SHEET 3019+10.dgn	DRAWN -	REVISED -
	PLOT SCALE = 20.000000 FT / IN.	CHECKED - JOH	REVISED -
	PLOT DATE = 1/16/2013	DATE - 12-12-12	REVISED -

STATE OF ILLINOIS
DEPARTMENT OF TRANSPORTATION

GENERAL PLAN AND ELEVATION
STA 3019+10.00

SCALE: SHEET NO. 1 OF 3 SHEETS STA. TO STA.

F.A.P. RTE.	SECTION	COUNTY	TOTAL SHEETS	SHEET NO.
407	155-31A	MCDONOUGH	671	281
CONTRACT NO. 68A42				
ILLINOIS FED. AID PROJECT				