

PROP. CURVE RAMP A-2
 PI STA. = 331+58.47
 $\Delta = 36^\circ 15' 54''$ (RT)
 $D = 7^\circ 29' 23''$
 $R = 765.00'$
 $T = 250.52'$
 $L = 484.20'$
 $E = 39.98'$
 $e = 8.0\%$
 P.C. STA. = 329+07.95
 P.T. STA. = 333+92.15
 SE ATTAINED STA 327+34.29 TO STA 329+92.95
 SE REMOVED THROUGH STD ENTRANCE TERMINAL

PROP. CURVE RAMP D-1
 PI STA. = 210+51.11
 $\Delta = 36^\circ 19' 57''$ (RT)
 $D = 7^\circ 29' 23''$
 $R = 765.00'$
 $T = 251.02'$
 $L = 485.10'$
 $E = 40.13'$
 $e = 8.0\%$
 P.C. STA. = 208+00.09
 P.T. STA. = 212+85.19
 SE ATTAINED THROUGH STD EXIT TERMINAL
 SE REMOVED STA 212+00.19 TO STA 214+55.19

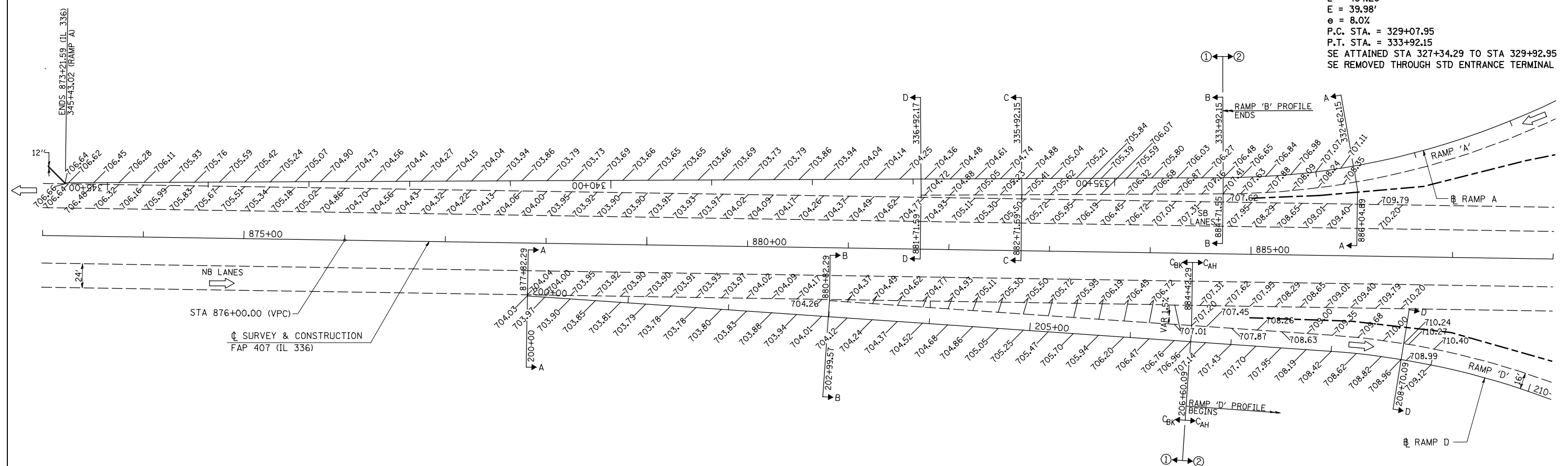

NOTE:
 ELEVATIONS SHOWN ARE FOR THE FUTURE PAVEMENT SURFACE. CONTRACTOR SHALL GRADE TO AN ELEVATION $11\frac{1}{4}''$ LESS THAN THE SURFACE ELEVATIONS SHOWN.

- ① ELEVATIONS GIVEN ALONG IL 336 STATIONING AT 25' CENTERS
- ② ELEVATIONS GIVEN ALONG RAMP STATIONING AT 25' CENTERS

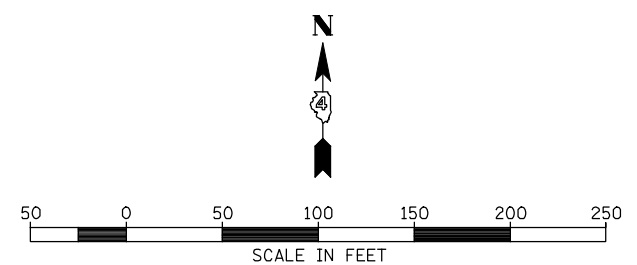

FILE NAME =	USER NAME = jdeen	DESIGNED - JRB	REVISED -
v:\transportation\2891\grading plans\2891RampsA&D.dgn		DRAWN - JMO	REVISED -
PLOT SCALE = 100.0000' / IN.		CHECKED - AWM	REVISED -
PLOT DATE = 12/12/2012		DATE - 12-12-12	REVISED -

**STATE OF ILLINOIS
 DEPARTMENT OF TRANSPORTATION**

**FAP 407 (IL RTE 336)
 RAMP TERMINAL DETAILS - RAMPS D & A**

SCALE: 1"=50' SHEET NO. 1 OF 1 SHEETS STA. TO STA.

F.A.P. RTE. 407	SECTION (55-31A)	COUNTY McDONOUGH	TOTAL SHEETS 671	SHEET NO. 301
CONTRACT NO. 68A42			ILLINOIS FED. AID PROJECT	