

|               |  |
|---------------|--|
| DATE          |  |
| BY            |  |
| SURVEYED      |  |
| PLOTTED       |  |
| TEMPLATE      |  |
| AREAS CHECKED |  |
| FINAL SURVEY  |  |
| NOTE BOOK     |  |
| NO.           |  |

|                 |  |
|-----------------|--|
| DATE            |  |
| BY              |  |
| SURVEYED        |  |
| PLOTTED         |  |
| TEMPLATE        |  |
| AREAS CHECKED   |  |
| ORIGINAL SURVEY |  |
| NOTE BOOK       |  |
| NO.             |  |

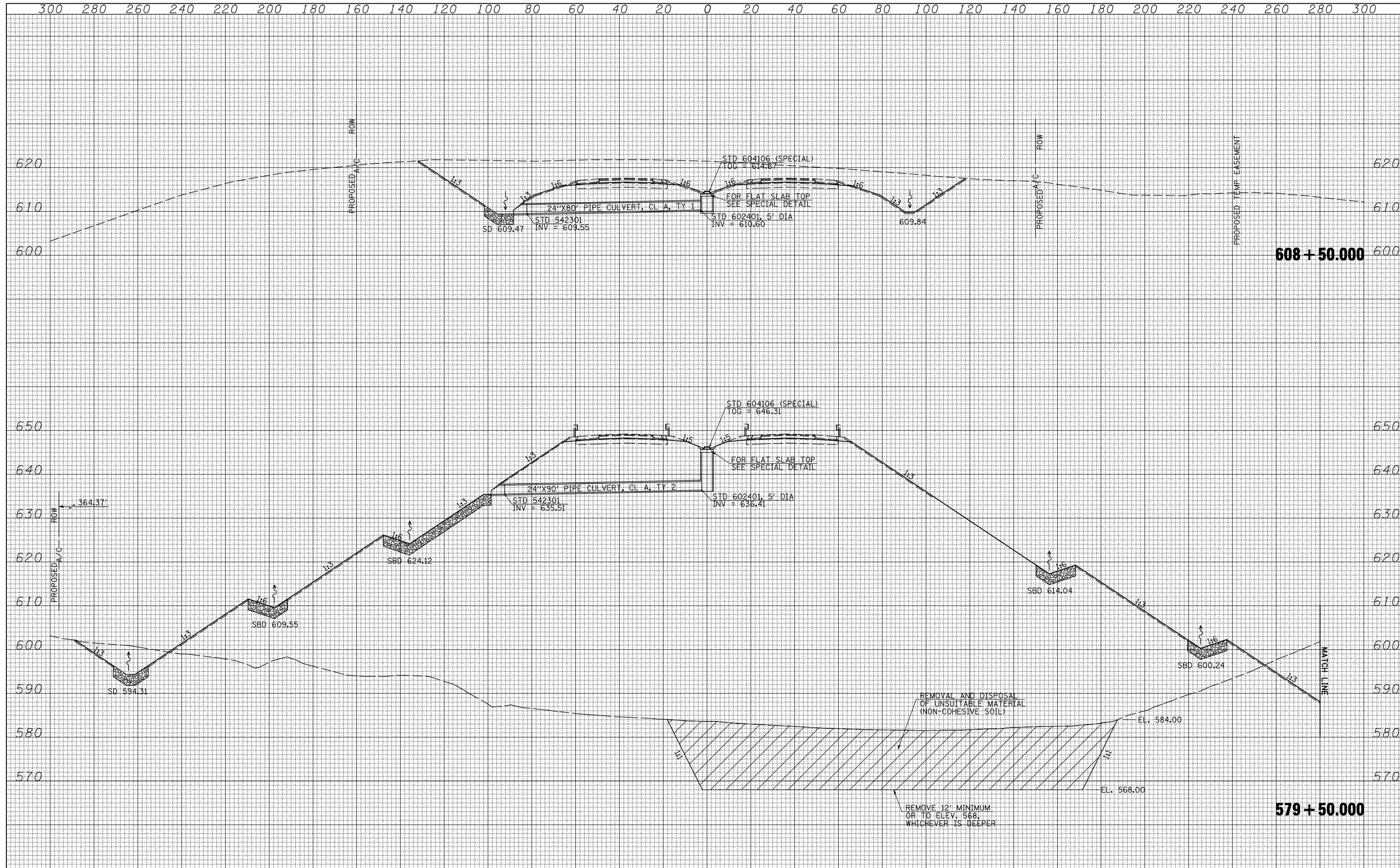

|   |                   |                 |           |  |                 |   |                  |                                    |
|---|-------------------|-----------------|-----------|--|-----------------|---|------------------|------------------------------------|
| FILE NAME =   | USER NAME = jdeen | DESIGNED - JRB  | REVISED - | F.A.P. RTE. 407                                | SECTION (55-3)A | COUNTY MCDONOUGH                                  | TOTAL SHEETS 671 | SHEET NO. 508                      |
| V:\Transportation\2891\Grading Plans\2891xsheets-20\SCALE.dgn |                   | DRAWN - TJD     | REVISED - | STATE OF ILLINOIS DEPARTMENT OF TRANSPORTATION |                 | FAP ROUTE 407 (IL RTE 336) CULVERT CROSS SECTIONS |                  | CONTRACT NO. 68A42                 |
| PLOT SCALE = 40.00' / IN.                                     |                   | CHECKED - AWM   | REVISED - | SCALE: 1/4" = 20' H, 1/8" = 10' V              |                 | SHEET NO. 2 OF 22 SHEETS                          |                  | STA. 579+50,000 TO STA. 608+50,000 |
| PLOT DATE = 12/12/2012  |                   | DATE - 12-12-12 | REVISED - | ILLINOIS FED. AID PROJECT                      |                 |   |                  |                                    |