

280 300 320 340 360 380 400 420 440 460 480 500 520 540 560 580 600 620 640 660 680 700 720 740 760 780 800 820 840 860 880

BY	DATE
FINAL SURVEY	SURVEYED
NOTE BOOK	PLOTTED
NO.	TEMPLATE
	AREAS CHECKED

BY	DATE
ORIGINAL SURVEY	SURVEYED
NOTE BOOK	PLOTTED
NO.	TEMPLATE
	AREAS CHECKED

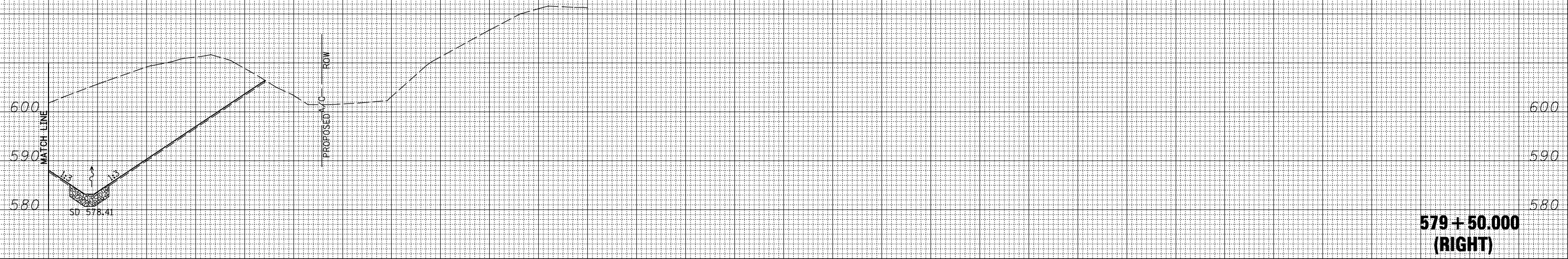

280 300 320 340 360 380 400 420 440 460 480 500 520 540 560 580 600 620 640 660 680 700 720 740 760 780 800 820 840 860 880

FILE NAME = V:\Transportation\2891\Grading Plans\2891xsheets-20\SCALE.dgn

USER NAME = jdeen
 PLOT SCALE = 40.00' / IN.
 PLOT DATE = 12/12/2012

DESIGNED - JRB
 DRAWN - TJD
 CHECKED - AWM
 DATE - 12-12-12

REVISED -
 REVISED -
 REVISED -
 REVISED -

**STATE OF ILLINOIS
 DEPARTMENT OF TRANSPORTATION**

**FAP ROUTE 407 (IL RTE 336)
 CULVERT CROSS SECTIONS - MATCHLINE RT**

SCALE: 1/4" = 20' H, 1/8" = 10' V | SHEET NO. 3 OF 22 SHEETS | STA. 579+50.000 TO STA. 579+50.000

F.A.P. RTE.	SECTION	COUNTY	TOTAL SHEETS	SHEET NO.
407	(55-3)A	MCDONOUGH	671	509
			CONTRACT NO. 68A42	

ILLINOIS FED. AID PROJECT