

DATE	
BY	
FINISHED SURVEY	
PLOTTED	
TEMPLATE	
NOTE BOOK	
AREAS CHECKED	
NO.	

DATE	
BY	
ORIGINAL SURVEY	
PLOTTED	
TEMPLATE	
NOTE BOOK	
AREAS CHECKED	
NO.	

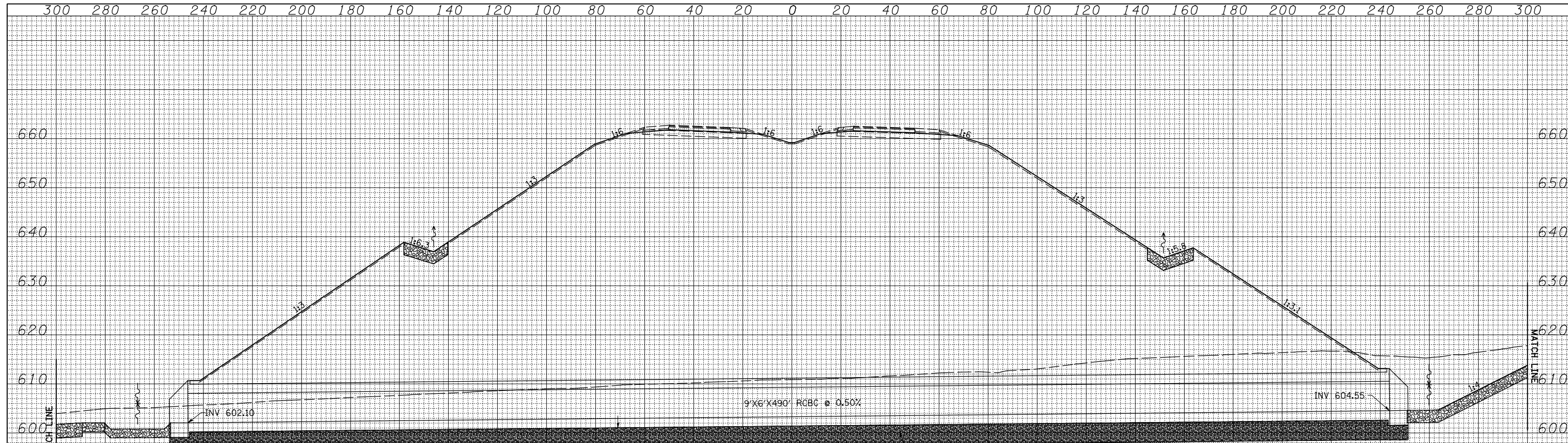

**659 + 10.00  
ON SKEW**

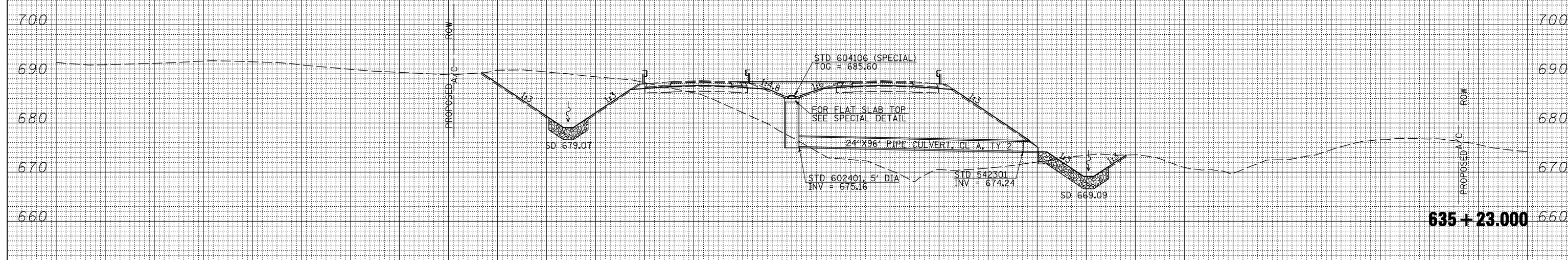

**635 + 23.000**

FILE NAME =	USER NAME = jdeen	DESIGNED - JRB	REVISED -	<b>STATE OF ILLINOIS DEPARTMENT OF TRANSPORTATION</b>	<b>FAP ROUTE 407 (IL RTE 336) CULVERT CROSS SECTIONS</b>	F.A.P. RTE.	SECTION	COUNTY	TOTAL SHEETS	SHEET NO.	
V:\Transportation\2891\Grading Plans\2891xsheets-20SCALE.dgn	PLOT SCALE = 40.00' / IN.	DRAWN - TJD	REVISED -			407	(55-3)A	MCDONOUGH	671	511	
	PLOT DATE = 12/12/2012	CHECKED - AWM	REVISED -			CONTRACT NO. 68A42					
		DATE - 12-12-12	REVISED -			ILLINOIS FED. AID PROJECT					

SCALE:  $\frac{1}{4}'' = 20'$  H  
 $\frac{1}{4}'' = 10'$  V  
SHEET NO. 5 OF 22 SHEETS  
STA. 635+23.000 TO STA. 659+10.000