

300 280 260 240 220 200 180 160 140 120 100 80 60 40 20 0 20 40 60 80 100 120 140 160 180 200 220 240 260 280 300

BY	DATE
FINAL SURVEY	SURVEYED
NOTE BOOK	PLOTTED
NO.	TEMPLATE
	AREAS CHECKED
	AREAS CHECKED

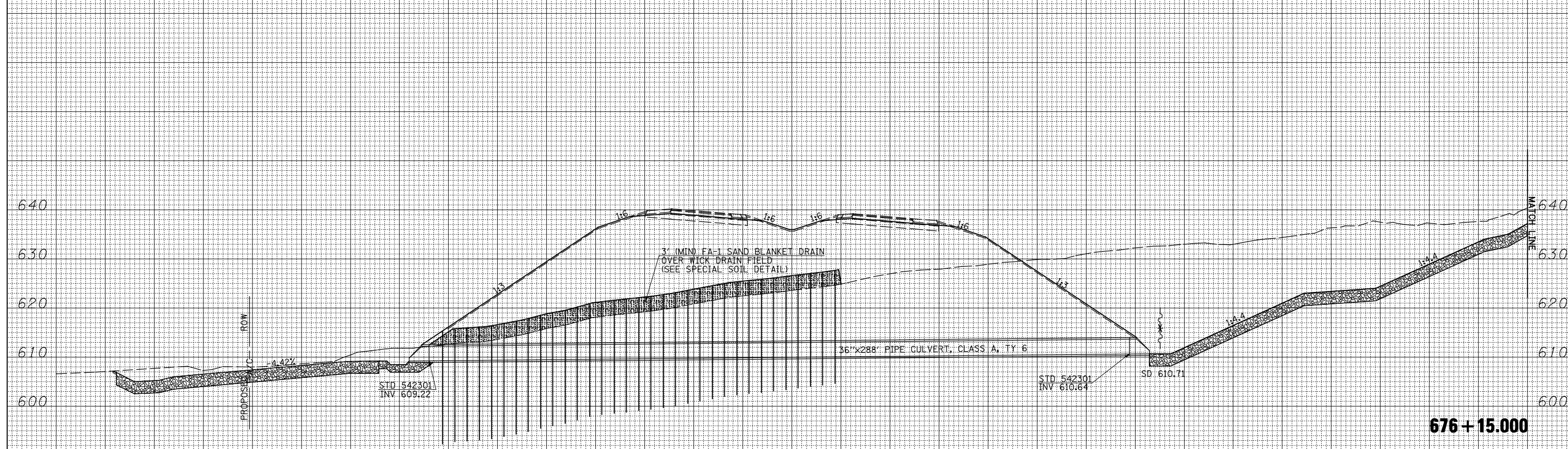

BY	DATE
ORIGINAL SURVEY	SURVEYED
NOTE BOOK	PLOTTED
NO.	TEMPLATE
	AREAS CHECKED
	AREAS CHECKED

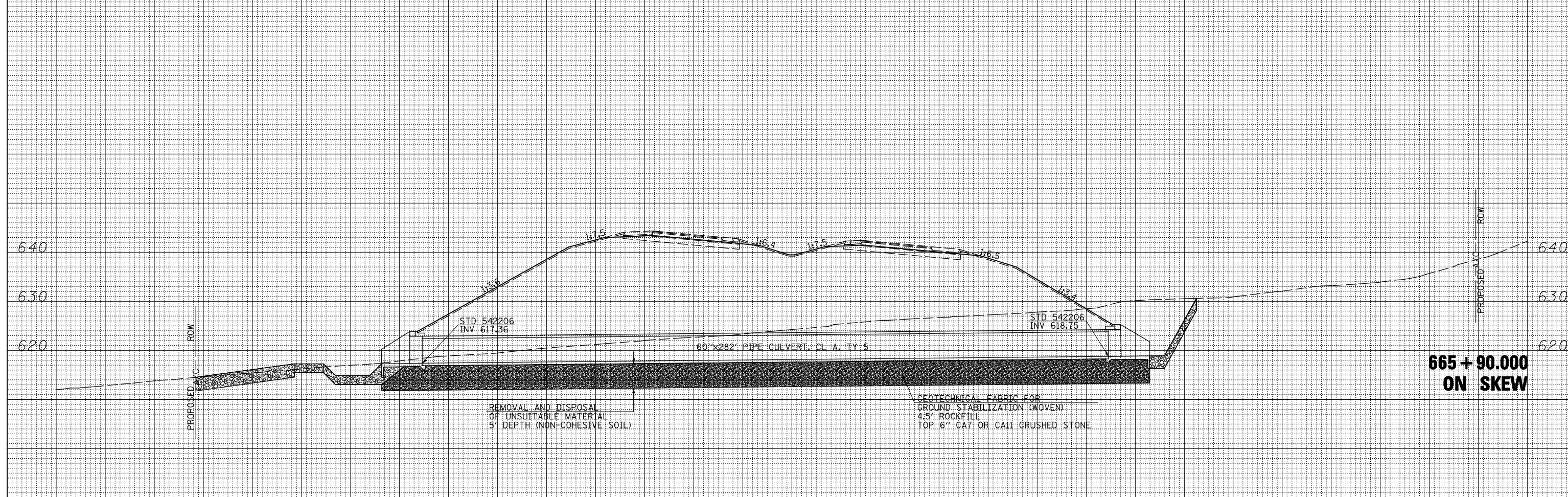

300 280 260 240 220 200 180 160 140 120 100 80 60 40 20 0 20 40 60 80 100 120 140 160 180 200 220 240 260 280 300

FILE NAME =  
 USER NAME = jdeen  
 V:\Transportation\2891\Grading Plans\2891xsheets\20SCALE.dgn  
 PLOT SCALE = 40.00' / IN.  
 PLOT DATE = 12/12/2012

DESIGNED - JRB	REVISED -
DRAWN - TJD	REVISED -
CHECKED - AWM	REVISED -
DATE - 12-12-12	REVISED -

**STATE OF ILLINOIS  
 DEPARTMENT OF TRANSPORTATION**

**FAP ROUTE 407 (IL RTE 336)  
 CULVERT CROSS SECTIONS**

SCALE: 1/4"=20' H  
 1/8"=10' V  
 SHEET NO. 8 OF 22 SHEETS  
 STA. 665+90.000 TO STA. 676+15.000

F.A.P. RTE.	SECTION	COUNTY	TOTAL SHEETS	SHEET NO.
407	(55-3)A	MCDONOUGH	671	514
			CONTRACT NO. 68A42	
ILLINOIS FED. AID PROJECT				