

DATE	
BY	
FINAL SURVEY	SURVEYED
NOTE BOOK	PLOTTED
NO.	TEMPLATE
	AREAS CHECKED

DATE	
BY	
ORIGINAL SURVEY	SURVEYED
NOTE BOOK	PLOTTED
NO.	TEMPLATE
	AREAS CHECKED

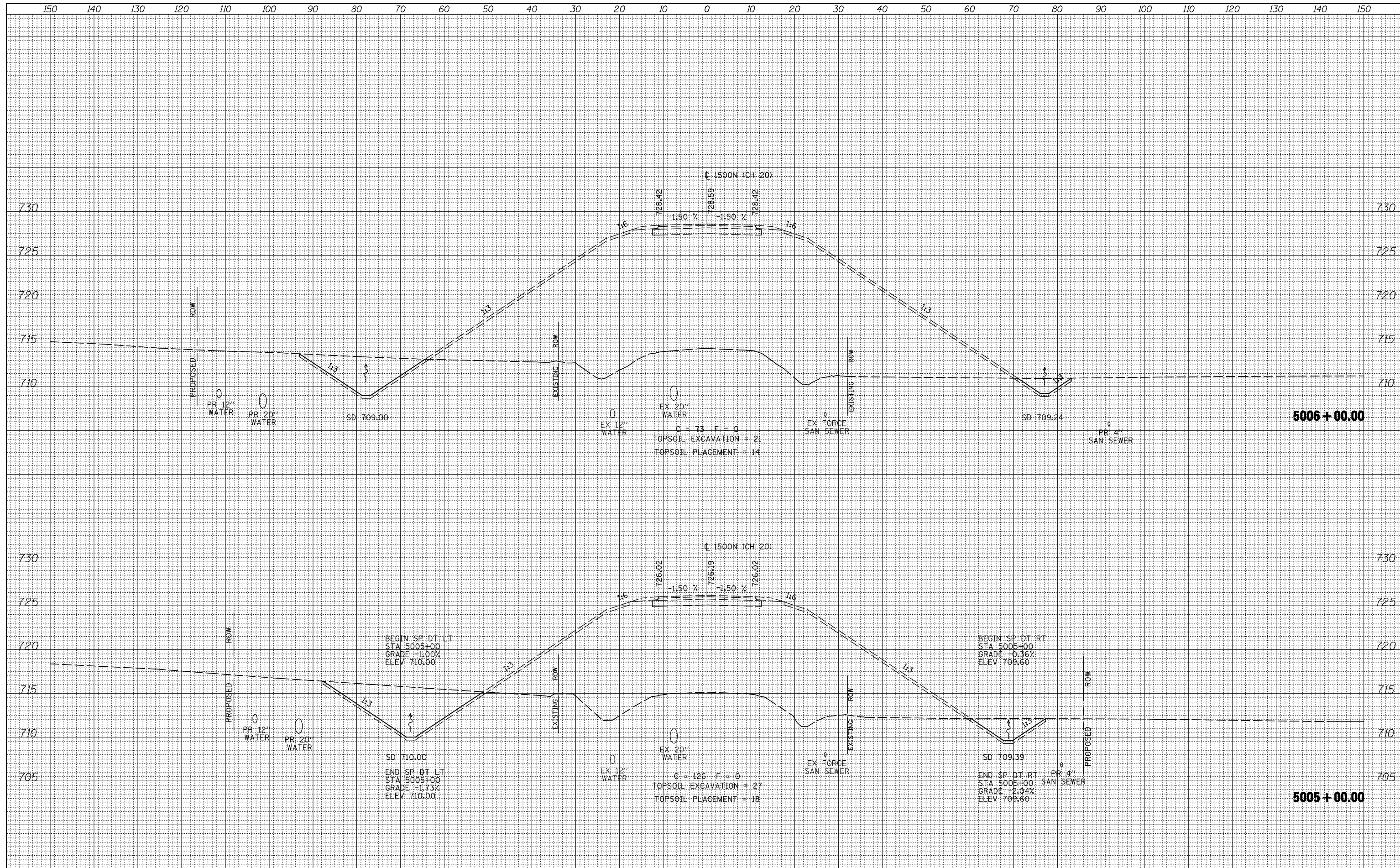

FILE NAME =  
 V:\Transportation\2891\Grading Plans\2891XSHEET\_CH20.dgn

USER NAME = jdeen  
 DESIGNED - JRB  
 DRAWN - TJD  
 CHECKED - AWM  
 DATE - 12-12-12

REVISED -  
 REVISED -  
 REVISED -  
 REVISED -

**STATE OF ILLINOIS  
 DEPARTMENT OF TRANSPORTATION**

**FAP 407 (IL RTE 336)  
 CROSS SECTIONS - 1500 (CH 20)**

SCALE: 1/8" = 1' H  
 1/16" = 1' V

SHEET NO. 4 OF 27 SHEETS  
 STA. 5005+00.00 TO STA. 5006+00.00

F.A.P. RTE.	SECTION	COUNTY	TOTAL SHEETS	SHEET NO.
407	(55-3)A	McDONOUGH	671	561
			CONTRACT NO. 68A42	

ILLINOIS FED. AID PROJECT