

DATE	
BY	
SURVEYED	
PLOTTED	
TEMPLATE	
NOTE BOOK	
AREAS CHECKED	
NO.	

DATE	
BY	
SURVEYED	
PLOTTED	
TEMPLATE	
NOTE BOOK	
AREAS CHECKED	
NO.	

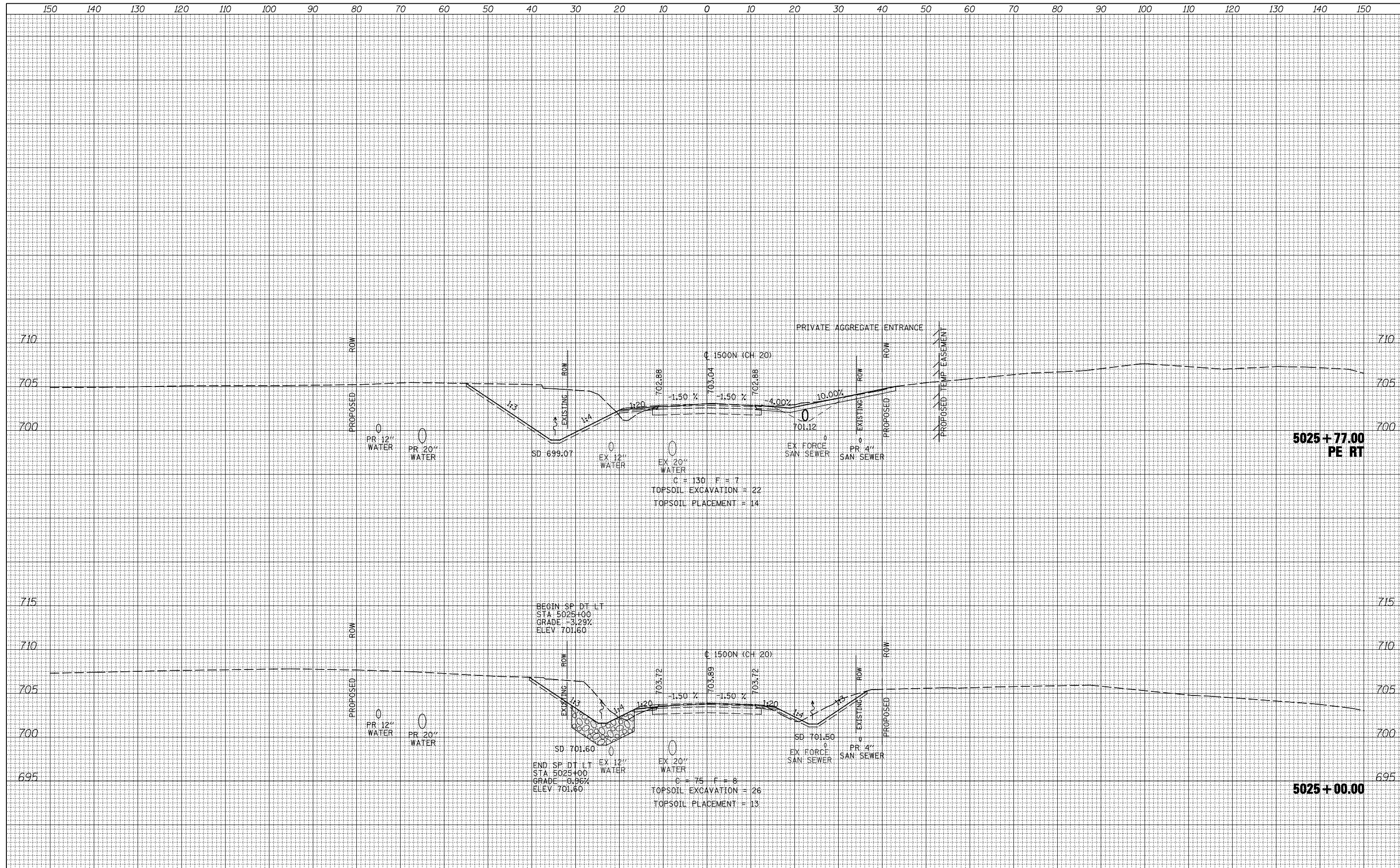

FILE NAME =	USER NAME = jdeen	DESIGNED - JRB	REVISED -
V:\Transportation\2891\Grading Plans\2891XSHEET_CH20.dgn		DRAWN - TJD	REVISED -
		CHECKED - AWM	REVISED -
		DATE - 12-12-12	REVISED -

STATE OF ILLINOIS
DEPARTMENT OF TRANSPORTATION

FAP 407 (IL RTE 336)		F.A.P. RTE.	SECTION	COUNTY	TOTAL SHEETS	SHEET NO.
CROSS SECTIONS - 1500N (CH 20)		407	(55-3)A	McDONOUGH	671	575
		CONTRACT NO. 68A42		ILLINOIS FED. AID PROJECT		

SCALE: 1/2" = 10' H
1/8" = 5' V

SHEET NO. 18 OF 27 SHEETS

STA. 5025+00.00 TO STA. 5025+77.00