

DATE	
BY	
FINISHED SURVEY	
PLOTTED TEMPLATE	
NOTE BOOK	
AREAS CHECKED	
NO.	

DATE	
BY	
ORIGINAL SURVEY	
PLOTTED TEMPLATE	
NOTE BOOK	
AREAS CHECKED	
NO.	

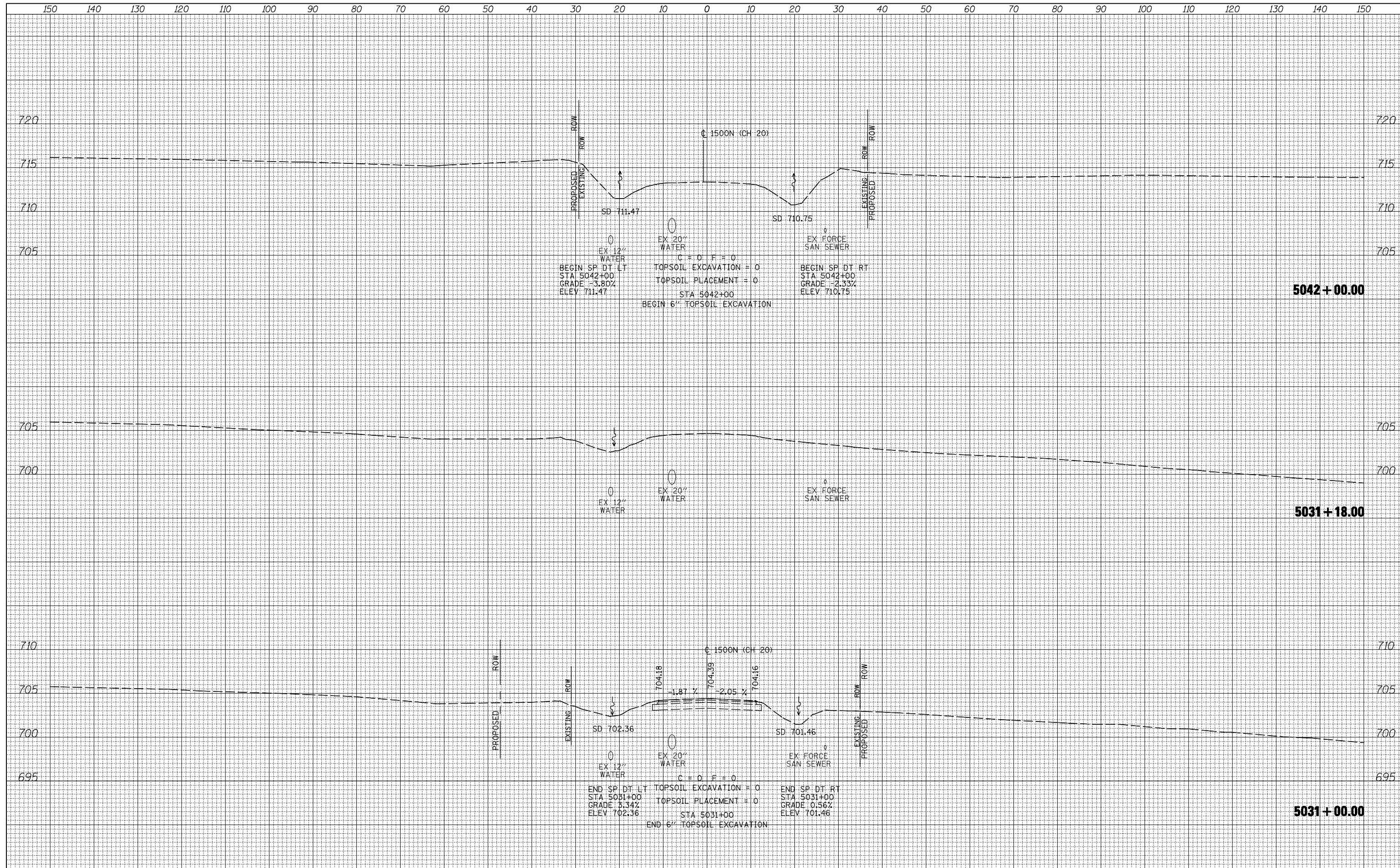

FILE NAME =	USER NAME = jdeen	DESIGNED - JRB	REVISED -	STATE OF ILLINOIS DEPARTMENT OF TRANSPORTATION	FAP 407 (IL RTE 336) CROSS SECTIONS - 1500N (CH 20)	F.A.P. RTE. 407	SECTION (55-3)A	COUNTY McDONOUGH	TOTAL SHEETS 671	SHEET NO. 579
V:\Transportation\2891\Grading Plans\2891XSHEET_CH20.dgn	DRAWN - TJD	REVISOR -				CONTRACT NO. 68A42				
PLOT SCALE = 20.00' / IN.	CHECKED - AWM	REVISOR -								
PLOT DATE = 12/12/2012	DATE - 12-12-12	REVISOR -								

SCALE: 1/8" = 1' H, 1/8" = 1' V
 SHEET NO. 22 OF 27 SHEETS
 STA. 5031+00.00 TO STA. 5042+00.00

ILLINOIS FED. AID PROJECT