

DATE	
BY	
FINISHED SURVEY	
PLOTTED	
TEMPLATE	
NOTE BOOK	
AREAS CHECKED	

DATE	
BY	
ORIGINAL SURVEY	
PLOTTED	
TEMPLATE	
NOTE BOOK	
AREAS CHECKED	

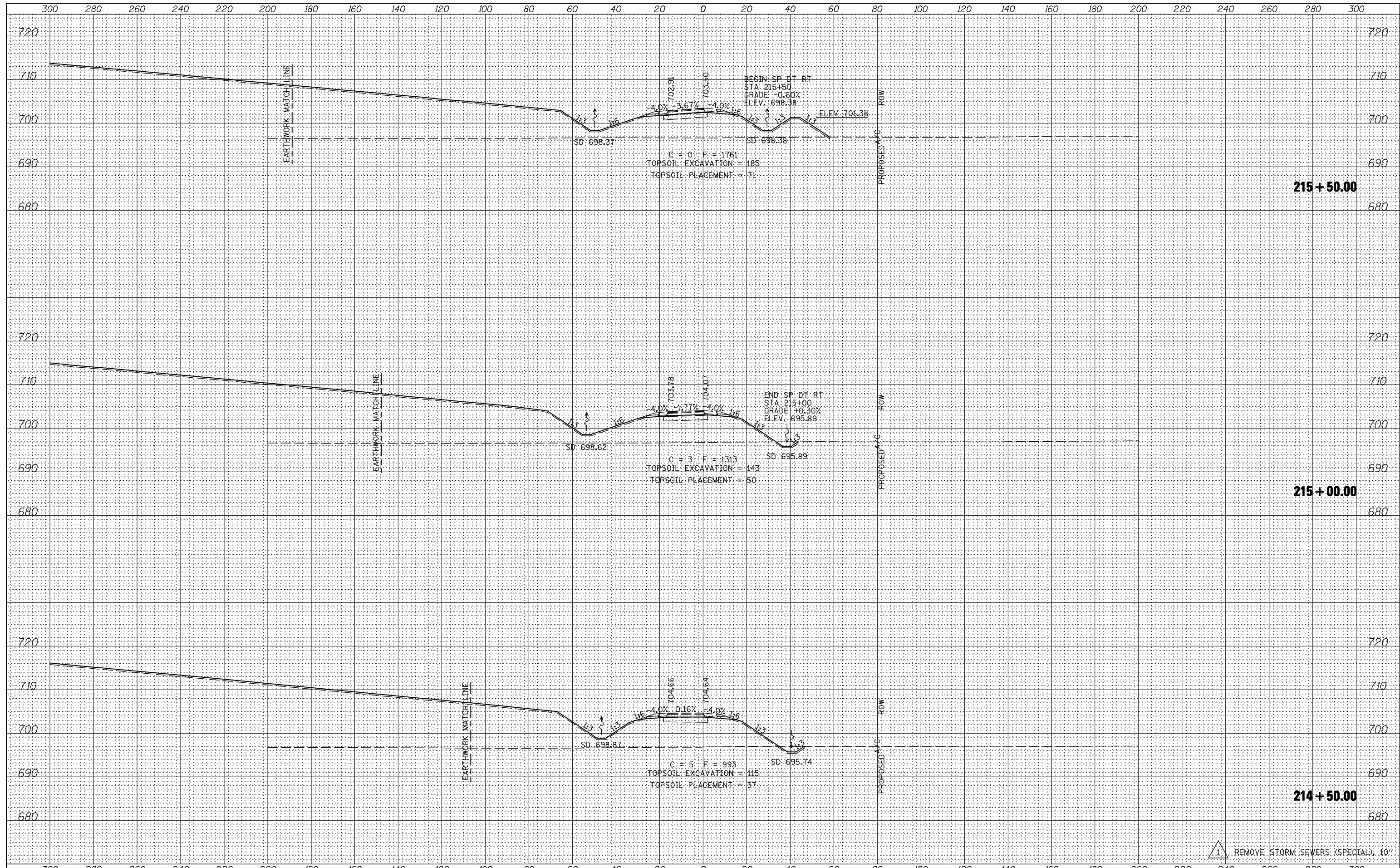

FILE NAME =	USER NAME = jdeen	DESIGNED - JRB	REVISED - 02/07/2013	STATE OF ILLINOIS DEPARTMENT OF TRANSPORTATION	FAP ROUTE 407 (IL 336) CROSS SECTIONS - RAMP D	F.A.P. RTE. 407	SECTION (55-3)A	COUNTY MCDONOUGH	TOTAL SHEETS 671	SHEET NO. 659	
vi:\transportation\2891\grading plans\2891XSHEET_RAMPS.dgn	PLOT SCALE = 40.0000' / IN.	CHECKED - AWM	REVISED -			SCALE: 1/2"=20' H 1/4"=10' V	SHEET 6 OF 9 SHEETS	STA. 214+50.00 TO STA. 215+50.00	CONTRACT NO. 68A42		
XS.SHEET	PLOT DATE = 2/7/2013	DATE - 12-12-12	REVISED -			ILLINOIS FED. AID PROJECT					
<div style="text-align: right;"> REMOVE STORM SEWERS (SPECIAL) 10" </div>											