

DATE	
BY	
FINAL SURVEY	SURVEYED
NOTE BOOK	PLOTTED
NO.	TEMPLATE
	AREAS CHECKED

DATE	
BY	
ORIGINAL SURVEY	SURVEYED
NOTE BOOK	PLOTTED
NO.	TEMPLATE
	AREAS CHECKED

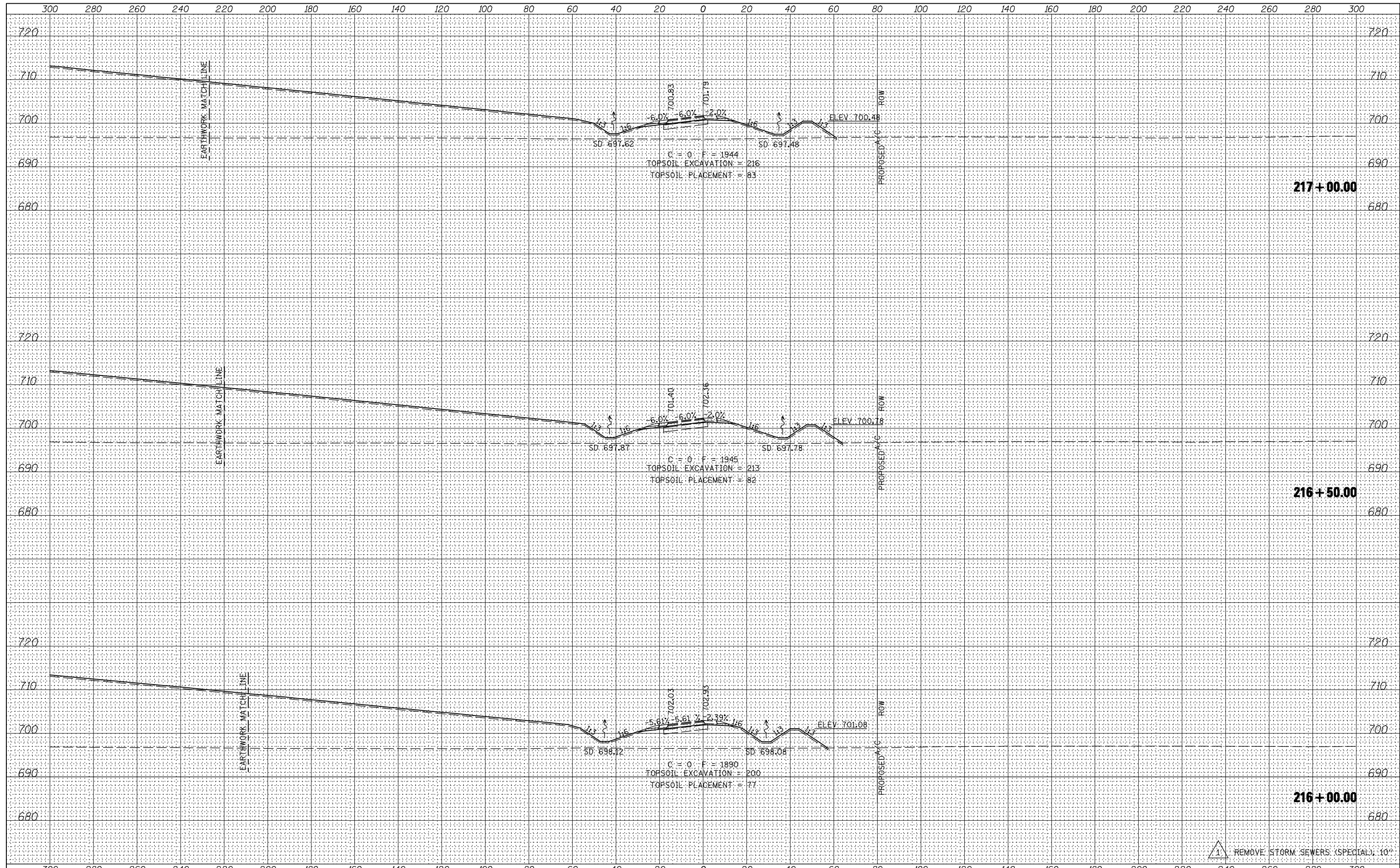

REMOVE STORM SEWERS (SPECIAL) 10"

FILE NAME =	USER NAME = jdeen	DESIGNED - JRB	REVISED - 02/07/2013
vi:\transportation\2891\grading plans\2891XSHEET_RAMPS.dgn		DRAWN - TJD	REVISED -
		CHECKED - AWM	REVISED -
XS_SHEET	PLOT DATE = 2/7/2013	DATE - 12-12-12	REVISED -

STATE OF ILLINOIS
DEPARTMENT OF TRANSPORTATION

FAP ROUTE 407 (IL 336)
CROSS SECTIONS - RAMP D

SCALE: 1/4"=20' H, 1/8"=10' V SHEET 7 OF 9 SHEETS STA. 216+00.00 TO STA. 217+00.00

F.A.P. RTE.	SECTION	COUNTY	TOTAL SHEETS	SHEET NO.
407	(55-3)A	MCDONOUGH	671	660
			CONTRACT NO. 68A42	

ILLINOIS FED. AID PROJECT