

DATE	
BY	
FINAL SURVEY NO.	
SURVEYED	
PLOTTED	
TEMPLATE	
NOTE BOOK	
AREAS CHECKED	

DATE	
BY	
ORIGINAL SURVEY NO.	
SURVEYED	
PLOTTED	
TEMPLATE	
NOTE BOOK	
AREAS CHECKED	

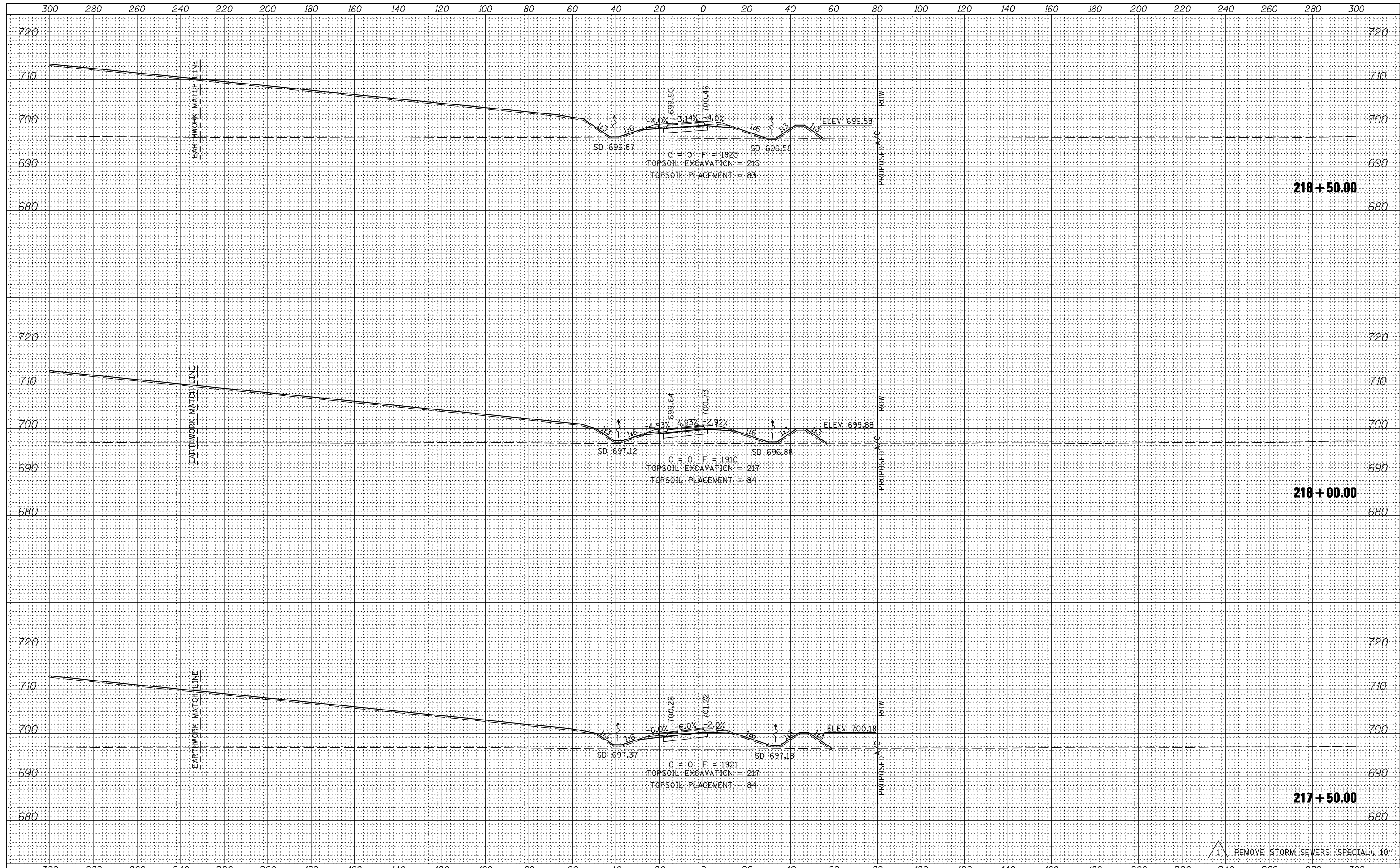

FILE NAME =	USER NAME = jdeen	DESIGNED - JRB	REVISED - 02/07/2013	STATE OF ILLINOIS DEPARTMENT OF TRANSPORTATION	FAP ROUTE 407 (IL 336) CROSS SECTIONS - RAMP D	F.A.P. RTE. 407	SECTION (55-3)A	COUNTY MCDONOUGH	TOTAL SHEETS 671	SHEET NO. 661	
vi:\transportation\2891\grading plans\2891XSHEET_RAMPS.dgn	DRAWN - TJD	REVISER -	REVISER -			SCALE: 1/4"=10' H 1/4"=10' V	SHEET 8	OF 9 SHEETS	STA. 217+50.00	TO STA. 218+50.00	CONTRACT NO. 68A42
PLOT SCALE = 40.0000' / IN.	CHECKED - AWM	REVISER -	REVISER -			ILLINOIS FED. AID PROJECT					
XS_SHEET	DATE - 12-12-12	REVISER -	REVISER -								